

注：  
NOTE

1. 材料

MATERIAL

ピン : □0.635×14.2 黄銅、

ニッケル下地金めっき

PIN : □0.635×14.2 BRASS

GOLD OVER NICKEL PLATING

ウエハー : ポリアミド、UL94V-0

WAFER: POLYAMIDE,UL94V-0

2. 6極以上に適応

TO BE APPLIED FOR 6 CKT. AND MORE THAN 6 CKT.

3. 5極以下はロック部スリットなし

NO SLIT IS PROVIDED FOR 5 CKT. AND LESS THAN 5 CKT.

4. ELV 及び RoHS 適合品

ELV AND RoHS COMPLIANT

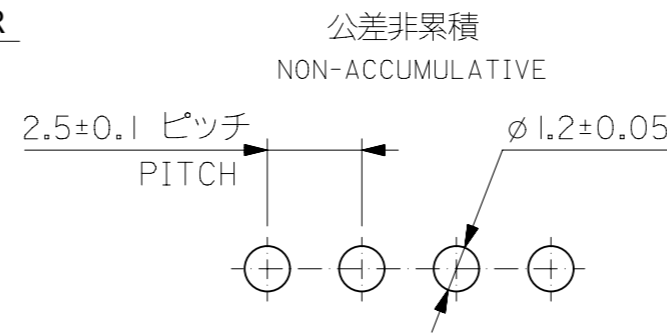
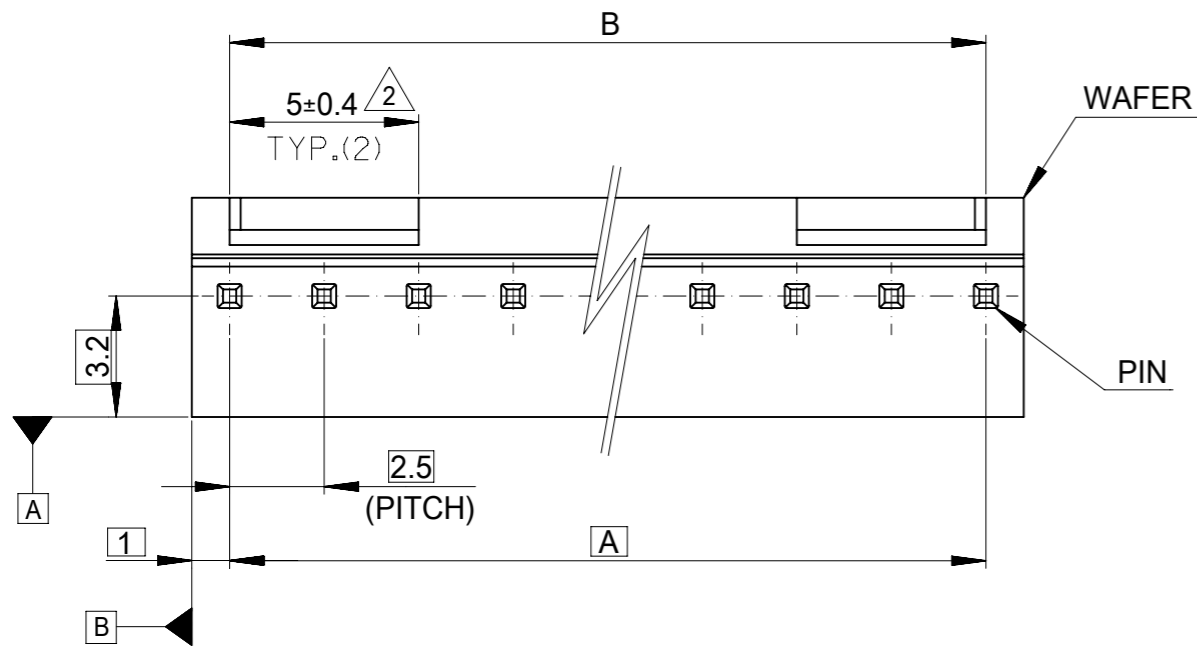

基板取付穴推奨寸法  
RECOMMENDED P.C.BOARD HOLE DIM.

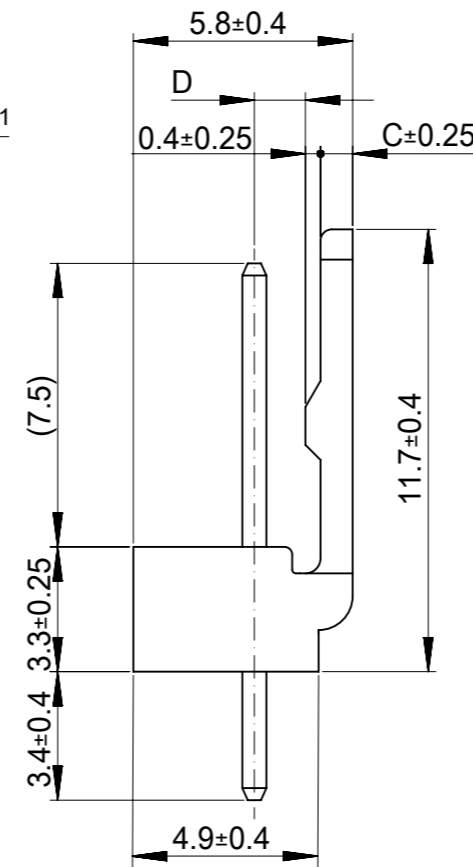
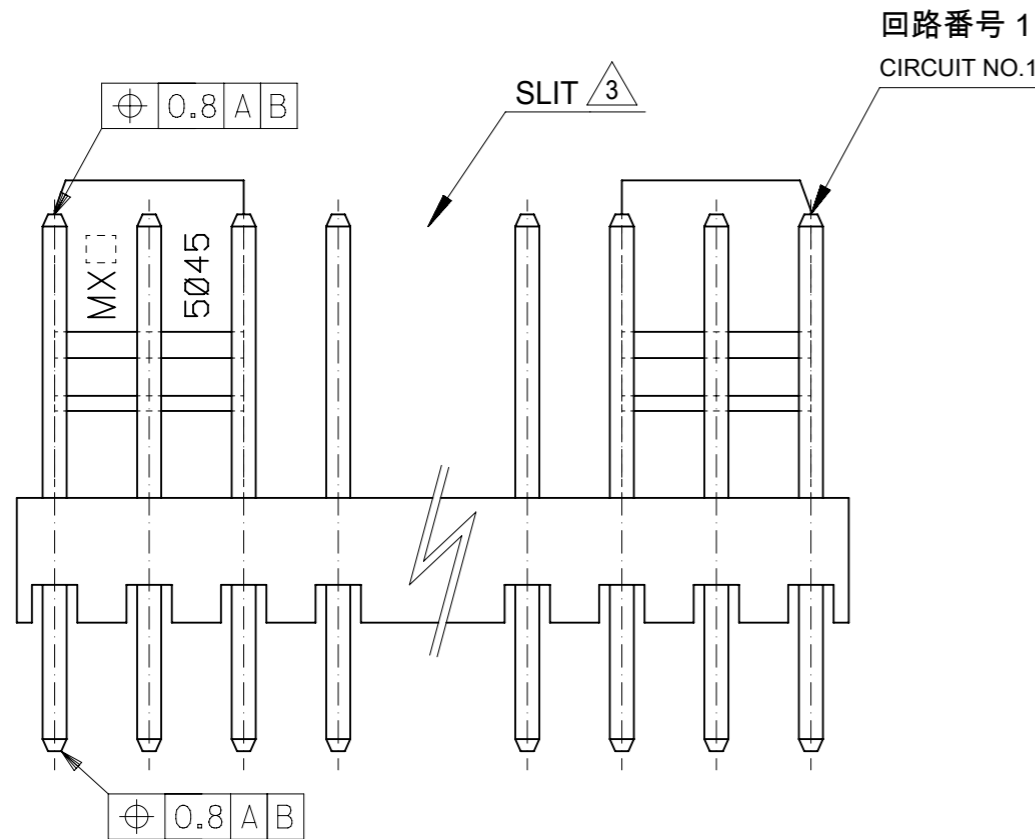

1.35	0.85	22.5 <sup>+0.2</sup> <sub>-0.4</sub>	22.5	22 11 1101	10
↑	↑	20 <sup>+0.15</sup> <sub>-0.35</sub>	20	↑ 1091	9
		17.5 <sup>+0.15</sup> <sub>-0.35</sub>	17.5	1081	8
		15 <sup>+0.1</sup> <sub>-0.3</sub>	15	1071	7
		12.5 <sup>+0.1</sup> <sub>-0.3</sub>	12.5	1061	6
↓	↓	10 <sup>+0.15</sup> <sub>-0.3</sub>	10	1051	5
1.35	0.85	7.5 <sup>+0.15</sup> <sub>-0.3</sub>	7.5	1041	4
1.2	1	5 <sup>+0.15</sup> <sub>-0.3</sub>	5	↓ 1031	3
1.2	1	2.5 <sup>+0.15</sup> <sub>-0.3</sub>	2.5	22 11 1021	2
D	C	B	A	ORDER No.	極数 CKT.

MODEL No. : 5045-\*\*AG

THIS DRAWING CONTAINS INFORMATION THAT IS PROPRIETARY TO MOLEX ELECTRONIC TECHNOLOGIES, LLC AND SHOULD NOT BE USED WITHOUT WRITTEN PERMISSION

DIMENSION UNITS mm	SCALE 5:1	CURRENT REV DESC: OBSOLETE PART NUMBER AS PER PCN#509451	<b>molex</b>		
GENERAL TOLERANCES (UNLESS SPECIFIED)	ANGULAR TOL ± 3.0°	EC NO: 686785			
4 PLACES ± 0.2	4 PLACES ± 0.2	DRWN: SUGEEB 2021/08/30	PRODUCT CUSTOMER DRAWING		
3 PLACES ± 0.2	3 PLACES ± 0.2	CHK'D: GGA 2022/02/28	DOCUMENT NUMBER		
2 PLACES ± 0.2	2 PLACES ± 0.2	APPR: GGA 2022/02/28	SD-5045-001		
1 PLACE ± 0.2	1 PLACE ± 0.2	INITIAL REVISION:	DOC TYPE	DOC PART	REVISION
0 PLACES ± 0.2	0 PLACES ± 0.2	DRWN: RHORI 2013/11/25	PSD	001	G1
		APPR: NUKITA 2013/11/28	MATERIAL NUMBER	CUSTOMER	SHEET NUMBER
DRAFT WHERE APPLICABLE MUST REMAIN WITHIN DIMENSIONS	THIRD ANGLE PROJECTION	DRAWING A3-SIZE	SERIES 5045	SEE TABLE GENERAL MARKET	1 OF 1