

DESCRIPTION: HIGH DENSITY VERTICAL LOW PROFILE/MACHINED

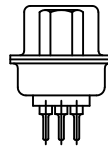
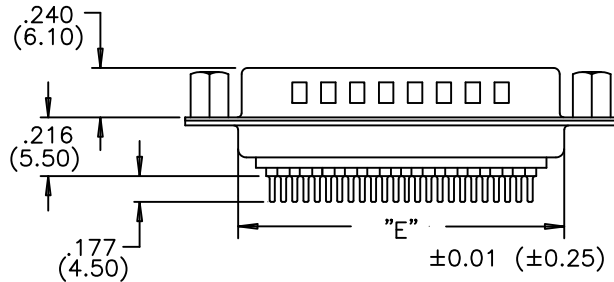
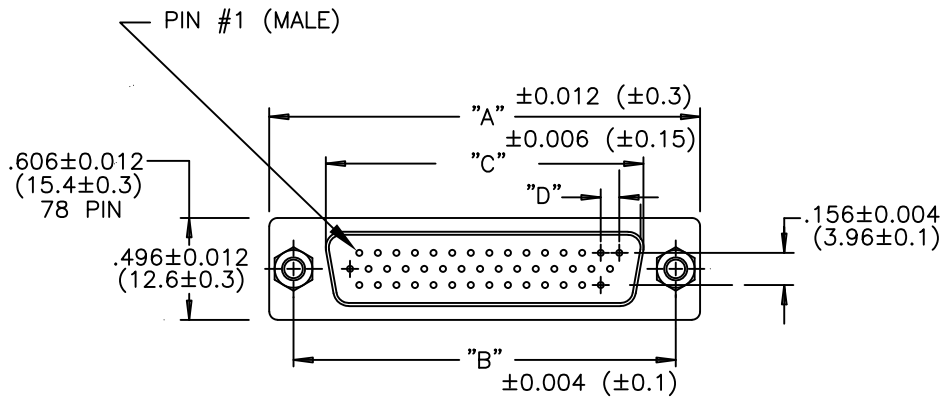

MATERIALS:

INSULATOR: PBT, UL94V-0, 230° PROCESS TEMP.  
CHEMICAL RESISTANCE, COLOR BLACK

SHELL: STEEL: NICKEL PLATED

CONTACT: COPPER ALLOY  
FULL GOLD FLASH

ELECTRICAL:

CURRENT RATING: 5 AMPERES  
DIELECTRIC WITHSTANDING VOLTAGE:  
500VAC rms FOR 1 MINUTE  
INSULATION RESISTANCE: 1000 MEGOHMS MIN.  
CONTACT RESISTANCE: 15 MILLIOHMS MAX.  
WORKING TEMPERATURE: -50° TO +100° C

197-YYY-Y13LYY1

SERIES \_\_\_\_\_  
NUMBER OF CONTACTS \_\_\_\_\_  
GENDER \_\_\_\_\_  
1 = MALE  
2 = FEMALE (NO GROUND INDENTS)  
PC MOUNT \_\_\_\_\_  
3 = NICKEL SHELL \_\_\_\_\_

HARDWARE OPTIONS: \_\_\_\_\_  
00 = .120 MOUNTING HOLE  
55 = 4-40 INSERTS  
03 = 4-40 HEX STANDOFFS

PLATING: \_\_\_\_\_  
1 = GOLD FLASH

NUMBER OF CONTACTS	"A" Inch (mm)	"B" Inch (mm)	"C" Inch (mm)	"D" Inch (mm)	"E" Inch (mm)
15	1.213 (30.80)	.984 (24.99)	.666 (16.92)	.090 (2.29)	.756 (19.20)
26	1.543 (39.20)	1.312 (33.32)	.970 (24.65)	.090 (2.29)	1.091 (27.70)
44	2.087 (53.00)	1.852 (47.04)	1.512 (38.40)	.090 (2.29)	1.618 (41.10)
62	2.732 (69.40)	2.500 (63.50)	2.157 (54.80)	.095 (2.41)	2.256 (57.30)
78	2.638 (67.00)	2.406 (61.10)	2.079 (52.81)	.095 (2.41)	2.169 (55.10)



THESE DRAWINGS AND SPECIFICATIONS ARE THE PROPERTY OF NorComp AND SHALL NOT BE REPRODUCED, COPIED OR USED AS THE BASIS FOR THE MANUFACTURE OF SALE OF APPARATUS WITHOUT WRITTEN PERMISSION.

DRAWN: PAM JENKINS		DATE: 9-15-05	
CHECKED:		DATE:	
SCALE:	SHEET 1	OF 1	REV 3
DWG NO. 197-YYY-113LYY1			

**NorComp**

RoHS COMPLIANT