

| MATERIAL NUMBER | ENGINEERING NUMBER | STUD SIZE | "S" | PACKAGING |
|-----------------|--------------------|-----------|--------------|-----------------|
| 191930206 | E-357-08 | 8 | .173/(4.39) | LOOSE PIECE |
| 191930209 | E-357-10 | 10 | .198/(5.02) | |
| 191930212 | E-357-14 | 1/4 | .265/(6.73) | |
| 191930219 | E-357-56 | 5/16 | .328/(8.33) | |
| 191930216 | E-357-38 | 3/8 | .390/(9.90) | |
| 191930223 | E-357-76 | 7/16 | .453/(11.50) | TAPE MOUNTED |
| 191930208 | E-357-08T | 8 | .173/(4.39) | |
| 191930211 | E-357-10T | 10 | .198/(5.02) | |
| 191930215 | E-357-14T | 1/4 | .265/(6.73) | |
| 191930222 | E-357-56T | 5/16 | .328/(8.33) | |
| 191930218 | E-357-38T | 3/8 | .390/(9.90) | |
| 191930224 | E-357-76T | 7/16 | .453/(11.50) | |

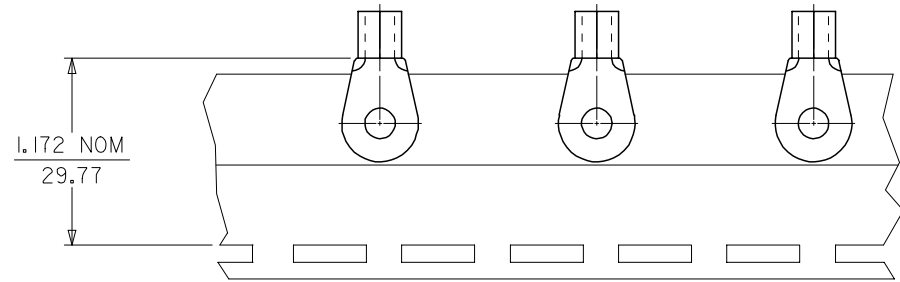

PARTS ON TAPE
DOUBLE SPACED AS SHOWN

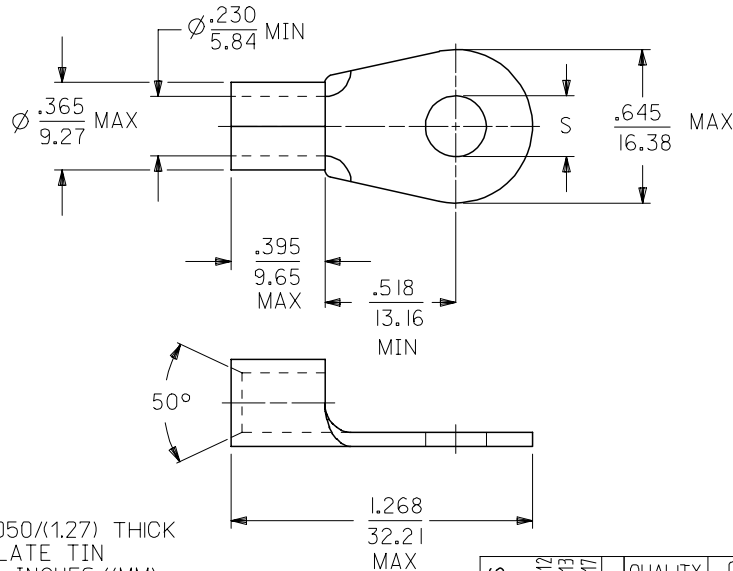

- NOTE(S):
- 1. MATERIAL: COPPER .050/(1.27) THICK
 - 2. PLATING: ELECTROPLATE TIN
 - 3. ALL DIMENSIONS IN INCHES/(MM).
 - 4. WIRE SIZE: 6 AWG
16 MM²
 - 5. PART IS ROHS COMPLIANT.

SALES DRAWING

| | | | | | | | | |
|---|-------------------------------|---------------------------------------|------------|-----------------|--------------|--------------|---|--|
| REVISED MATL THKNS EC NO: ETC2007-0011 DRW: NEHLE 2006/07/12 CHKD: JMACNEIL 2006/07/13 APPR: RDOERSS 2006/07/17 | QUALITY SYMBOLS ▽=0 ▽=0 | GENERAL TOLERANCES (UNLESS SPECIFIED) | | DIMENSION STYLE | SCALE | DESIGN UNITS | THIRD ANGLE PROJECTION | |
| | | | | IN/MM | --- | INCH | | |
| | | 4 PLACES | ± --- | ± --- | DRAWN BY | DATE | TITLE | |
| | | 3 PLACES | ± --- | ± .005 | EDB | 2000/11/01 | RING TONGUE TERMINAL VERSAKRIMP 6 AWG | |
| 2 PLACES | ± 0.13 | ± .01 | CHECKED BY | DATE | MATERIAL NO. | | SHEET NO. | |
| 1 PLACE | ± 0.25 | ± --- | HEB | 2000/11/01 | RWD | | 1 OF 1 | |
| ANGULAR ±1/2° | | APPROVED BY | | DATE | DOCUMENT NO. | | | |
| DRAFT WHERE APPLICABLE MUST REMAIN WITHIN DIMENSIONS | | RWD | | 2000/11/01 | SEE CHART | | SD-19193-015 | |
| THIS DRAWING CONTAINS INFORMATION THAT IS PROPRIETARY TO MOLEX INCORPORATED AND SHOULD NOT BE USED WITHOUT WRITTEN PERMISSION | | | | | | | | |