

MOLEX LOGO

CKT NO.

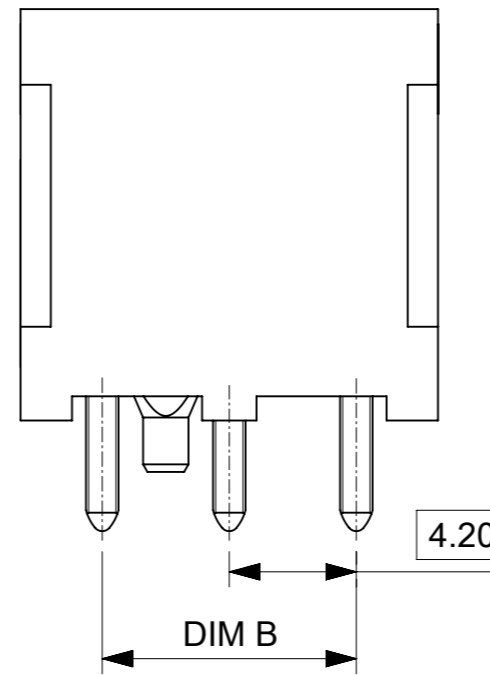
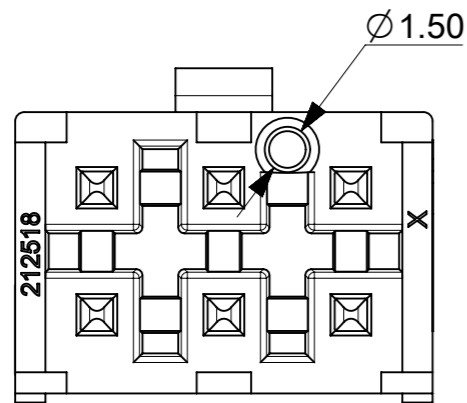
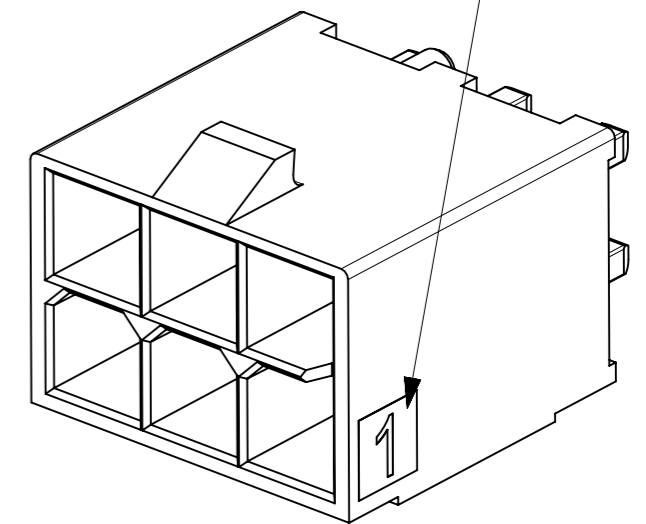

NOTES:

- MATERIALS:
HOUSING - LCP UL94V-0, COLOR: BLACK
TERMINAL - COPPER ALLOY
- TERMINAL PLATING: TIN OVER NICKEL OVERALL.
- PRODUCT SPECIFICATION: 2125150000-PS.
- PACKAGING SPECIFICATION: TRAY PACK PER: 212520001-PK
- PART MATES WITH MINI-FIT MAX RECEPTACLE SERIES 212514.
- DISCOLORIZATION IN THE BANDOLIER CARRIER AREA OF THE PIN IS INHERENT TO THE PLATING PROCESS AND IS DUE TO THE MASKING EFFECT OF THE CARRIER. THIS DISCOLORIZATION IS A NON-FUNCTIONAL AREA OF THE PIN AND WILL NOT AFFECT THE PERFORMANCE OF THE HEADER ASSEMBLY.
- CONNECTORS ARE NOT TO BE MATED OR UNMATED WHILE CIRCUITS ARE LIVE.
- PARTS ARE NOT DESIGNED FOR CURRENT SHARING.
- THIS PART CONFORMS TO CLASS "B" REQUIREMENTS OF COSMETIC SPECIFICATION PS-45499-002.
- TEXT ON PART IS FOR REFERENCE ONLY. TEXT AND TEXT LOCATION MAY VARY DEPENDING ON PART NUMBER AND/OR TOOL.

FUNCTIONAL SYMBOLS	THIS DRAWING CONTAINS INFORMATION THAT IS PROPRIETARY TO MOLEX ELECTRONIC TECHNOLOGIES, LLC AND SHOULD NOT BE USED WITHOUT WRITTEN PERMISSION		CURRENT REV DESC:		molex			
	MM	SCALE						
FA = 0	mm	4:1			MINI-FIT MAX DR HDR VERTICAL VERT. HEADER ASSY 2-12 CKT			
FE = 0	GENERAL TOLERANCES (UNLESS SPECIFIED)							
FE = 0	ANGULAR TOL ± °				PRODUCT CUSTOMER DRAWING			
FE = 0	4 PLACES ±							
DIVISIONAL SYMBOLS	3 PLACES ±		EC NO: 712754		DOCUMENT NUMBER			
	2 PLACES ± 0.25		DRWN: ZIXUAQ 2022/07/01			2125200001-SD		
	1 PLACE ± 0.5		CHK'D: XQZHANG 2022/07/01				DOC TYPE	
	0 PLACES ±		APPR: XQZHANG 2022/07/01					DOC PART
	DRAFT WHERE APPLICABLE MUST REMAIN WITHIN DIMENSIONS		INITIAL REVISION:					
THIRD ANGLE PROJECTION		DRWN: SCHEN76 2020/04/24						
DRAWING		APPR: YXZHENG 2020/05/13		SHEET NUMBER				
A3-SIZE		SERIES						
212520		MATERIAL NUMBER						
SEE TABLE		CUSTOMER						
GENERAL MARKET		1 OF 2						

TIN PLATING				
CKT SIZE	PART NO.	DIM A	DIM B	DIM C
2	212520-1002	5.40	NA	NA
4	212520-1004	9.60	4.2	2.10
6	212520-1006	13.80	8.40	4.20
8	212520-1008	18.00	12.60	6.30
10	212520-1010	22.20	16.80	8.40
12	212520-1012	26.40	21.00	10.50

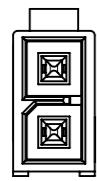

2 CKT

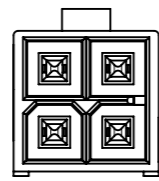

4 CKT

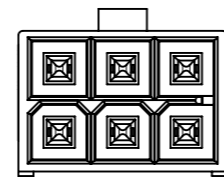

6 CKT

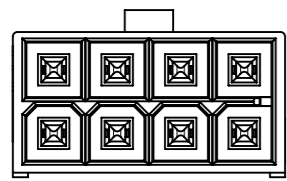

8 CKT

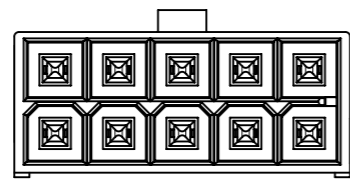

10 CKT

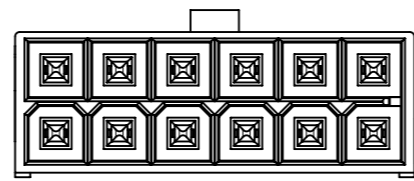

12 CKT

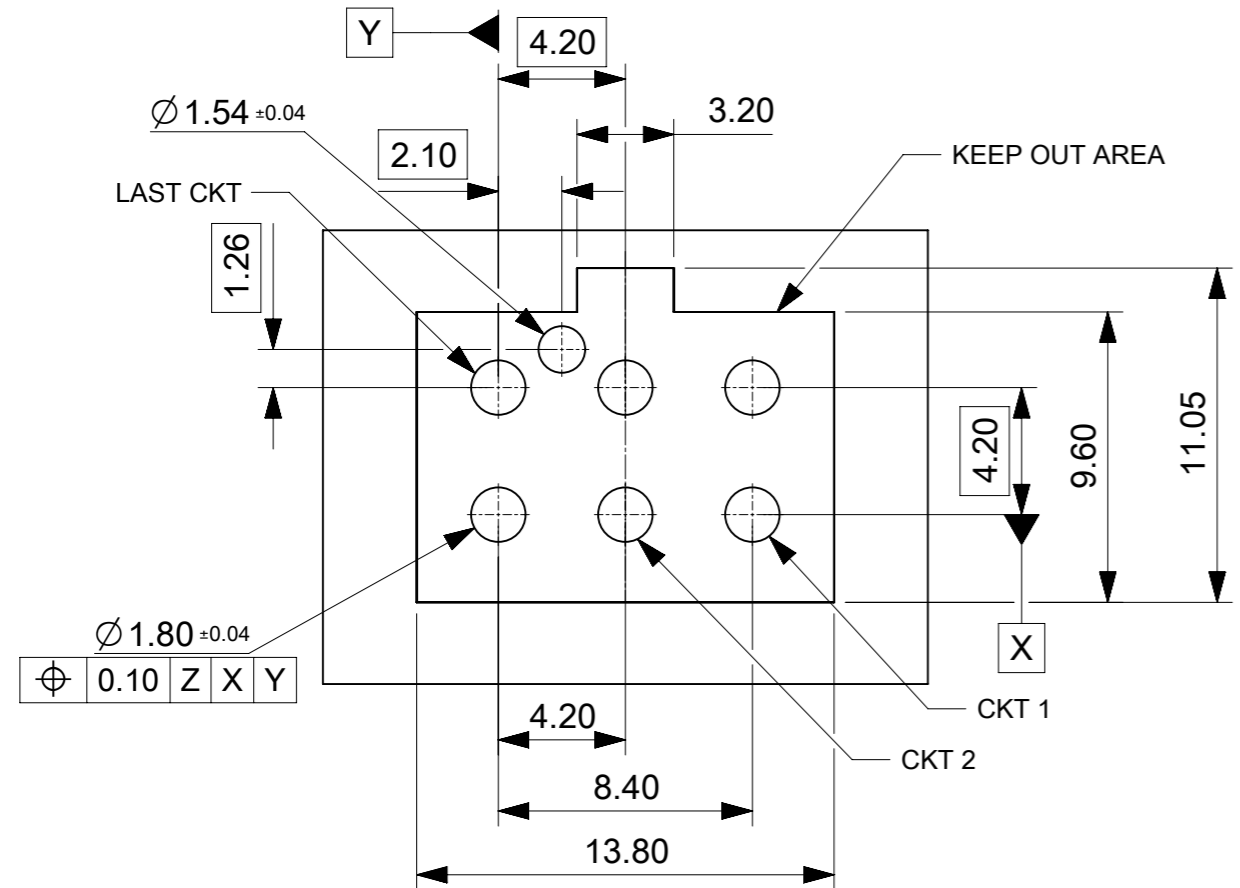

FOR 4 TO 12CKTS

PCB LAYOUT COMPONENT SIDE
RECOMENDED PCB THICKNESS 1.60MM-2.40MM

NOTE: DATUM -Z- IS ON PCB COMPONENT SIDE

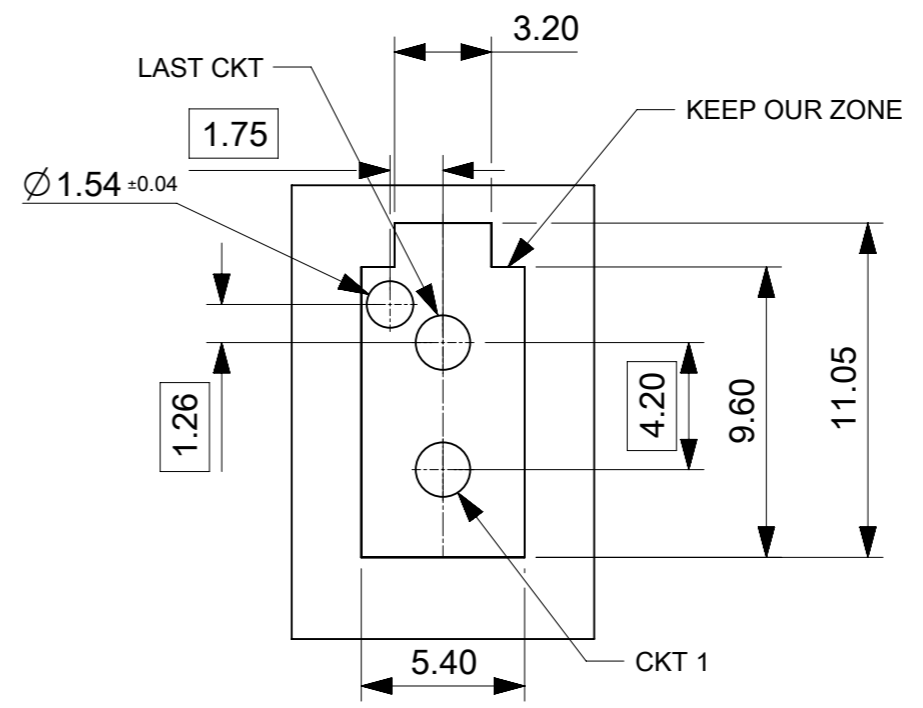

FOR 2CKTS

FUNCTIONAL SYMBOLS	THIS DRAWING CONTAINS INFORMATION THAT IS PROPRIETARY TO MOLEX ELECTRONIC TECHNOLOGIES, LLC AND SHOULD NOT BE USED WITHOUT WRITTEN PERMISSION	CURRENT REV DESC:																														
	<table border="1"> <tr> <th>FUNCTIONAL SYMBOLS</th> <th>DIMENSION UNITS</th> <th>SCALE</th> </tr> <tr> <td>$\nabla_A = 0$</td> <td>mm</td> <td>4:1</td> </tr> <tr> <td colspan="3">GENERAL TOLERANCES (UNLESS SPECIFIED)</td> </tr> <tr> <td>$\nabla_E = 0$</td> <td colspan="2">ANGULAR TOL ± °</td> </tr> <tr> <td>$\nabla_F = 0$</td> <td colspan="2">4 PLACES ±</td> </tr> <tr> <td></td> <td colspan="2">3 PLACES ±</td> </tr> <tr> <td></td> <td colspan="2">2 PLACES ± 0.25</td> </tr> <tr> <td></td> <td colspan="2">1 PLACE ± 0.5</td> </tr> <tr> <td></td> <td colspan="2">0 PLACES ±</td> </tr> </table>	FUNCTIONAL SYMBOLS	DIMENSION UNITS				SCALE	$\nabla_A = 0$	mm	4:1	GENERAL TOLERANCES (UNLESS SPECIFIED)			$\nabla_E = 0$	ANGULAR TOL ± °		$\nabla_F = 0$	4 PLACES ±			3 PLACES ±			2 PLACES ± 0.25			1 PLACE ± 0.5			0 PLACES ±		EC NO: 712754 DRWN: ZIXUAG 2022/07/01 CHK'D: XQZHANG 2022/07/01 APPR: XQZHANG 2022/07/01
FUNCTIONAL SYMBOLS	DIMENSION UNITS	SCALE																														
$\nabla_A = 0$	mm	4:1																														
GENERAL TOLERANCES (UNLESS SPECIFIED)																																
$\nabla_E = 0$	ANGULAR TOL ± °																															
$\nabla_F = 0$	4 PLACES ±																															
	3 PLACES ±																															
	2 PLACES ± 0.25																															
	1 PLACE ± 0.5																															
	0 PLACES ±																															
DIVISIONAL SYMBOLS	DRAFT WHERE APPLICABLE MUST REMAIN WITHIN DIMENSIONS		INITIAL REVISION: DRWN: SCHEN76 2020/04/24 APPR: YXZHENG 2020/05/13		PRODUCT CUSTOMER DRAWING																											
DOCUMENT NUMBER: 2125200001-SD			DOC TYPE: PSD		DOC PART: 000		REVISION: B2																									
MATERIAL NUMBER: SEE TABLE			CUSTOMER: GENERAL MARKET		SHEET NUMBER: 2 OF 2																											