

HSS

Miniature Slide Switches

RoHS Compliant



Part Numbering

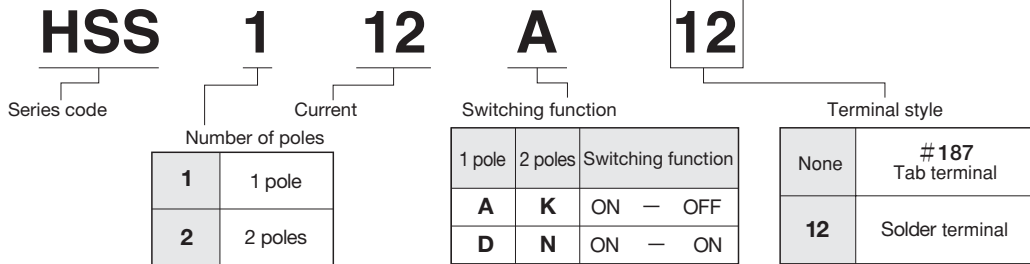

Terminal Styles

Single pole		Double poles	
Tab term.#187	Solder term.	Tab term.#187	Solder term.

Panel Cut Out Dimension

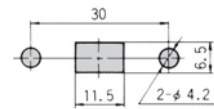
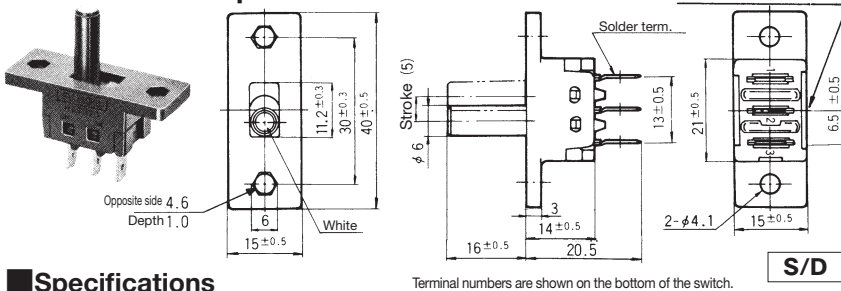

Table of Part Numbers → Page 524.

HSS112

1 pole



Dimension L

Part No.	Terminal style	TAB#250	Solder
HSS112A	■	24	20.5
HSS112D	■	24	20.5

Specifications

	Rating	Initial contact resistance	Dielectric strength	Insulation resistance	Electrical life
HSS112A	AC125V 12A Max. AC250V 6A Max.	100mΩ Max. (DC2~4V 1A)	AC1500V 1 minute	100MΩ Min. (DC500V)	15,000 cycles
HSS112D	AC-DC 6V 1mA Min.				

Part No.	Switching function	
	ON	OFF
HSS112A	ON	OFF
HSS112D	ON	ON

HSS208

2 poles

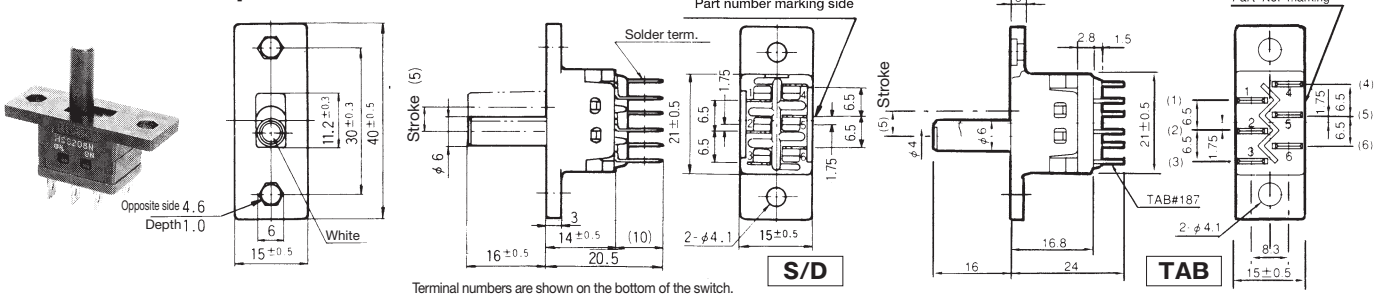

Specifications

	Rating	Initial contact resistance	Dielectric strength	Insulation resistance	Electrical life
HSS208K	AC125V 8A Max. AC250V 5A Max.	100mΩ Max. (DC2~4V 1A)	AC1500V 1 minute	100MΩ Min. (DC500V)	15,000 cycles
HSS208N	AC-DC 6V 1mA Min.				

Part No.	Switching function	
	ON	OFF
HSS208K	ON	OFF
HSS208N	ON	ON

■ To check the full part number of the products marked with the ■, please refer to "Table of Part Numbers" on P. 530.