

# EEV108M010A9PAA

EEV, Aluminum Electrolytic, 1,000 uF, 20%, 10 VDC, -55/+105°C

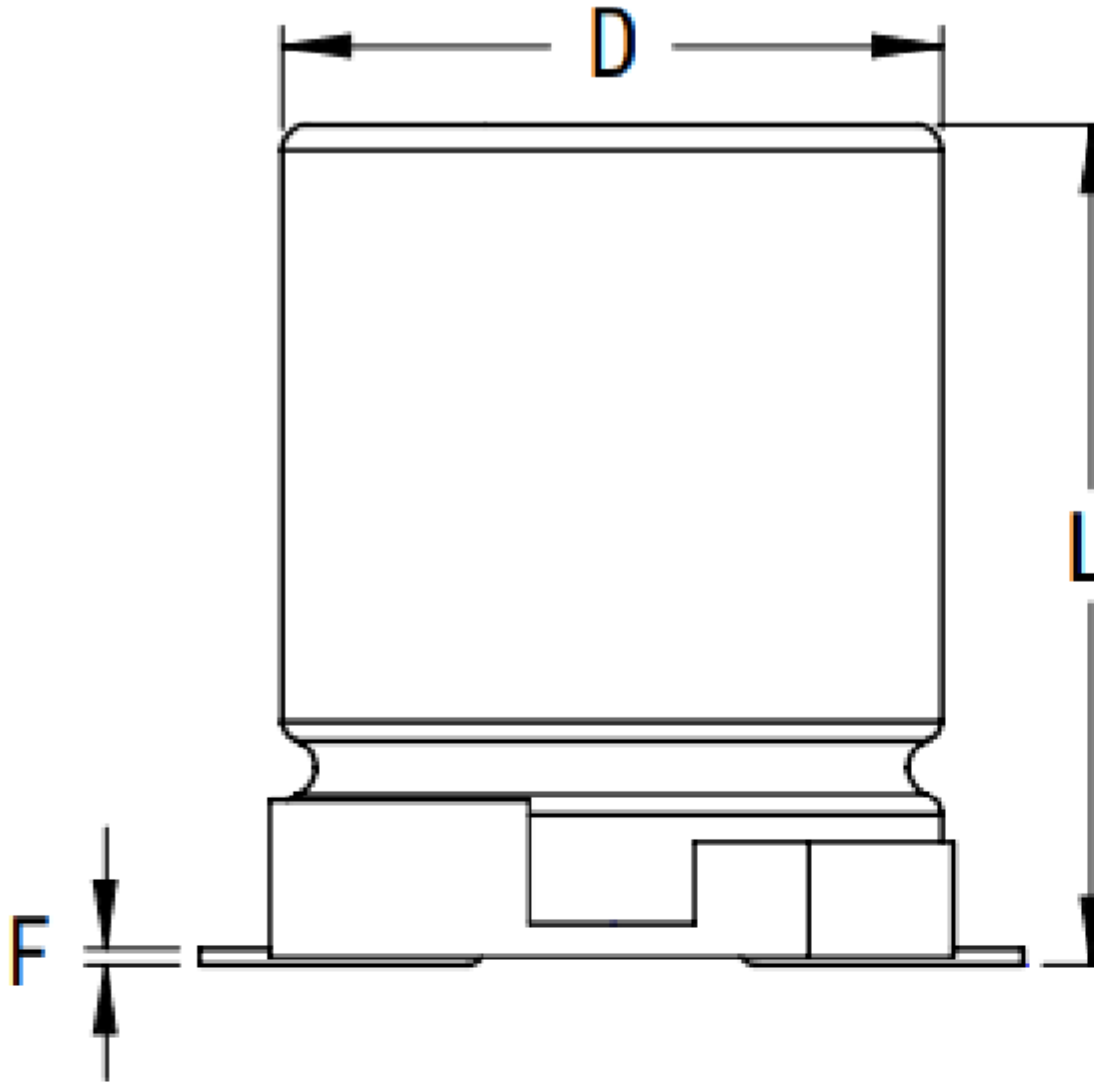

Click [here](#) for the 3D model.

### Dimensions

D 10mm +/-0.5mm  
L 10.2mm +/-0.3mm  
W 0.9mm +/-0.2mm  
F 0.3mm MAX  
A 10.3mm +/-0.2mm  
B 10.3mm +/-0.2mm  
C 13mm MAX  
E 3.5mm +/-0.2mm  
G 0.7mm +/-0.2mm  
P 4.6mm +/-0.2mm

### Packaging Specifications

Packaging T&R, 380mm  
Packaging Quantity 500

### General Information

Series EEV  
Dielectric Aluminum Electrolytic  
Style SMD Can  
Description Surface Mount, Aluminum Electrolytic  
Features Ultra Low Impedance  
RoHS Yes  
Lead V-Chip  
AEC-Q200 No

### Specifications

Capacitance	1,000 uF
Capacitance Tolerance	20%
Voltage DC	10 VDC, 13 VDC (Surge)
Temperature Range	-55/+105°C
Rated Temperature	105°C
Life	2000 Hrs
Dissipation Factor	19% 120Hz 20C
Resistance	0.08 Ohms (100kHz 20C)
Ripple Current	595 mAmps (120Hz 105C), 680 mAmps (1kHz), 850 mAmps (100kHz)
Leakage Current	100 uA (2min 20°C)
Impedance Ratio at -25C	2
Impedance Ratio at -40C	3
High Temperature Solder	Yes

Statements of suitability for certain applications are based on our knowledge of typical operating conditions for such applications, but are not intended to constitute - and we specifically disclaim - any warranty concerning suitability for a specific customer application or use. This Information is intended for use only

by customers who have the requisite experience and capability to determine the correct products for their application. Any technical advice inferred from this Information or otherwise provided by us with reference to the use of our products is given gratis, and we assume no obligation or liability for the advice given or results obtained.

Generated 5/18/2023 - bf8a2eb2-99da-415b-9318-ba790a528954

© 2006 - 2023 KEMET

Generated 5/18/2023 - bf8a2eb2-99da-415b-9318-ba790a528954

© 2006 - 2023 KEMET