

Type B2

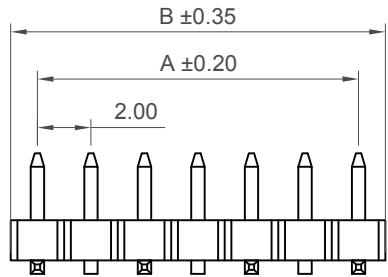

Specifications

Material

Insulator material:
 Standard
 Polyamide, Nylon 6T, UL 94V-0
 Options:
 Polymer, LCP, UL 94V-0
 Contact Terminal : Copper Alloy

Plating

See Ordering Grid

Electrical

Current Rating: 2 Amp per pin
 Contact Resistance: 20 mΩ max.
 Insulation Resistance: 1000 MΩ min.
 Dielectric Withstand Voltage: 500 V AC

Mechanical & Environmental

Operating Temperature: -40°C to +105°C

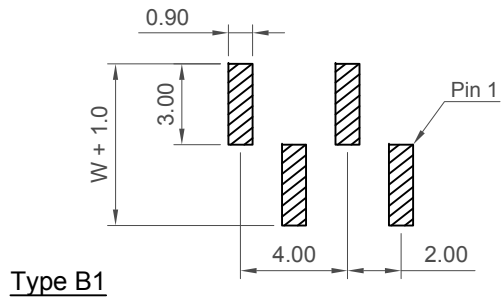

Type B1

Recommended PCB Layout

▨ Solder Area

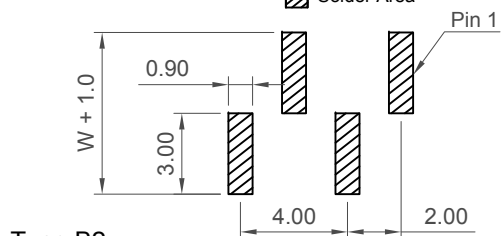

Type B2

Recommended PCB Layout

▨ Solder Area

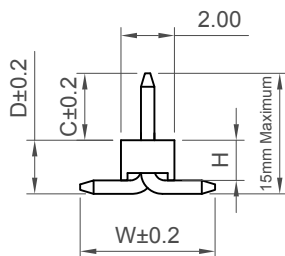

Soldering Process

Nylon 6T (Standard) -
 IR Reflow: 260°C for 10 sec.
 Manual Solder: 350°C for 3-5 sec
 LCP (Option) -
 IR Reflow: 260°C for 10 sec.
 Manual Solder: 350°C for 3-5 sec

Mates with (Subject to pin length)

BF070 BF085 BF086 BF087 BF088 BF090

BF085 Recommended mating length 3.00mm

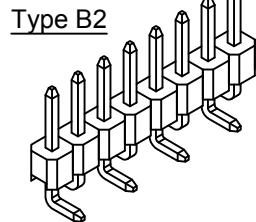
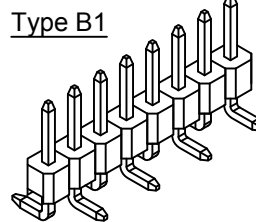

No. of Contacts	Dimensions	
	A	B
3	4.0	6.0
4	6.0	8.0
5	8.0	10.0
6	10.0	12.0
7	12.0	14.0
8	14.0	16.0
9	16.0	18.0
10	18.0	20.0
11	20.0	22.0
12	22.0	24.0
13	24.0	26.0
14	26.0	28.0
15	28.0	30.0
16	30.0	32.0
17	32.0	34.0
18	34.0	36.0
19	36.0	38.0
20	38.0	40.0
21	40.0	42.0

No. of Contacts	Dimensions	
	A	B
22	42.0	44.0
23	44.0	46.0
24	46.0	48.0
25	48.0	50.0
26	50.0	52.0
27	52.0	54.0
28	54.0	56.0
29	56.0	58.0
30	58.0	60.0
31	60.0	62.0
32	62.0	64.0
33	64.0	66.0
34	66.0	68.0
35	68.0	70.0
36	70.0	72.0
37	72.0	74.0
38	74.0	76.0
39	76.0	78.0
40	78.0	80.0

Ordering Grid

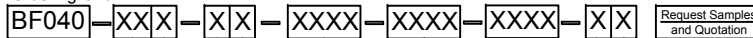

No. of Contacts
03 to 40

Contact Plating

A = Gold Flash All Over (Standard)
 B = Selective Gold Flash Contact Area/
 Tin On Tail
 C = Tin All Over
 G = 10µ" Gold Contact Area/Tin On Tail
 I = 30µ" Gold Contact Area/Tin On Tail

Insulator Height 'H'

B = 2.00mm (Standard)
 A = 1.50mm

Type
 1 = Type B1
 2 = Type B2

Dimension C (1/100mm) (Post Height)

0300 = 3.00mm (Standard)
 0400 = 4.00mm (Standard)
 0600 = 6.00mm (Standard)
 Or specify Dimension C
 eg 0250 = 2.50mm
 (Maximum 0800 = 8.00mm)
 (Minimum 0100 = 1.00mm)

Insulator Material

N = Nylon 6T (Standard)
 L = LCP

Dimension W (1/100mm) (Footprint Width)

0483 = 4.83mm (Standard)
 0500 = 5.00mm (Standard)
 Or specify Dimension W
 eg 0250 = 2.50mm (Tooling charge may apply)

Dimension D (1/100mm) (PCB to Top of Insulator)

0260 = 2.60mm (Standard - Minimum for 'H' = B)
 0210 = 2.10mm (Standard - Minimum for 'H' = A)
 Or specify Dimension D
 eg 0250 = 2.50mm

Packing Options

B = Tape & Reel with Cap (Standard)
 D = Tube
 E = Tube with Cap

Part Number		Product Description	
BF040		2.00mm Pitch Pin Header	
Drawing Date		Single Row, Surface Mount	
31st October 2007			
By	CC	Tolerances (Except as Noted)	Units:
Detail	BF040 E PCN	Length X.X ± 0.38 X.XX ± 0.25 X.XXX ± 0.13	Metric (mm)
Revision	E3	Angle X.X° ± 5° X.XX° ± 2° X.XXX° ± 1°	3rd Angle Projection
Date	11/09/17	X.XXX* ± 0.5°	



This drawing is confidential and copyright of Global Connector Technology, Ltd (GCT). This drawing must not be copied or disclosed without written consent. E & OE



www.gct.co

Not to Scale	Drawn By LYH	Sheet No. 1/1
--------------	--------------	---------------