

CIRCUIT SIZE	DIM A (±.010/±0.25)	DIM B
2	.623 (15.82)	.295 ±.006 (7.49 ±0.15)
3	.918 (23.32)	.590 ±.008 (14.99 ±0.20)
4	1.213 (30.82)	.885 ±.008 (22.48 ±0.20)
5	1.508 (38.30)	1.180 ±.008 (29.97 ±0.20)
6	1.803 (45.80)	1.475 ±.010 (37.47 ±0.25)
8	2.393 (60.78)	2.065 ±.008 (52.45 ±0.20)

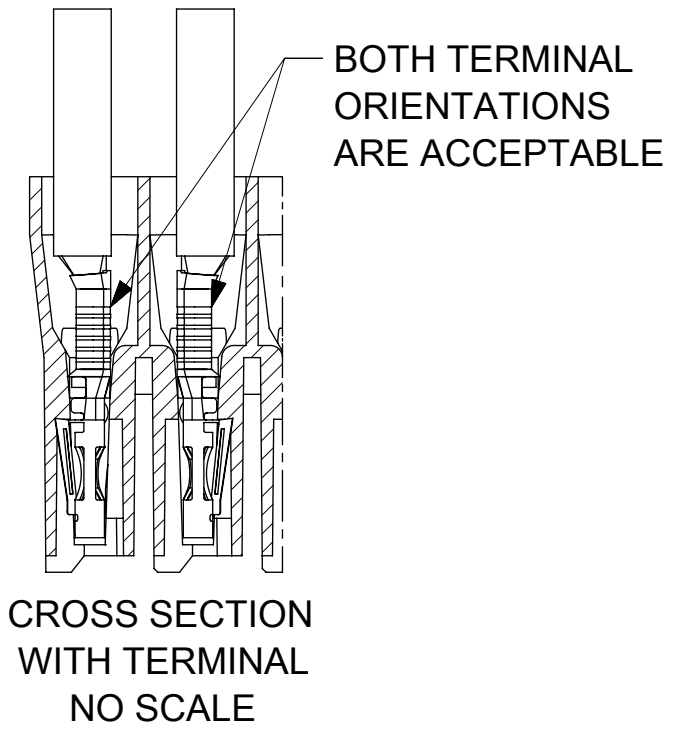
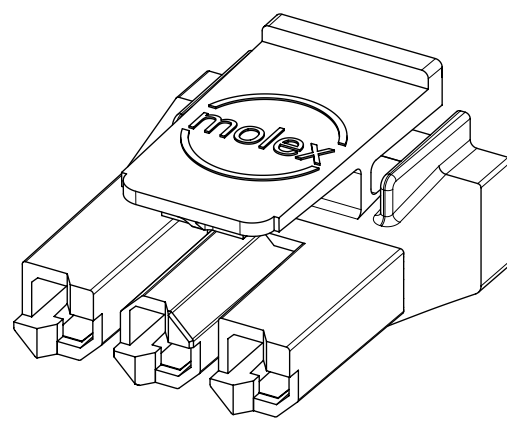
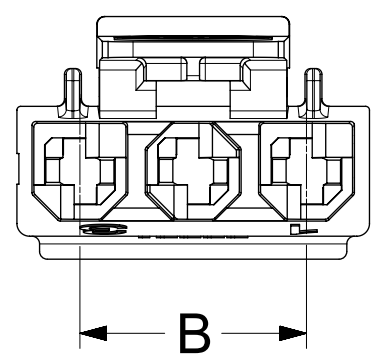

- NOTES:**
1. MATERIAL: SEE CHART.
 2. THIS CONNECTOR HOUSING FOR USE WITH 171825 TERMINALS.
 3. THIS CONNECTOR HOUSING WILL MATE TO 172042, 172043, 172673, AND 43680.
 4. PRODUCT SPECIFICATION: PS-171825-001.
 5. PACKAGING: PK-44441-001.
 6. PARTS CONFORM TO CLASS 'B' REQUIREMENTS OF COSMETIC SPECIFICATION PS-45499-002 BUT, MEETS CLASS 'C' REQUIREMENTS FOR BUBBLES, SINK AND DISCOLORATION.
 7. MOLDED IN SERIES NO. MAY BE 172672 OR 44441.
 8. TEXT ON PART IS FOR REFERENCE ONLY. TEXT AND TEXT LOCATION MAY VARY DEPENDING ON PART NUMBER AND/OR TOOL.
 9. LAST CIRCUIT I.D. NOT PRESENT ON 2 CIRCUIT PARTS.
 10. DIMENSION C IS .600/(15.24) FOR 2 AND 8 CIRCUIT PARTS
DIMENSION C IS .632/(16.05) FOR ALL OTHER CIRCUIT SIZES.
 11. THIS DRAWING REPLACES SD-172672-001.

SYMBOLS	THIS DRAWING CONTAINS INFORMATION THAT IS PROPRIETARY TO MOLEX ELECTRONIC TECHNOLOGIES, LLC AND SHOULD NOT BE USED WITHOUT WRITTEN PERMISSION		CURRENT REV DESC: UPDATE TOLERANCES	
	DIMENSION UNITS	SCALE		
▽ = 0	IN/MM	2:1		
▽ = 0	GENERAL TOLERANCES (UNLESS SPECIFIED)			
▽ = 0		MM	INCH	
▽ = 0	4 PLACES ±			
▽ = 0	3 PLACES ±		± 0.01	
▽ = 0	2 PLACES ±	0.25	± 0.014	
▽ = 0	1 PLACE ±	0.35		
▽ = 0	0 PLACES ±			
⊠ = 0	ANGULAR TOL ± 0.5°			
■ = 0	DRAFT WHERE APPLICABLE MUST REMAIN WITHIN DIMENSIONS		THIRD ANGLE PROJECTION	DRAWING
▽ = 0			SERIES	
			B-SIZE	172672
DOCUMENT NUMBER		DOC TYPE		DOC PART
1726720000-SD		PSD		000
MATERIAL NUMBER		CUSTOMER		SHEET NUMBER
SEE CHART		GENERAL MARKET		1 OF 2

CIRCUIT SIZE	PART NO.	MATERIAL	COLOR
2	1726722002	UL94V-0 NYLON MEETS REQUIREMENTS FOR DIRECT SUPPORT OF UNINSULATED LIVE PARTS AS DESCRIBED IN UL508C	BLACK
3	1726722003		
4	1726722004		
5	1726722005		
6	1726722006		
8	1726722008		
2	1726723002	UL94V-2 NYLON IEC 60335-1 GLOW WIRE CAPABLE	BLACK
3	1726723003		
4	1726723004		
5	1726723005		
6	1726723006		
8	1726723008		

POLARIZATION LAYOUT

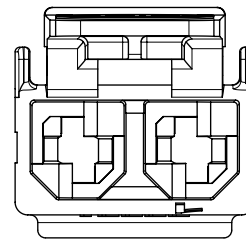

2-CKT.

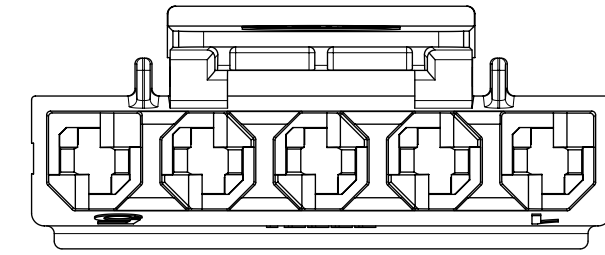

5-CKT.

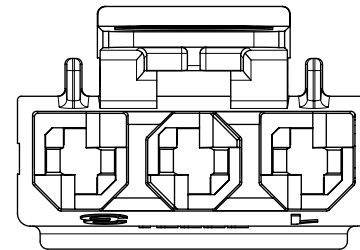

3-CKT.

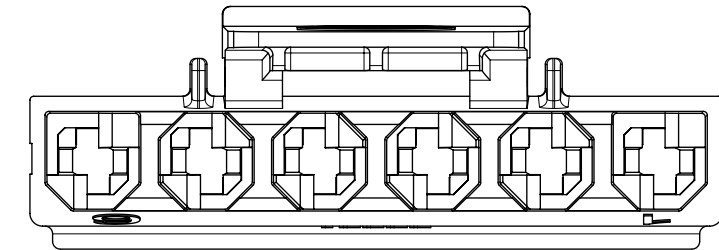

6-CKT.

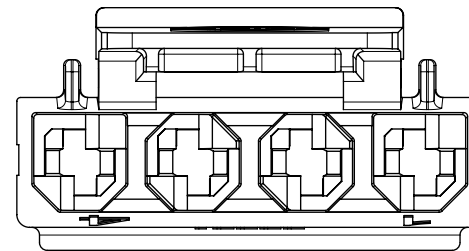

4-CKT.

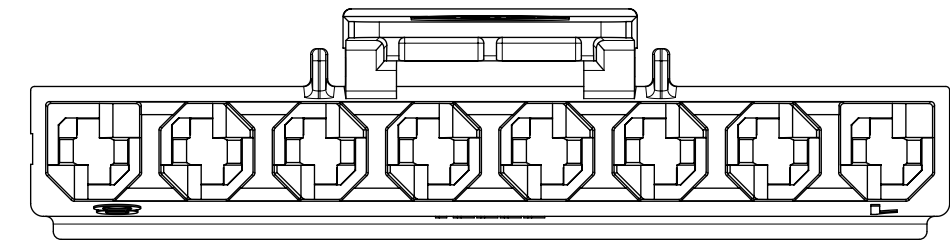

8-CKT.

SYMBOLS = 0 = 0 = 0 = 0 = 0 = 0 = 0 = 0 = 0 = 0	THIS DRAWING CONTAINS INFORMATION THAT IS PROPRIETARY TO MOLEX ELECTRONIC TECHNOLOGIES, LLC AND SHOULD NOT BE USED WITHOUT WRITTEN PERMISSION		DIMENSION UNITS: IN/MM SCALE: 2:1		CURRENT REV DESC: UPDATE TOLERANCES		<div style="text-align: center;">molex</div> 172672 SUPER SABRE RECEPTACLE HOUSING	
	GENERAL TOLERANCES (UNLESS SPECIFIED)		EC NO: 604166 DRWN: JBAUMERT 2018/09/07 CHK'D: MKIPPER 2018/09/12 APPR: FSMITH 2018/09/13		PRODUCT CUSTOMER DRAWING			
	4 PLACES ± 0.25 ± 0.014 3 PLACES ± 0.25 ± 0.014 2 PLACES ± 0.25 ± 0.014 1 PLACE ± 0.35 ± 0.014 0 PLACES ± 0.35 ± 0.014		INITIAL REVISION: DRWN: CSLAFTER 2016/12/28 APPR: FSMITH		DOCUMENT NUMBER: 1726720000-SD DOC TYPE: PSD DOC PART: 000 REVISION: A1			
	ANGULAR TOL ± 0.5° DRAFT WHERE APPLICABLE MUST REMAIN WITHIN DIMENSIONS		THIRD ANGLE PROJECTION 		DRAWING: B-SIZE SERIES: 172672		MATERIAL NUMBER: SEE CHART CUSTOMER: GENERAL MARKET SHEET NUMBER: 2 OF 2	