

20 19 18 17 16 15 14 13 12 11 44234 9 8 7 6 5 4 3 2 1

MATERIAL NO.	MATERIAL (SEE NOTE 1)	COLOR	FLAMMABILITY
44234-0001	A	NATURAL	V-2
44234-0002	B	BLACK	V-2

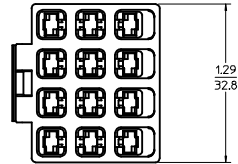

- NOTE:
- MATERIAL:
    - A. NYLON UL94V-2,COLOR:NATURAL.
    - B. NYLON UL94V-2,COLOR:BLACK.
  - FINISH: NONE
  - PRODUCT SPECIFICATION: NONE
  - CIRCUIT CENTER TO CENTER DIMENSION MEASURED AT DATUM E.
  - MATES WITH PLUG HOUSING, PART NUMBER SD-44232-001.

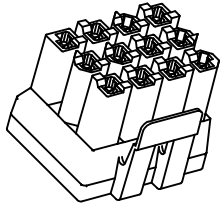
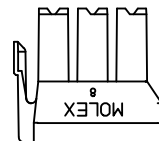
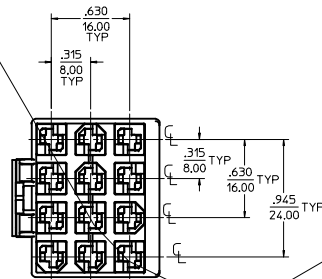
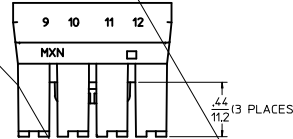
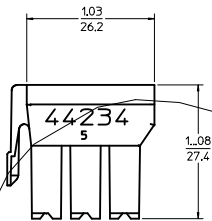
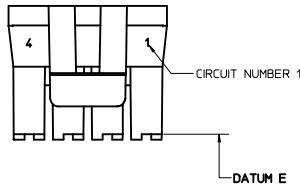

VOID DWG EC NO: UCP2016-0620 DRAWN: MONTI 2015/08/07 CHKD: RANDERSON 15/08/07 APPR: ESMITH 2015/08/13	QUALITY SYMBOLS 0 0	GENERAL TOLERANCES (UNLESS SPECIFIED)		SCALE 2:1	DESIGN UNITS INCH	THIRD ANGLE PROJECTION	REVISE ON CAD ONLY		
		4 PLACES ±.010 ±.010 3 PLACES ±.010 ±.010 2 PLACES ±.025 ±.014 1 PLACE ±.035 ±.014		DIMENSION STYLE IN/MM		TITLE F.I.C. RECEPTACLE HSG 12 CIRCUIT F.B.S., TPA			
		ANGULAR ±1/2°		DRAWN BY JIWANG		DATE 02/02/00		MOLEX MOLEX INCORPORATED	
		DRAFT WHERE APPLICABLE MUST REMAIN WITHIN DIMENSIONS		CHECKED BY E.SOMMER		DATE 02/02/00		MATERIAL NO. SEE CHART	
APPROVED BY R.EDGLEY		DATE 02/02/00		DOCUMENT NO. SD-44234-001		SHEET NO. 1 OF 1			
THIS DRAWING CONTAINS INFORMATION THAT IS PROPRIETARY TO MOLEX INCORPORATED AND SHOULD NOT BE USED WITHOUT WRITTEN PERMISSION									

19 18 17 16 15 14 13 12 11 10 9 8 7 6 5 4 3 2 1