

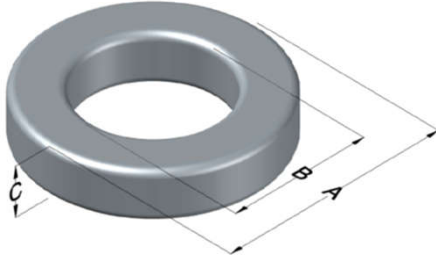

**0077164A7**

110 Delta Drive  
 Pittsburgh, PA 15238  
 NAFTA Sales: (1)800-245-3984  
 HK Sales : (852)3102-9337  
 magnetics@spang.com  
 www.mag-inc.com



Kool M $\mu$ Permeability ( $\mu$ )	A <sub>L</sub> (nH/T <sup>2</sup> )	Core Marking			Coating Color
		Lot Number	Part Number	Inductance Grade	
14	42 ± 8%	XXXXXX	77164A7	N/A	Black

Dimensions	Uncoated		Coated Limits			Packaging
	(mm)	(in)	(mm)	(in)		
OD (A)	165.10	6.500	166.50	6.555	max	Cardboard cut-outs Box Qty= 6 pcs
ID (B)	102.41	4.032	101.02	3.977	min	
HT (C)	31.75	1.250	33.15	1.305	max	

Electrical Characteristics			Physical Characteristics						
Watt Loss @ 100kHz, 100mT max (mW/cm <sup>3</sup> )	DC Bias min (oersteds)		Voltage Breakdown wire to wire min (V <sub>AC</sub> )	Break Strength min (kg)	Window Area W <sub>a</sub> (mm <sup>2</sup> )	Cross Section A <sub>e</sub> (mm <sup>2</sup> )	Path Length L <sub>e</sub> (mm)	Volume V <sub>e</sub> (mm <sup>3</sup> )	Est. Weight (g)
	80%	50%							
1200	175	350	3000	227.0	8,020	987	412.4	407,000	2,120

Winding Information					Temperature Rating	
Winding Length Per Turn				Wound Coil Dimensions (mm)		Curie Temp: 500°C
Winding Factor	(mm)	Winding Factor	(mm)	40% Winding Factor	OD	187
					HT	63.8
0%	132	40%	183	Completely Full Window	Max OD	197
20%	158	45%	191		Max HT	105
25%	164	50%	198	Surface Area (mm <sup>2</sup> )		
30%	169	60%	213	Unwound Core	55,000	
35%	177	70%	231	40% Winding Factor	99,000	
Notes:						
Coating Temp (Continuous up to): 200°C						

