

THIS DRAWING IS UNPUBLISHED. RELEGATED FOR PROTECTION. COPYRIGHT 1988 BY AMP INCORPORATED. ALL RIGHTS RESERVED.

REV	DATE	DESCRIPTION	DATE	BY	APPD
0		DRAWN: WAS 95-6226-100-1	-	-	-
A	EC 0504-0055-S6		10/25/95	SB	CR

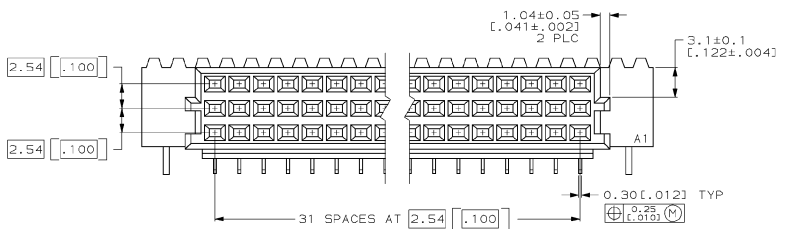

- ⚠ HOUSING MATERIAL: GLASS-FILLED POLYESTER. COLOR: GRAY.
- ⚠ CONTACT MATERIAL: PHOSPHOR BRONZE.
- ⚠ CONTACT FINISH: 0.00076 [.000030] GOLD IN CONTACT AREA. 0.00127 [.000050] NICKEL UNDERPLATE ALL OVER. TIN-LEAD ON POSTS.
- ⚠ RECOMMENDED HOLE SIZE FOR MANUAL APPLICATION OF CONNECTOR ONTO PC BOARD.
- ⚠ PART NUMBER, DATE CODE IDENTIFICATION, CSA LOGO HOT-STAMPED THIS APPROXIMATE AREA.
- ⚠ CONTACT POINT.
- ⚠ HOT-STAMPING ON THIS SIDE.
- ⚠ RECOMMENDED PRINTED CIRCUIT BOARD THICKNESS IS 1.57 [.062].

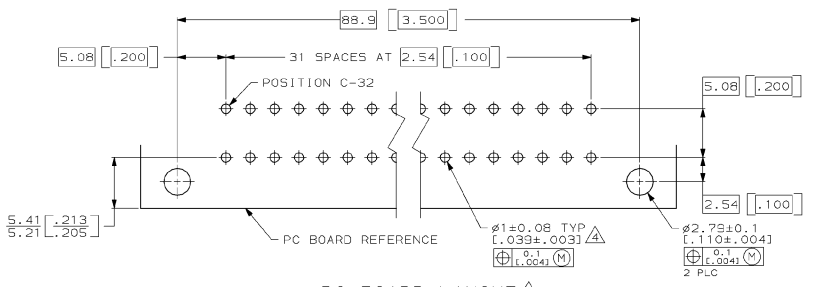
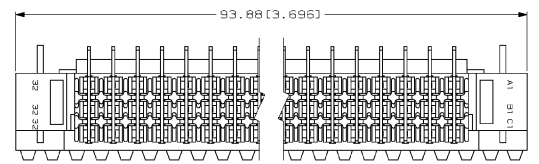
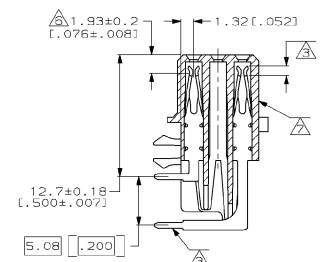
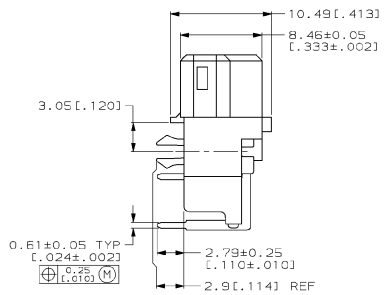
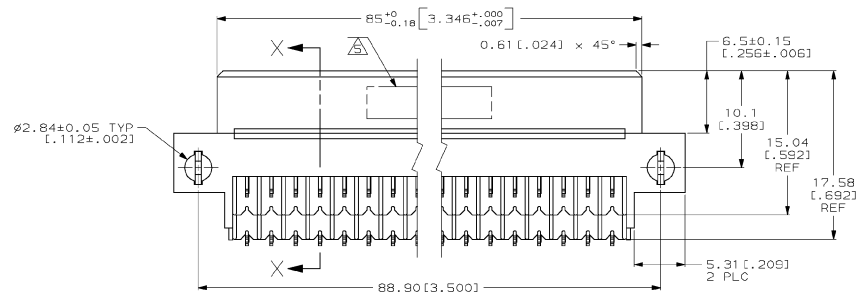

PC BOARD LAYOUT

POSITIONS LOADED	X	-	X	54	148168-4
ROWS LOADED	C	B	A	NO. OF LOADED POSITIONS	PART NUMBER
1-32					

DIMENSIONS:		DATE		REV	
1	10.13 (0.05)	6/13/95	6/13/95	1	AMP INCORPORATED
2	10.13 (0.05)	6/13/95	6/13/95	2	AMP INCORPORATED
3	10.13 (0.05)	6/13/95	6/13/95	3	AMP INCORPORATED
4	10.13 (0.05)	6/13/95	6/13/95	4	AMP INCORPORATED
5	10.13 (0.05)	6/13/95	6/13/95	5	AMP INCORPORATED
6	10.13 (0.05)	6/13/95	6/13/95	6	AMP INCORPORATED
7	10.13 (0.05)	6/13/95	6/13/95	7	AMP INCORPORATED
8	10.13 (0.05)	6/13/95	6/13/95	8	AMP INCORPORATED
9	10.13 (0.05)	6/13/95	6/13/95	9	AMP INCORPORATED
10	10.13 (0.05)	6/13/95	6/13/95	10	AMP INCORPORATED
11	10.13 (0.05)	6/13/95	6/13/95	11	AMP INCORPORATED
12	10.13 (0.05)	6/13/95	6/13/95	12	AMP INCORPORATED
13	10.13 (0.05)	6/13/95	6/13/95	13	AMP INCORPORATED
14	10.13 (0.05)	6/13/95	6/13/95	14	AMP INCORPORATED
15	10.13 (0.05)	6/13/95	6/13/95	15	AMP INCORPORATED
16	10.13 (0.05)	6/13/95	6/13/95	16	AMP INCORPORATED
17	10.13 (0.05)	6/13/95	6/13/95	17	AMP INCORPORATED
18	10.13 (0.05)	6/13/95	6/13/95	18	AMP INCORPORATED
19	10.13 (0.05)	6/13/95	6/13/95	19	AMP INCORPORATED
20	10.13 (0.05)	6/13/95	6/13/95	20	AMP INCORPORATED
21	10.13 (0.05)	6/13/95	6/13/95	21	AMP INCORPORATED
22	10.13 (0.05)	6/13/95	6/13/95	22	AMP INCORPORATED
23	10.13 (0.05)	6/13/95	6/13/95	23	AMP INCORPORATED
24	10.13 (0.05)	6/13/95	6/13/95	24	AMP INCORPORATED
25	10.13 (0.05)	6/13/95	6/13/95	25	AMP INCORPORATED
26	10.13 (0.05)	6/13/95	6/13/95	26	AMP INCORPORATED
27	10.13 (0.05)	6/13/95	6/13/95	27	AMP INCORPORATED
28	10.13 (0.05)	6/13/95	6/13/95	28	AMP INCORPORATED
29	10.13 (0.05)	6/13/95	6/13/95	29	AMP INCORPORATED
30	10.13 (0.05)	6/13/95	6/13/95	30	AMP INCORPORATED
31	10.13 (0.05)	6/13/95	6/13/95	31	AMP INCORPORATED
32	10.13 (0.05)	6/13/95	6/13/95	32	AMP INCORPORATED
33	10.13 (0.05)	6/13/95	6/13/95	33	AMP INCORPORATED
34	10.13 (0.05)	6/13/95	6/13/95	34	AMP INCORPORATED
35	10.13 (0.05)	6/13/95	6/13/95	35	AMP INCORPORATED
36	10.13 (0.05)	6/13/95	6/13/95	36	AMP INCORPORATED
37	10.13 (0.05)	6/13/95	6/13/95	37	AMP INCORPORATED
38	10.13 (0.05)	6/13/95	6/13/95	38	AMP INCORPORATED
39	10.13 (0.05)	6/13/95	6/13/95	39	AMP INCORPORATED
40	10.13 (0.05)	6/13/95	6/13/95	40	AMP INCORPORATED
41	10.13 (0.05)	6/13/95	6/13/95	41	AMP INCORPORATED
42	10.13 (0.05)	6/13/95	6/13/95	42	AMP INCORPORATED
43	10.13 (0.05)	6/13/95	6/13/95	43	AMP INCORPORATED
44	10.13 (0.05)	6/13/95	6/13/95	44	AMP INCORPORATED
45	10.13 (0.05)	6/13/95	6/13/95	45	AMP INCORPORATED
46	10.13 (0.05)	6/13/95	6/13/95	46	AMP INCORPORATED
47	10.13 (0.05)	6/13/95	6/13/95	47	AMP INCORPORATED
48	10.13 (0.05)	6/13/95	6/13/95	48	AMP INCORPORATED
49	10.13 (0.05)	6/13/95	6/13/95	49	AMP INCORPORATED
50	10.13 (0.05)	6/13/95	6/13/95	50	AMP INCORPORATED
51	10.13 (0.05)	6/13/95	6/13/95	51	AMP INCORPORATED
52	10.13 (0.05)	6/13/95	6/13/95	52	AMP INCORPORATED
53	10.13 (0.05)	6/13/95	6/13/95	53	AMP INCORPORATED
54	10.13 (0.05)	6/13/95	6/13/95	54	AMP INCORPORATED
55	10.13 (0.05)	6/13/95	6/13/95	55	AMP INCORPORATED
56	10.13 (0.05)	6/13/95	6/13/95	56	AMP INCORPORATED
57	10.13 (0.05)	6/13/95	6/13/95	57	AMP INCORPORATED
58	10.13 (0.05)	6/13/95	6/13/95	58	AMP INCORPORATED
59	10.13 (0.05)	6/13/95	6/13/95	59	AMP INCORPORATED
60	10.13 (0.05)	6/13/95	6/13/95	60	AMP INCORPORATED
61	10.13 (0.05)	6/13/95	6/13/95	61	AMP INCORPORATED
62	10.13 (0.05)	6/13/95	6/13/95	62	AMP INCORPORATED
63	10.13 (0.05)	6/13/95	6/13/95	63	AMP INCORPORATED
64	10.13 (0.05)	6/13/95	6/13/95	64	AMP INCORPORATED
65	10.13 (0.05)	6/13/95	6/13/95	65	AMP INCORPORATED
66	10.13 (0.05)	6/13/95	6/13/95	66	AMP INCORPORATED
67	10.13 (0.05)	6/13/95	6/13/95	67	AMP INCORPORATED
68	10.13 (0.05)	6/13/95	6/13/95	68	AMP INCORPORATED
69	10.13 (0.05)	6/13/95	6/13/95	69	AMP INCORPORATED
70	10.13 (0.05)	6/13/95	6/13/95	70	AMP INCORPORATED
71	10.13 (0.05)	6/13/95	6/13/95	71	AMP INCORPORATED
72	10.13 (0.05)	6/13/95	6/13/95	72	AMP INCORPORATED
73	10.13 (0.05)	6/13/95	6/13/95	73	AMP INCORPORATED
74	10.13 (0.05)	6/13/95	6/13/95	74	AMP INCORPORATED
75	10.13 (0.05)	6/13/95	6/13/95	75	AMP INCORPORATED
76	10.13 (0.05)	6/13/95	6/13/95	76	AMP INCORPORATED
77	10.13 (0.05)	6/13/95	6/13/95	77	AMP INCORPORATED
78	10.13 (0.05)	6/13/95	6/13/95	78	AMP INCORPORATED
79	10.13 (0.05)	6/13/95	6/13/95	79	AMP INCORPORATED
80	10.13 (0.05)	6/13/95	6/13/95	80	AMP INCORPORATED
81	10.13 (0.05)	6/13/95	6/13/95	81	AMP INCORPORATED
82	10.13 (0.05)	6/13/95	6/13/95	82	AMP INCORPORATED
83	10.13 (0.05)	6/13/95	6/13/95	83	AMP INCORPORATED
84	10.13 (0.05)	6/13/95	6/13/95	84	AMP INCORPORATED
85	10.13 (0.05)	6/13/95	6/13/95	85	AMP INCORPORATED
86	10.13 (0.05)	6/13/95	6/13/95	86	AMP INCORPORATED
87	10.13 (0.05)	6/13/95	6/13/95	87	AMP INCORPORATED
88	10.13 (0.05)	6/13/95	6/13/95	88	AMP INCORPORATED
89	10.13 (0.05)	6/13/95	6/13/95	89	AMP INCORPORATED
90	10.13 (0.05)	6/13/95	6/13/95	90	AMP INCORPORATED
91	10.13 (0.05)	6/13/95	6/13/95	91	AMP INCORPORATED
92	10.13 (0.05)	6/13/95	6/13/95	92	AMP INCORPORATED
93	10.13 (0.05)	6/13/95	6/13/95	93	AMP INCORPORATED
94	10.13 (0.05)	6/13/95	6/13/95	94	AMP INCORPORATED
95	10.13 (0.05)	6/13/95	6/13/95	95	AMP INCORPORATED
96	10.13 (0.05)	6/13/95	6/13/95	96	AMP INCORPORATED
97	10.13 (0.05)	6/13/95	6/13/95	97	AMP INCORPORATED
98	10.13 (0.05)	6/13/95	6/13/95	98	AMP INCORPORATED
99	10.13 (0.05)	6/13/95	6/13/95	99	AMP INCORPORATED
100	10.13 (0.05)	6/13/95	6/13/95	100	AMP INCORPORATED