

PART NO.		RSA-3010-C3		
REV	DESCRIPTION	DWN	DATE	APPROVED
-	ENGINEERING RELEASE	CZ	11/04/21	JDMc

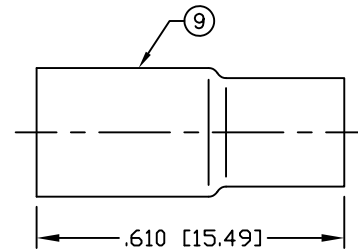

RECOMMENDED CRIMP SIZE: .213"

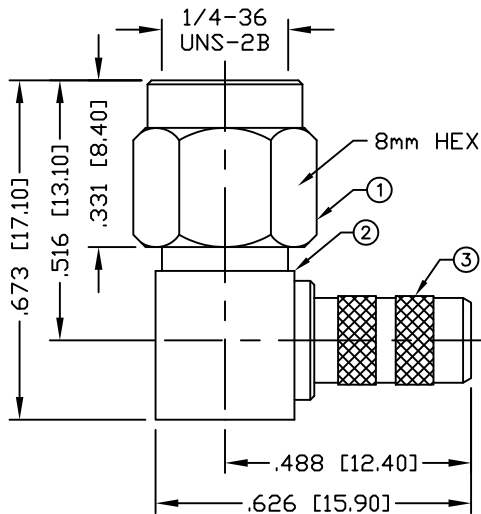
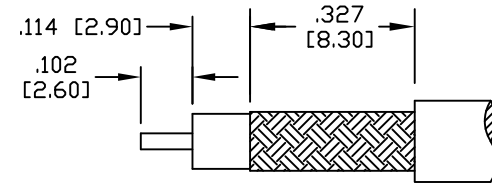

RECOMMENDED STRIPPING DIMENSIONS

NOTE: ATTACH CABLE TO CONNECTOR BY SOLDERING THE CABLE INNER CONDUCTOR TO THE PIN SLOT INSIDE THE CONNECTOR

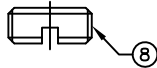

SPECIFICATIONS:

IMPEDANCE: 50 Ohms
 FREQUENCY RANGE: 0-12.4 GHz
 INSERTION LOSS(dB): $0.04 \times \sqrt{f(\text{GHz})}$
 VSWR: $1.15 + .03 \times \sqrt{f(\text{GHz})}$
 WORKING VOLTAGE: 500 V rms Max. @ Sea Level
 INSULATION RESISTANCE: 5k M Ohms min.
 TEMPERATURE RANGE: -65°C TO 85°C
 FOR ALPHA 9859, 9859-EL & 9158S, BELDEN 82240, 82907, 88240, 89907 & 84303, BERK-TEK 642002 & 640143, BICCGENERAL C3519 & C3579, CAROL/GENERAL C3519 & C3579, COLEMAN 921023, 821015, 921025, 921027 & 921021, CONTINENTAL C6101, DEC 17-01246-00, HELIX/HITEMP 497106, 497002 & 499109, TIMES MICROWAVE M17/111-RG303, 17-811-77 & AA-3417

1	SHELL	1	BRASS	NICKEL
2	BODY	1	BRASS	NICKEL
3	FERRULE STUD	1	BRASS	NICKEL
4	INSULATOR	1	PTFE	NATURAL
5	PIN	1	BRASS	GOLD
6	RETAINING RING	1	Be.Cu.	NATURAL
7	GASKET	1	SILICONE	RED
8	SCREW CAP	1	BRASS	NICKEL
9	FERRULE	1	BRASS	NICKEL
#	DESCRIPTION	QTY	MATERIAL	FINISH

CUSTOMER OUTLINE DRAWING	
ALL DIMENSIONS ARE REFERENCE ONLY	
UNLESS OTHERWISE SPECIFIED: DIMENSIONS ARE IN INCHES AND [MILLIMETERS]	
DRAWN C. ZUÑIGA	11/04/21
CHECKED	
ORJ DRAWN C. ZUÑIGA	11/04/21

RoHS COMPLIANT

PROPRIETARY AND CONFIDENTIAL

THIS DRAWING CONTAINS INFORMATION PROPRIETARY TO RF INDUSTRIES, ANY UNAUTHORIZED USE OF THIS DRAWING IS EXPRESSLY PROHIBITED WITHOUT WRITTEN PERMISSION FROM RF INDUSTRIES. ANY VIOLATION IS PUNISHABLE UNDER U.S. COPYRIGHT LAWS.

RFconnectors
 DIVISION OF RF INDUSTRIES, LTD. (858) 549-6345 FAX

RFINDUSTRIES.COM
 7610 MIRAMAR RD.
 SAN DIEGO, CA 92126
 (858) 549-6340

SMA PLUG CRIMP
 RIGHT ANGLE

DWG # **RSA-3010-C3**

CABLE GROUP C3	CONTROL # 001560	SCALE NTS	FORMAT A	SHEET 1 OF 1	REVISION -
-------------------	---------------------	--------------	-------------	-----------------	---------------