

PART NUMBER	NUMBER OF WIRE OPENINGS	CIRCUIT POSITION	WIRE SIZE(S) SEE NOTE 6	WIRE HOLE DIAMETER
46396-5201	3	1, 2, 3	16 AWG	2.34/.092
46396-5202	2	4, 5	10 AWG	4.46/.176
46396-5203	3	3, 4, 5	16 AWG	2.74/.108
46396-5204	3	1, 2, 3	12 AWG	3.92/.154
46396-5205	3	1, 2, 3	10 AND 12 AWG	(214,34/.172 114,74/.188)
46396-5211	3	1, 2, 3	16 AWG	2.74/.108
46396-5231	5	1, 2, 3, 4, 5	12 AWG	4.00/.158

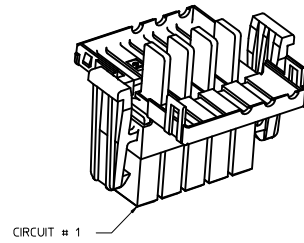

CIRCUIT # 1

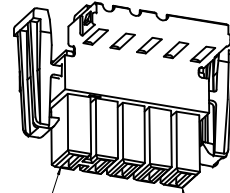

POLARIZATION LOCATION  
CIRCUIT # 1

- NOTES:
1. MATERIAL: PBT OR EQUIVALENT, 94V-0. COLOR: BLACK
  2. HOUSING ACCEPTS MOLEX TERMINAL SERIES: 44262-4\*\*\*\* (SEE MOLEX DRAWING NUMBER SD-44262-001 FOR TERMINAL OPTIONS)
  3. HOUSING AND ASSOCIATED COMPONENTS ARE RoHS COMPLIANT
  4. PACKAGED PER MOLEX PACKAGING SPEC: PK-46396-\*\*\*\*
  5. RECEPTACLE HOUSING MATES WITH PLUG HOUSING 46394-5001 (SEE MOLEX DRAWING NUMBER SD-46394-001 FOR DETAILS)
  6. FINAL FIT OF WIRE THRU WIRE OPENINGS WILL DEPEND ON THE OUTSIDE DIAMETER OF THE WIRE.

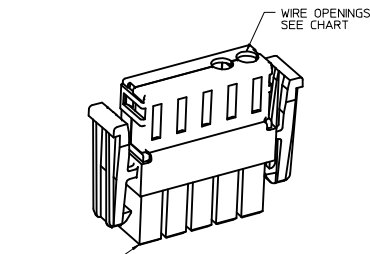
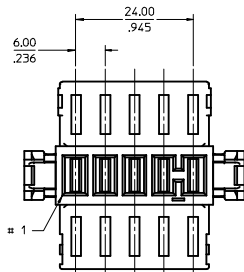
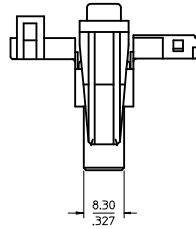
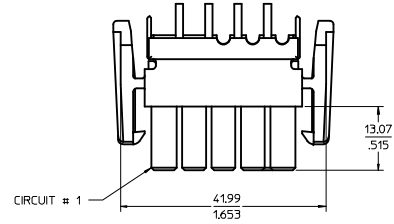
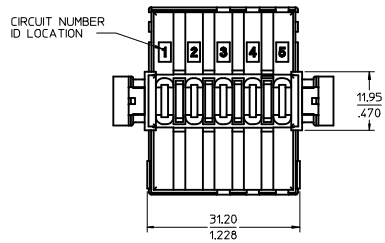

CIRCUIT # 1  
46396-5202

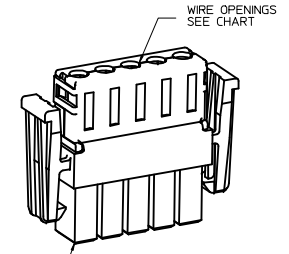

CIRCUIT # 1  
46396-5231

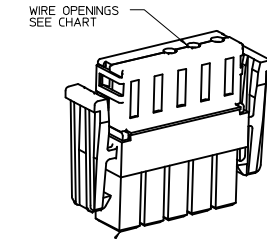

CIRCUIT # 1  
46396-5203

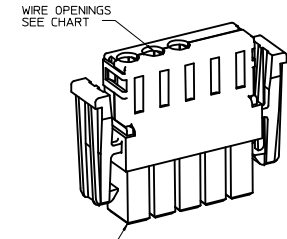

CIRCUIT # 1  
46396-5201, 46396-5204,  
46396-5205 AND 46396-5211

WIRE OPENING CONFIGURATIONS  
CONNECTORS SHOWN CLOSED

<b>ADD PART NOS TO CHG</b> EC NO: UCP2009-0623 DRAWN DATA: 2008/09/23 CHYK: 2008/09/23 APPR: JCOMERCL APPR: 2008/10/03	<b>QUALITY SYMBOLS</b> ∇=0 ∇=0 ∇=0	<b>GENERAL TOLERANCES (UNLESS SPECIFIED)</b>		<b>DIMENSION STYLE</b> MM/IN	<b>SCALE</b> 2:1	<b>DESIGN UNITS</b> METRIC	THIRD ANGLE PROJECTION		
		4 PLACES ± --- ± --- 3 PLACES ± --- ± .005 2 PLACES ± 0.13 ± .010 1 PLACE ± 0.25 ± ---	mm      INCH	DRAWN BY: MDATA      DATE: 07-10-07 CHECKED BY: MDATA      DATE: 2007/01/15 APPROVED BY: APATEL      DATE: 2007/01/15	TITLE: RECEPTACLE HOUSING 5 POSITION WITH LATCH POWER CONNECTOR		MATERIAL NO. SEE CHART	DOCUMENT NO. SD-46396-101	SHEET NO. 1 OF 1
		DRAFT WHERE APPLICABLE MUST REMAIN WITHIN DIMENSIONS		SEE CHART		MOLEX INCORPORATED			
		THIS DRAWING CONTAINS INFORMATION THAT IS PROPRIETARY TO MOLEX INCORPORATED AND SHOULD NOT BE USED WITHOUT WRITTEN PERMISSION							