

THIS IS A C.A.D. GENERATED DRAWING  
DO NOT MAKE MANUAL REVISIONS TO MASTER.

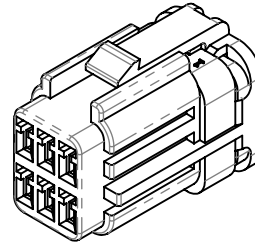

ISSUE NUMBER

ORIGINAL ①

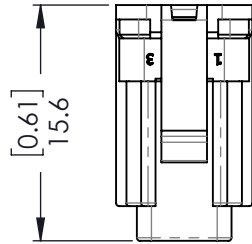

**MATERIALS:**

1. HOUSING: PBT, UL94V-0
2. WIRE-HOUSING SEAL: SILICON RUBBER

**SPECIFICATIONS:**

1. PITCH: 2.0MM
2. RATED VOLTAGE: 250V
3. RATED CURRENT: 2A MAX
4. WITHSTAND VOLTAGE: AC 1000V R.M.S.
5. CONTACT RESISTANCE: 10 mOHMS MAX
6. INSULATION RESISTANCE:  
1000 MOHMS MIN/DC 500V
7. TEMPERATURE RANGE: -40°C ~ +105°C
8. WATERPROOF GRADE: TESTED AND  
CERTIFIED TO IP67

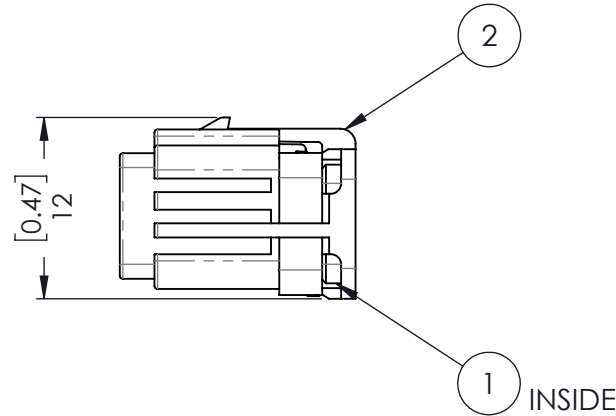
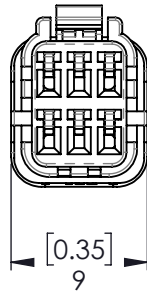

ITEM NO.	DESCRIPTION	QTY.
1	566 6PIN Rear Seal Orange	1
2	566-210-006-XXX Femal Housing	1

<b>566 SERIES 6 SOCKET WATERPROOF CONNECTOR</b>		ACAD REFERENCE NO. 566 ASSEMBLY
		DRAWN: R.STA.MONICA      DATE: NOV.02/10
		CHECKED:      DATE:
		SCALE: NOT TO SCALE      SHEET 1 OF 1
		DRAWING NUMBER      ISSUE
		566-006-000-811      1



THIS SERIES FULLY CONFORMS TO THE  
EUROPEAN UNION DIRECTIVES 2002/95/EC  
AND 2002/96/EC FOR RoHS COMPLIANCY



**EDAC INC**  
TORONTO, ONTARIO  
CANADA

YOUR CONNECTION TO QUALITY & SERVICE

THESE DRAWINGS AND SPECIFICATIONS  
ARE THE PROPERTY OF EDAC INC. AND  
SHALL NOT BE REPRODUCED, OR COPIED  
OR USED AS THE BASIS FOR THE  
MANUFACTURE OR SALE OF APPARATUS  
WITHOUT WRITTEN PERMISSION.