



DC to 18 GHz, DC to 26.5 GHz

Coaxial Adapters SMA and 3.5 mm

- Low VSWR
- Stainless Steel Precision Connectors

Specifications

SMA (M/F) Gender Changing, DC to 18 GHz

FREQUENCY RANGE (GHz)	MODEL	VSWR (max.)	WEIGHT (max.)		CONNECTORS
			oz.	gr.	
DC-18	59	1.25	0.5	14	SMA-F to SMA-F
	60B	1.25	0.5	14	SMA-M to SMA-M
	61B	1.25	0.5	14	SMA-F to SMA-M

3.5 mm (M/F) Gender Changing, DC to 26.5 GHz

FREQUENCY RANGE (GHz)	MODEL	VSWR (max.)		WEIGHT (max.)		CONNECTORS
		DC-18	18-26.5	oz.	gr.	
DC-26.5	69	1.25	1.30	0.5	14	3.5mm-F to 3.5mm-F
	70	1.25	1.30	0.5	14	3.5mm-M to 3.5mm-M
	71	1.25	1.30	0.5	14	3.5mm-F to 3.5mm-M

Adapters

Outline Drawings

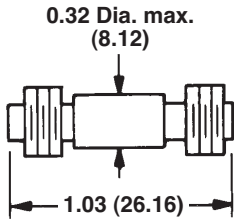

Model 59
SMA-F to SMA-F

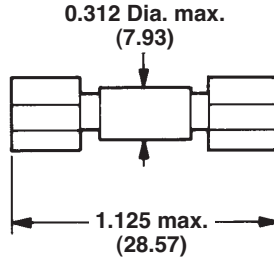

Model 60B
SMA-M to SMA-M

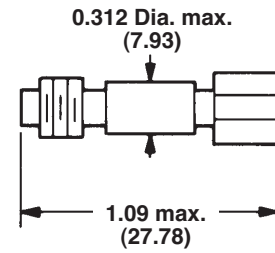

Model 61B
SMA-F to SMA-M

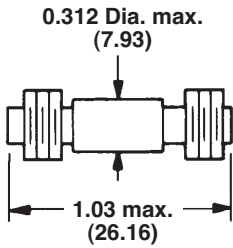

Model 69
3.5mm-F to 3.5mm-F

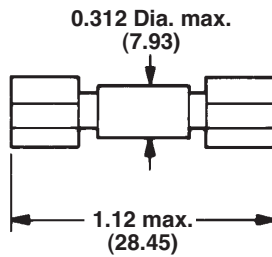

Model 70
3.5mm-M to 3.5mm-M

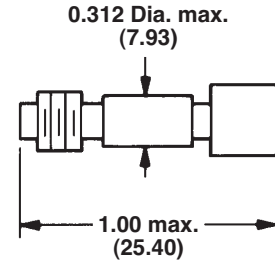

Model 71
3.5mm-F to 3.5mm-M

Dimensions in inches (mm in parentheses), unless otherwise specified.

