

CUSTOMER SPECIFICATION DRAWING

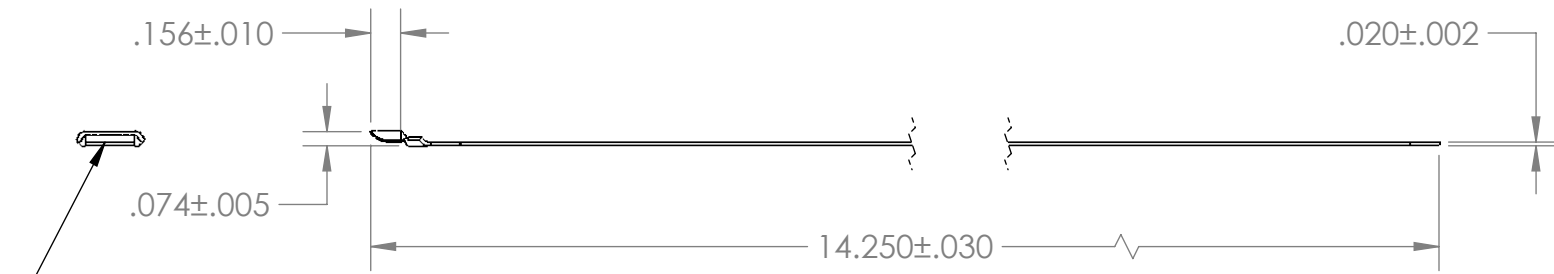

BAND MUST DOUBLE WRAP PULLING NO BURRS

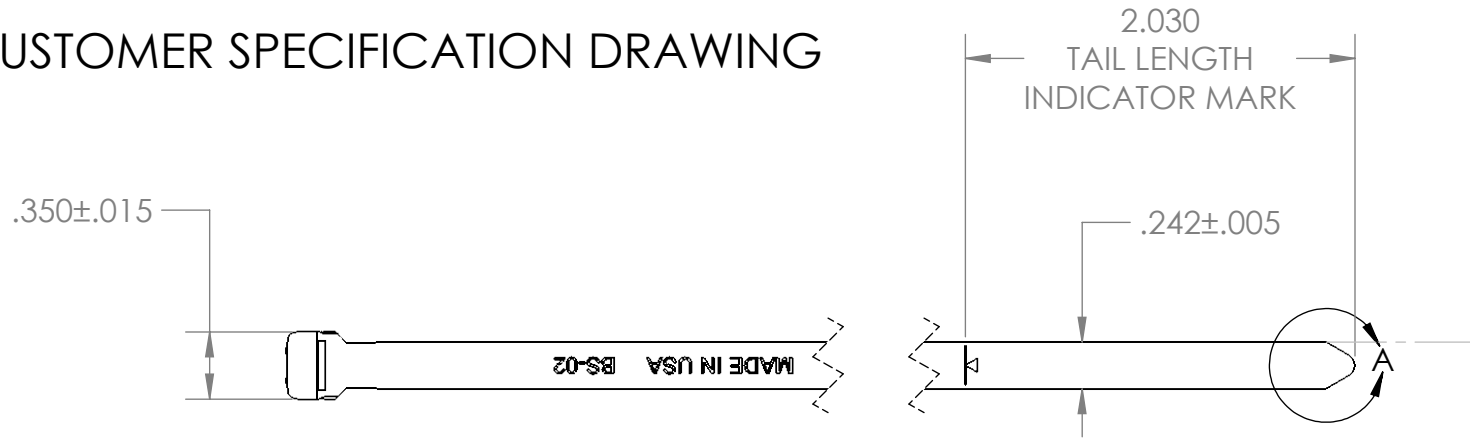
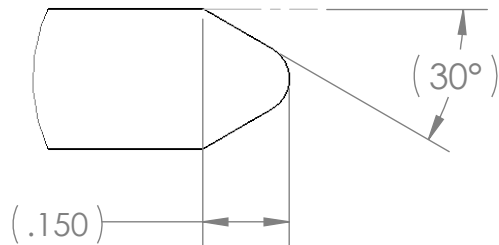

DETAIL A
SCALE 3 : 1

NOTES:

1. MATERIAL: 304 STAINLESS STEEL
2. FINISH: PASSIVATED
3. MATERIAL MEETS DFARS COMPLIANCE
4. PARTS MEET AEROSPACE STANDARD AS85049/128
5. ROHS COMPLIANT
6. DOUBLE WRAP USE ONLY

PROPRIETARY AND CONFIDENTIAL
THE INFORMATION CONTAINED IN THIS DRAWING IS THE SOLE PROPERTY OF BAND SOLUTIONS LLC. ANY REPRODUCTION IN PART OR AS A WHOLE WITHOUT THE WRITTEN PERMISSION OF BAND SOLUTIONS LLC IS PROHIBITED.

BAND SOLUTIONS LLC

TITLE:
EMR/RFI TERMINATION BAND
.242" x 14.250" 304SS - FLAT

SIZE A	DWG. NO. BA100FE	REV A
SCALE: 1:4	WEIGHT:	SHEET 1 OF 1