

LOOSE PIECE		TAPE MOUNTED		SPECIFICATIONS					
MATERIAL NUMBER	ENGINEERING NUMBER	MATERIAL NUMBER	ENGINEERING NUMBER	STUD SIZE	"S" ±.005 [0.13]	"W" ±.010 [0.25]	"C" MIN.	"L" MAX.	"H"
192030148	BB-T-325-14	---	---	14	.265 [6.73]	.467 [11.86]	.388 [9.86]	1.036 [26.31]	---
192030149	BB-T-337-06	---	---	6	.146 [3.71]	.312 [7.92]	.285 [7.24]	.645 [16.38]	.980 [24.89]
192030063	BB-T-337-10	192030064	BB-T-337-10T	10	.198 [5.03]				

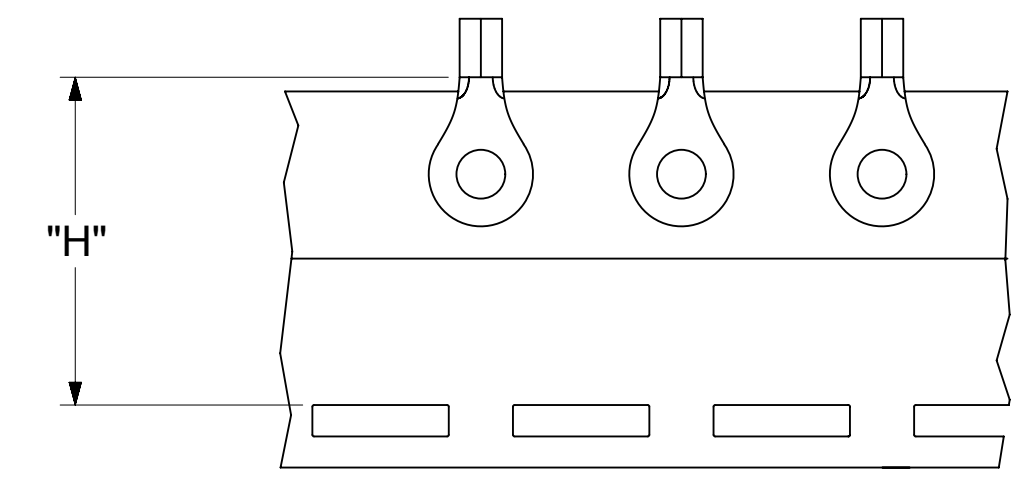
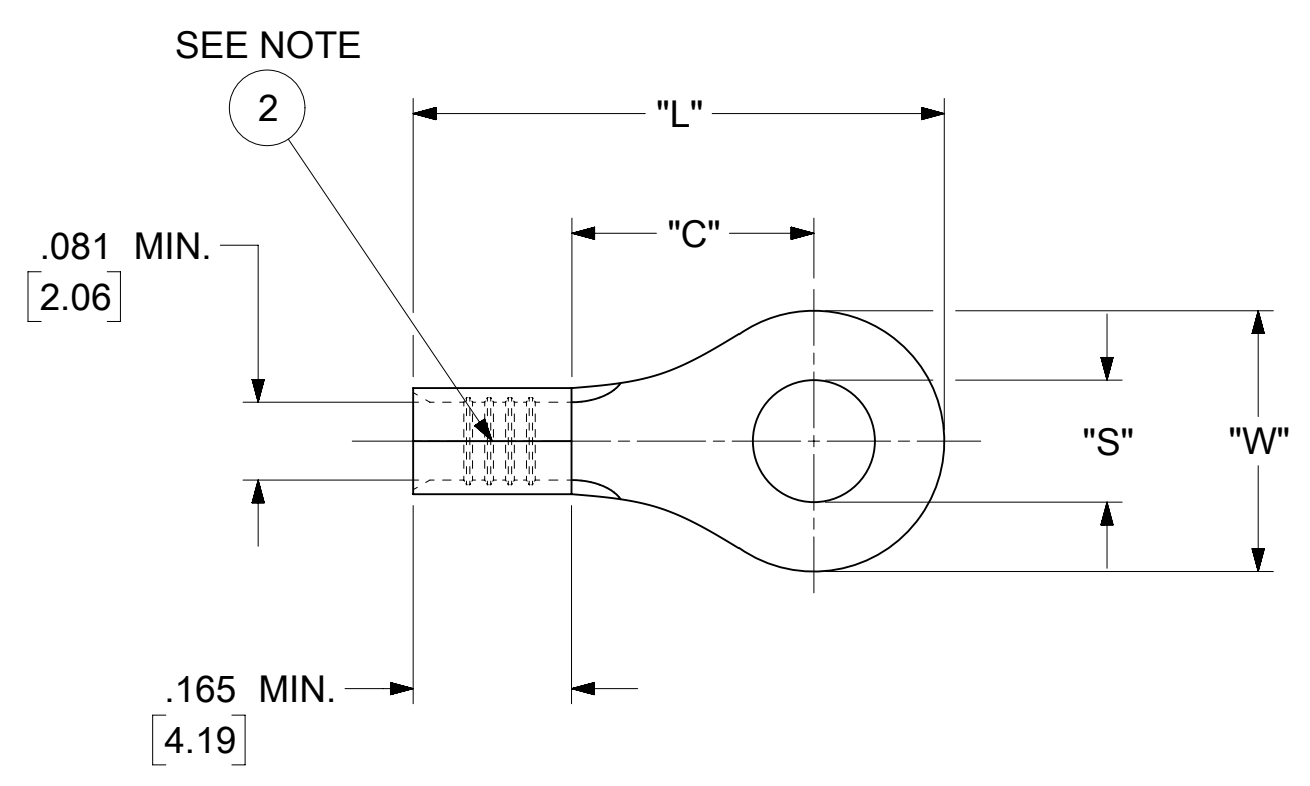

PARTS ON TAPE

NOTES:

- MATERIAL: COPPER (STOCK THICKNESS .031±.001 [0.79])
PLATING: ELECTRO-NICKEL
- BRAZED SEAM
- WIRE SIZE: 16 - 14 AWG
1.0 - 2.5 MM²
- MAX. OPERATING TEMP : 650 °F
343 °C
- "UL" LISTING #E32244
"CSA" LISTING #18689
- ALL DIMENSIONS IN INCHES/[MM].
- PARTS ARE ROHS COMPLIANT.
- DIMS. SHOWN ARE FOR REFERENCE ONLY.

SYMBOLS ▽ = 0 ▽ = 0 ▽ = 0 ▽ = 0 ▽ = 0 ▽ = 0 ▽ = 0 ▽ = 0 ▽ = 0 ▽ = 0	THIS DRAWING CONTAINS INFORMATION THAT IS PROPRIETARY TO MOLEX ELECTRONIC TECHNOLOGIES, LLC AND SHOULD NOT BE USED WITHOUT WRITTEN PERMISSION				CURRENT REV DESC: MIGRATION TO ECTR/NX				 RING TONGUE TERMINAL VERSAKRIMP 300-SERIES			
	DIMENSION UNITS		SCALE		MM		INCH					
	INCH/MM		NTS		± --- ± ---		± .005		CHK'D: GROJAS01 2019/07/29		SERIES 1990/11/14	
	GENERAL TOLERANCES (UNLESS SPECIFIED)		4 PLACES		± .13 ± .01		± .01		APPR: JMACNEIL 2019/08/05		2019/08/05	
DRAFT WHERE APPLICABLE MUST REMAIN WITHIN DIMENSIONS		3 PLACES		± .25 ± ---		± --- ± ---		INITIAL REVISION:		DRWN: EDWIN 1990/11/14		
THIRD ANGLE PROJECTION		2 PLACES		± .05 °		± .05 °		APPR: JMACNEIL 2019/08/05		SERIES 19203		
DRAWING		1 PLACE		THIRD ANGLE PROJECTION		DRAWING		C-SIZE		MATERIAL NUMBER		
SERIES		0 PLACES		DRAWING		SERIES		19203		CUSTOMER		
SHEET NUMBER		DRAFT WHERE APPLICABLE MUST REMAIN WITHIN DIMENSIONS		THIRD ANGLE PROJECTION		DRAWING		C-SIZE		SEE TABLE		
1 OF 1		DRAFT WHERE APPLICABLE MUST REMAIN WITHIN DIMENSIONS		THIRD ANGLE PROJECTION		DRAWING		C-SIZE		GENERAL MARKET		

NOTES:

① MAT'L: COPPER (STOCK TKN. $\pm .031$)
 PLATING: ELECTRO-NICKEL $\frac{.031}{.79}$

② BRAZED SEAM

STUD SIZES: ($\pm .005$)

- 02 = .094 413 = .413
- 04 = .119 209 = .209
- 06 = .146
- 08 = .173
- 10 = .198
- 14 = .265
- 56 = .328
- 38 = .390

FILE NO. BB-T-CD-301-01

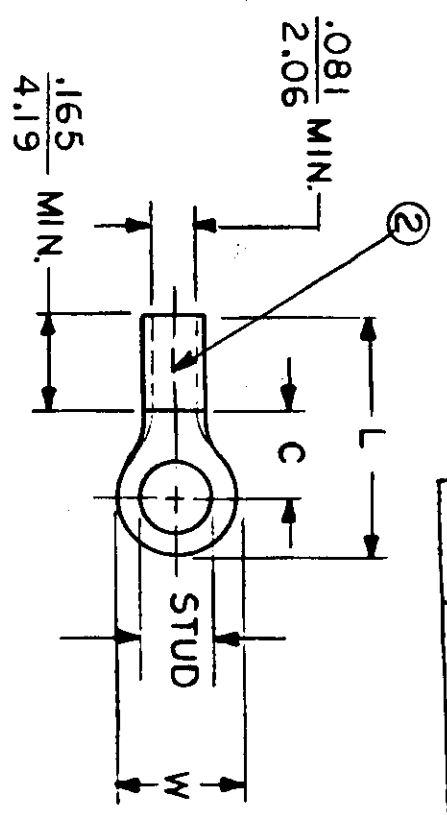

ALL DIMENSIONS = $\frac{\text{INCHES}}{\text{MM}}$

$650^{\circ} F$
 $343^{\circ} C$

WIRE SIZE: 16-14 AWG
 1.0-2.5 MM²

PART NUMBER	"W"	"C"	"L"	AVAILABLE STUD SIZES
	$\pm .010$	MIN.	MAX.	
BB-T-318-	$\frac{.534}{13.56}$	$\frac{.554}{14.07}$	$\frac{1.036}{26.31}$	10,14,56,38,413
BB-T-323-	$\frac{.250}{6.35}$	$\frac{.209}{5.31}$	$\frac{.560}{14.22}$	02,04,06,08
BB-T-325-	$\frac{.467}{11.86}$	$\frac{.388}{9.86}$	$\frac{.837}{21.26}$	10,14,56
BB-T-337-	$\frac{.312}{7.92}$	$\frac{.285}{7.24}$	$\frac{.645}{16.38}$	04,06,08,10 $\frac{1}{4}$ 209
BB-T-339-	$\frac{.342}{8.69}$	$\frac{.310}{7.87}$	$\frac{.696}{17.68}$	04,06,08,10

DIMENSIONAL TOLERANCES UNLESS OTHERWISE SPECIFIED		REFERENCE	SCALE: NTS	DATE	TITLE: $650^{\circ} F$ TEMP-TERMS RING TONGUE TERMINAL VERSAKRIMP 300-SERIES
FRAC.	DEC.	ANG.	CHKD. BY:	APPRD. BY:	DWG. NO. A CUSTOMER DWG.
\pm	\pm	\pm	EDENH	11-14-90	

