

SPECIFICATION

Mating Cycles	500
Filter type	C
Capacitance	3900pf ± 20%
Working Voltage	100v
Current Rating	7.5A
Insulation Resistance	>1GΩ

FREQUENCY (MHz)	ATTENUATION dB
5	6dB
10	11dB
50	25dB
100	35dB
500	35dB
1000	32dB

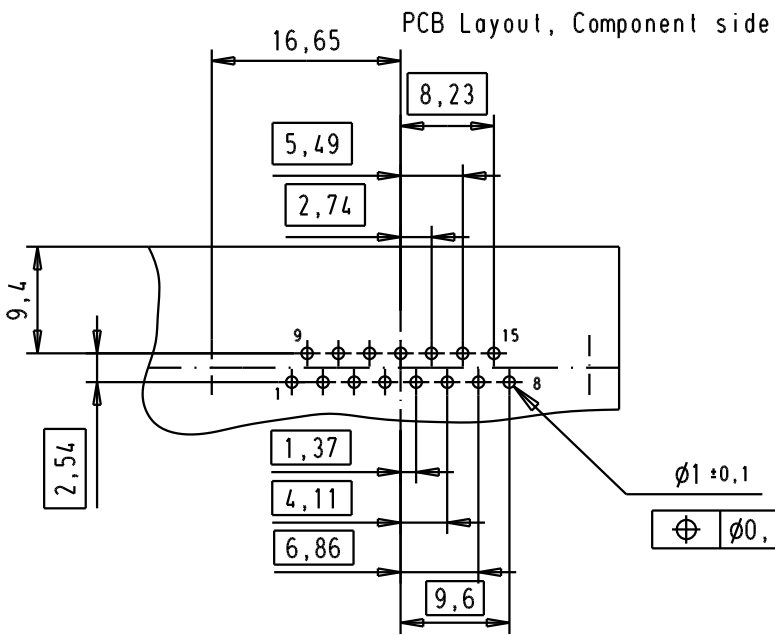
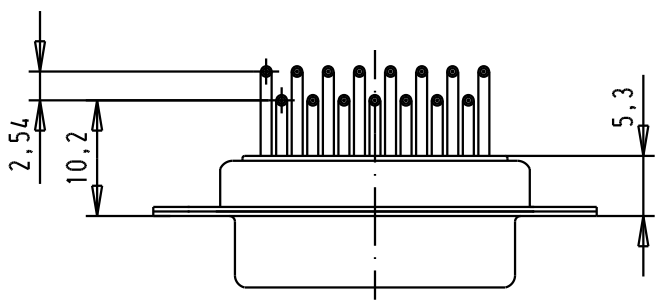

				Dat.	Name	<p>All Dim. in mm Orig. Size DIN A 4</p>	
			Detail.	8 - JUL - 02	CV		
			Insp.				
			Stand.				
33262	15/11/05	JMDR	HARTING EURL F-95972 Paris				
31058	8 - JUL - 02	CV					
Mod.	Dat.	Name					

Dsub, female, angled,  
15 poles, turned solder pins,  
tin plated shell with holes

TB 09642147240

Mo?MsLab/  
Scale  
1.5:1

Bla1/ Page  
1 / 1