



11565.1

STL 950/6/5,00-H GN

---

## Technical data

---

### Dimensions

---

|                            |        |
|----------------------------|--------|
| Length                     | 12 mm  |
| Length of the pin          | 3.5 mm |
| Width                      | 30 mm  |
| Width left                 | 2.5 mm |
| Width right                | 2.5 mm |
| Height                     | 8.4 mm |
| Drill hole diameter        | 1.4 mm |
| Diameter of connecting pin | 1 mm   |
| Pitch                      | 5 mm   |

### Ratings

---

|                       |       |
|-----------------------|-------|
| Rated voltage         | 250 V |
| Rated current         | 12 A  |
| Rated impulse voltage | 4 kV  |
| Overvoltage category  | III   |
| Contamination degree  | 3     |

### Connection data

---

|                        |                      |
|------------------------|----------------------|
| Angle of PCB/contact   | 0°/180° (horizontal) |
| Number of plug-in rows | 1                    |
| No. of poles           | 6                    |

### Materials

---

|                           |               |
|---------------------------|---------------|
| Insulation housing        | Polyamide 6.6 |
| Flammability class UL 94  | V-0           |
| Working temperature, min. | -30 °C        |
| Working temperature, max. | 105 °C        |
| Contact pin               | Copper alloy  |

11565.1

STL 950/6/5,00-H GN

---

## Technical data

---

### Further technical data

---

|   |                             |
|---|-----------------------------|
| Storage temperature, min.                 | -40 °C                      |
| Storage temperature, max.                 | 105 °C                      |
| Insulation resistance                     | 1*10 <sup>13</sup> Ohm x cm |
| Creepage-current resistance               | CTI 600                     |
| Glow wire flammability index GWFI         | GWFI 850                    |
| GWFI after-glow time                      | 30 Sek.                     |
| Glow wire ignition temperature GWIT       | GWIT 775 °C                 |
| GWIT exposure time                        | 5 Sek.                      |
| Plug-in cycles acc. to standard           | 100                         |
| Recommended wave soldering temperature    | 265 °C                      |
| Recommended wave soldering duration, min. | 3 Sek.                      |
| Recommended wave soldering duration, max. | 4 Sek.                      |

---

### Print

---

|        |       |
|--------|-------|
| Colour | Green |
|--------|-------|

---

### Environmental Product Compliance

---

|                                |            |
|--------------------------------|------------|
| REACH Conform                  | Yes, yes   |
| REACH Reference date           | 2021-07-08 |
| REACH Candidate Substance Note | No         |
| RoHS Conform                   | Yes, yes   |

---

### Approvals

#### Standards and regulations

|                               |                 |
|-------------------------------|-----------------|
| cUL approval                  | CSA 22.2 No.158 |
| cUL Usegroup B: rated voltage | 300 V           |
| cUL Usegroup B: rated current | 15 A            |
| cUL Usegroup C: rated voltage | 150 V           |
| cUL Usegroup C: rated current | 15 A            |
| cUL Usegroup D: rated voltage | 300 V           |
| cUL Usegroup D: rated current | 10 A            |
| cUL wire material             | Cu              |
| UL approval                   | UL 1059         |
| UL Usegroup B: rated voltage  | 300 V           |
| UL Usegroup B: rated current  | 15 A            |
| UL Usegroup C: rated voltage  | 150 V           |
| UL Usegroup C: rated current  | 15 A            |
| UL Usegroup D: rated voltage  | 300 V           |
| UL Usegroup D: rated current  | 10 A            |
| UL wire material              | Cu              |
| UL factory wiring             | yes             |
| UL Recognized                 | yes             |
| cUL Recognized                | yes             |

#### VDE approval

|                           |              |
|---------------------------|--------------|
| VDE approval              | DIN EN 61984 |
| VDE approval granted      | yes          |
| VDE rated voltage         | 250 V        |
| VDE rated current         | 12 A         |
| VDE rated impulse voltage | 4 kV         |
| VDE overvoltage category  | III          |
| VDE contamination degree  | 3            |

11565.1

STL 950/6/5,00-H GN

## Media

**CRA<sup>®</sup> US**

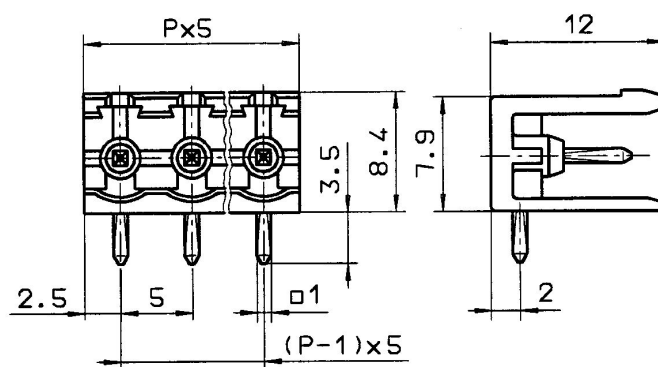
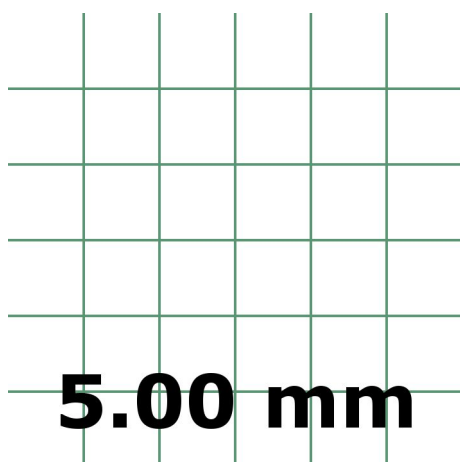

11565.1

STL 950/6/5,00-H GN

---

## Accessories

---