

LOC		DIST		REVISIONS			
P	LTR	DESCRIPTION	DATE	DN	APVD		
H		REVISED PER ECR-20-000808	22MAY2020	PC	SW		

- MATERIAL: CONNECTOR- NYLON UL94V-2 (RED).
 CONTACTS- 0.30 [.012] THK COPPER ALLOY
 (BRIGHT TIN-LEAD 0.00203 [.000080] MIN THK).
 (MATTE TIN 0.00203 [.000080] MIN THK).
- CONTACTS ACCEPT #22 AWG SOLID, FUSED STRANDED OR STRANDED (7 STRANDS) WIRE WITH 2.41 [.095] MAX INSULATION DIA.
- BOW, IN ANY DIRECTION, NOT TO EXCEED 0.15 [.006] PER IN.
- HOUSING FEATURES: FEED-THRU.
- DIMENSIONS IN BRACKETS ARE IN INCHES.
- △6 OBSOLETE PARTS: OBSOLETE CIS STREAMLINING PER D.RENAUD/D.SINISI
- △7 OBSOLETE PARTS

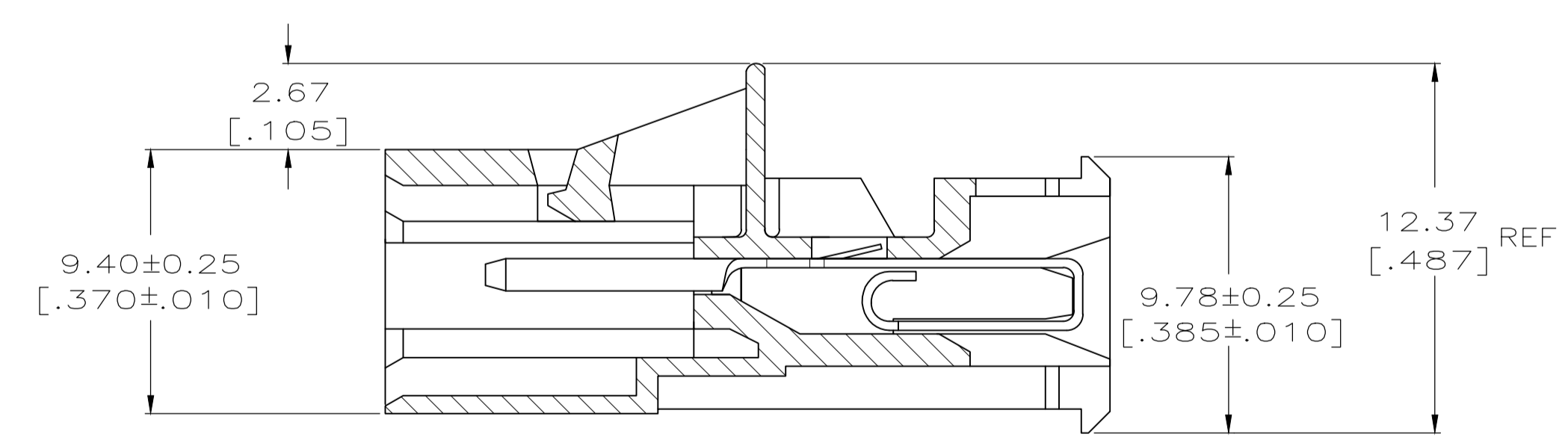
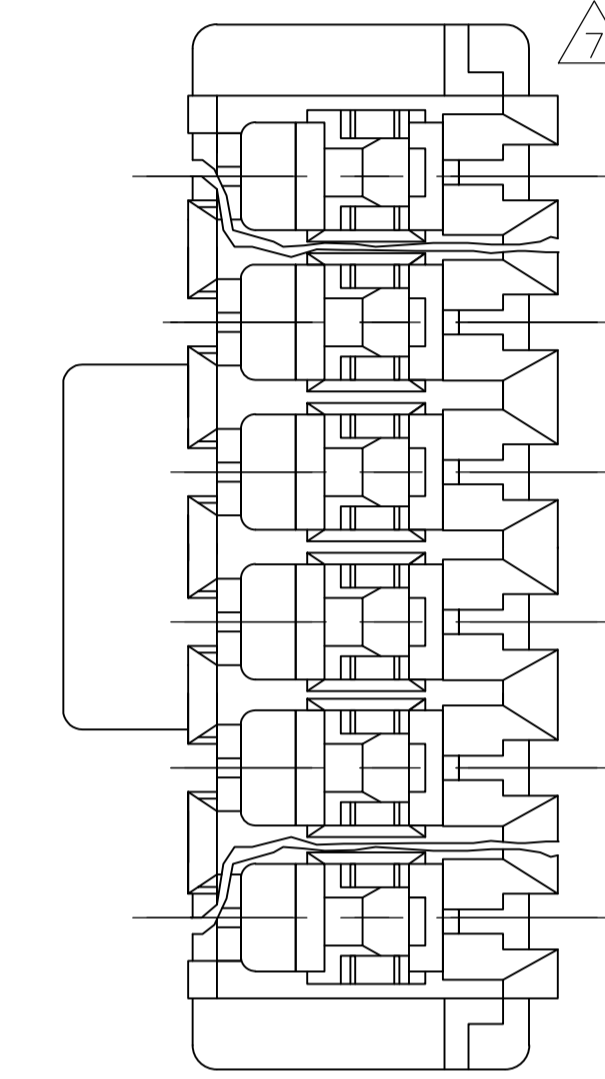
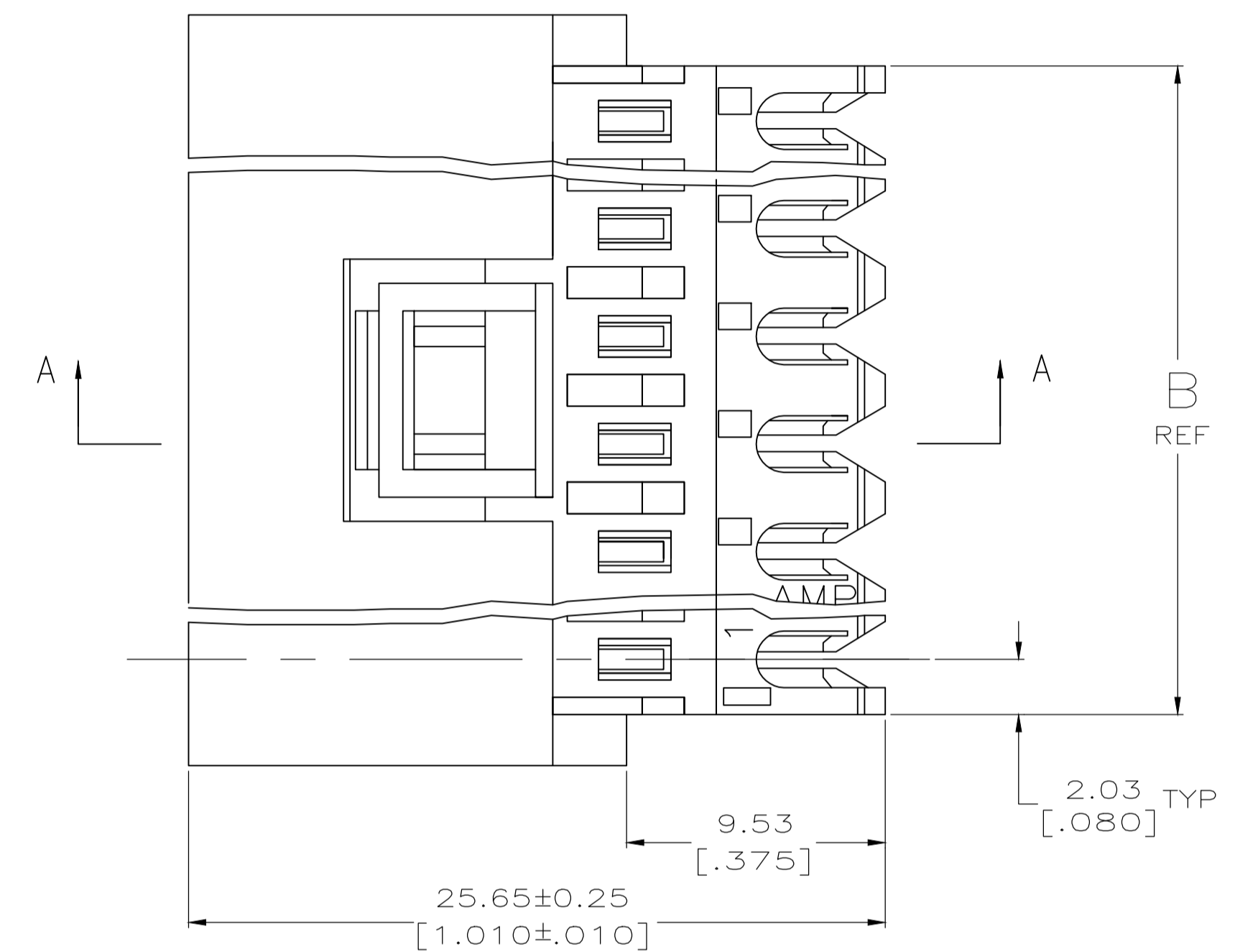
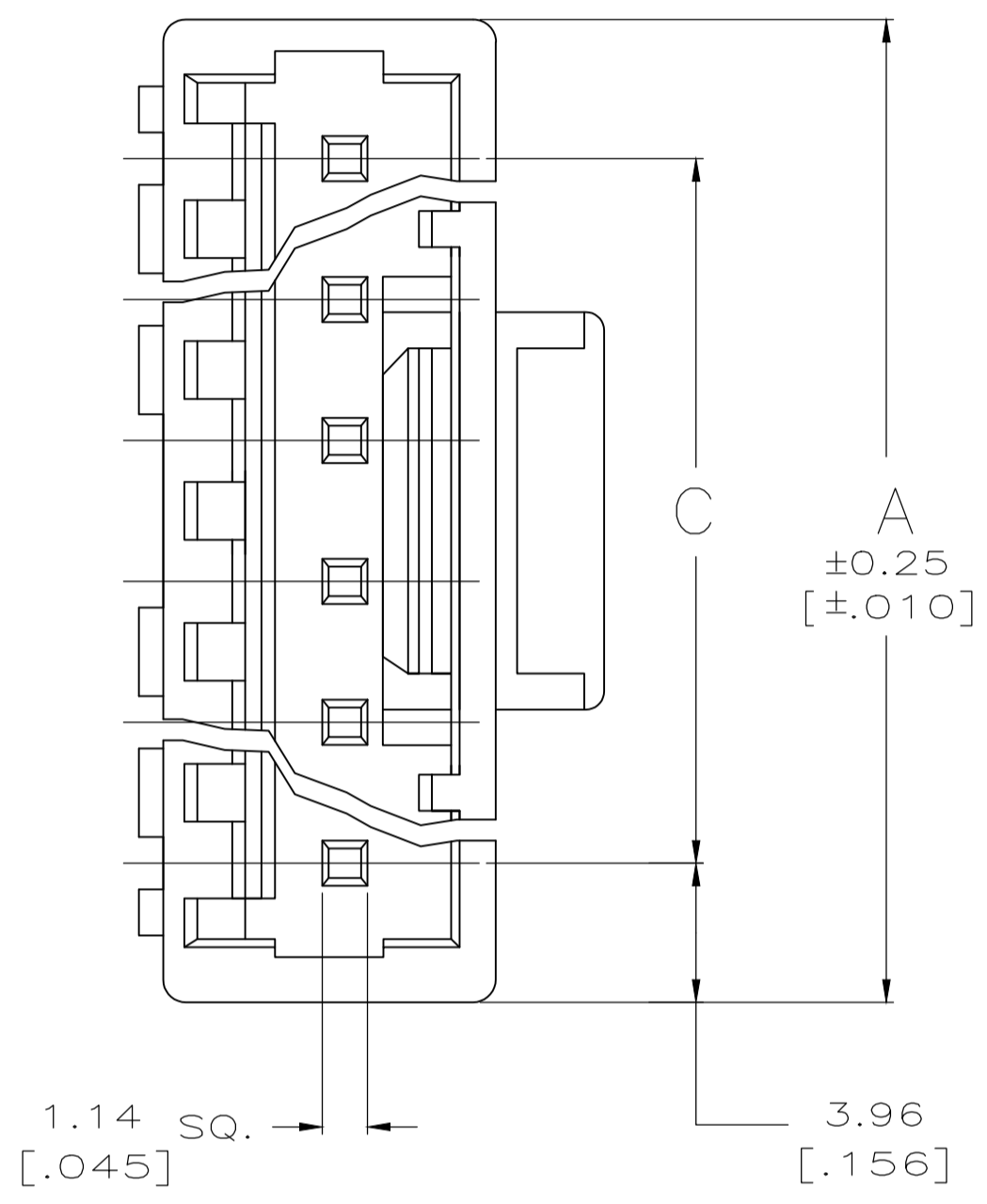

SECTION A-A

FINISH	C	B	A	NO. OF CIRCUITS	PART NO.	
TIN	91.14 [3.588]	95.20 [3.748]	99.06 [3.900]	24	5-641524-4	
	55.47 [2.184]	59.54 [2.344]	63.40 [2.496]	15	4-641524-5	
	43.59 [1.716]	47.65 [1.876]	51.51 [2.028]	12	4-641524-2	
	31.70 [1.248]	35.76 [1.408]	39.62 [1.560]	9	3-641524-9	
	19.81 [.780]	23.88 [.940]	27.74 [1.092]	6	3-641524-6	
	11.89 [.468]	15.95 [.628]	19.81 [.780]	4	3-641524-4	
	7.92 [.312]	11.99 [.472]	15.85 [.624]	3	3-641524-3	
	3.96 [.156]	8.03 [.316]	11.89 [.468]	2	3-641524-2	
	TIN-LEAD	91.14 [3.588]	95.20 [3.748]	99.06 [3.900]	24	2-641524-4
		55.47 [2.184]	59.54 [2.344]	63.40 [2.496]	15	1-641524-5
43.59 [1.716]		47.65 [1.876]	51.51 [2.028]	12	1-641524-2	
31.70 [1.248]		35.76 [1.408]	39.62 [1.560]	9	641524-9	
19.81 [.780]		23.88 [.940]	27.74 [1.092]	6	641524-6	
11.89 [.468]		15.95 [.628]	19.81 [.780]	4	641524-4	
7.92 [.312]		11.99 [.472]	15.85 [.624]	3	641524-3	
3.96 [.156]		8.03 [.316]	11.89 [.468]	2	641524-2	
SUPERSEDED		91.14 [3.588]	95.20 [3.748]	99.06 [3.900]	24	2-641524-4
		55.47 [2.184]	59.54 [2.344]	63.40 [2.496]	15	1-641524-5

THIS DRAWING IS A CONTROLLED DOCUMENT.

DIMENSIONS: mm [INCHES]	TOLERANCES UNLESS OTHERWISE SPECIFIED:	DIN J. HUFFMAN 6-26-95	APVD R. SWING 6-26-95	NAME	MTA-156
0 PLC ± -	1 PLC ± -	2 PLC ± 0.13 [.005]	3 PLC ± -	4 PLC ± -	ANGLES ± -
MATERIAL SEE NOTE 1	FINISH SEE NOTE 1	WEIGHT	SCALE 5:1	SHEET 1 OF 1	REV H

CUSTOMER DRAWING