

REVISIONS				
REV	ECO	DESCRIPTION	DATE	BY APPR
A1	-	FIRST RELEASE	21-Nov-14	Tod TOMMY

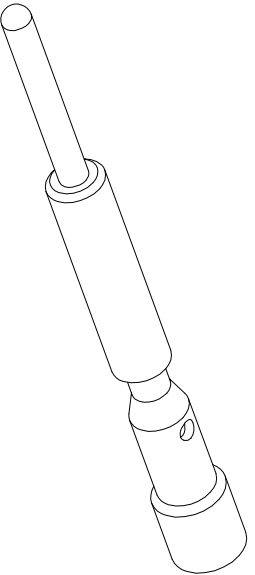
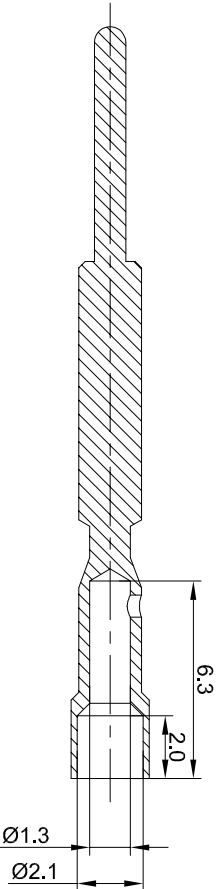
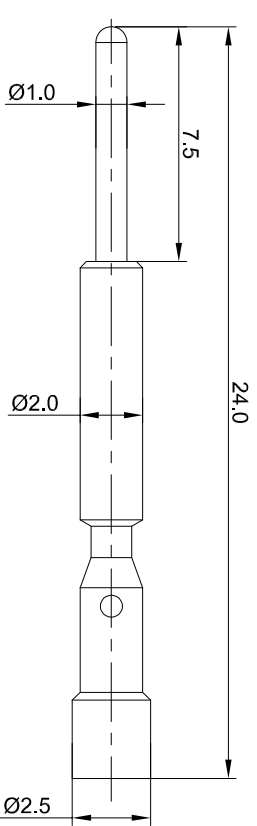

- NOTES: UNLESS OTHERWISE SPECIFIED
- MATERIAL: COPPER ALLOY, GOLD PLATED
 - SPECIFICATIONS:
 - RATED CURRENT: 7 AMPS
 - CONTACT RESISTANCE: <5 milliohm
 - AVAILABLE WIRE RANGE: 18-22AWG
 - ROHS COMPLIANT
 - ALL DIMENSIONS ARE FOR REFERENCE USE ONLY.

QUANTITY	SEE PART NUMBER CHART	PART NUMBER	DESCRIPTION	ITEM
MATERIALS LIST				
UNLESS OTHERWISE SPECIFIED				
1) All dimensions are in millimeters.				
2) Tolerances are as follows:				
1 Pt. DEC 20.30 Fractions .1754				
3 Pt. DEC 20.08 Angles .1°				
3) Note reference =				
MATERIAL SPECIFICATIONS:		CUSTOMER:		
PROCESS SPECIFICATIONS:		THIS DRAWING IS SUPERSEDED BY THE LATEST REVISIONS. SPECIFICATIONS AND PERFORMANCE DATA ARE THE PROPERTY OF AMPHENOL CORPORATION. NO PARTS OF REPRODUCTION ARE PERMITTED. ALL MANUFACTURING VARIATIONS NORMAL.		
NEXT ASST:		SCALE: 8 : 1		
SIGNATURES		DATE		
DRAWN: Tod		21-Nov-14		
CHECKED:				
ENGINEER:				
APPROVAL:				
CUSTOMER:		Pin, 1.0mm, Ctmp 18-22AGW		
SHEETS		REVISION		
8 : 1		B C- SC000338 A1		

Amphenol

Site Systems - www.amphenol-site.com
44724 Morley Drive
Clinton Township, MI 48036

Pin, 1.0mm, Ctmp 18-22AGW

SCALE: 8 : 1

SHEETS 1 OF 1

TITLE:

Pin, 1.0mm, Ctmp 18-22AGW

DWG NO: SC000338

REV: A1

SH: 1

OF: 1