

1 Products affected

Product hierarchy no. *			Part no.	SBU	Type / Description	Customer part no.
SBU PG	PGU	Type				
02	005	116	0000001168	See list below	Power Entry Modules w/o Filters	DD21

*SBU (2-digit) / PG (3-digit) / PGU (3-digit) / Type (10-digit)

List of part numbers affected					
DD21.0111.1111	DD21.0113.1111	DD21.0114.1111	DD21.0121.1111	DD21.0123.1111	DD21.0124.1111
DD21.0121.1110					

2 Type of change

Enlarging of the fusedrawer slot.

3 Detailed description of change

Fusedrawer slot enlarged.

New

Old

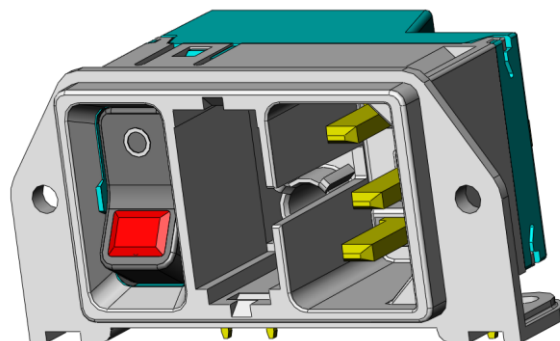
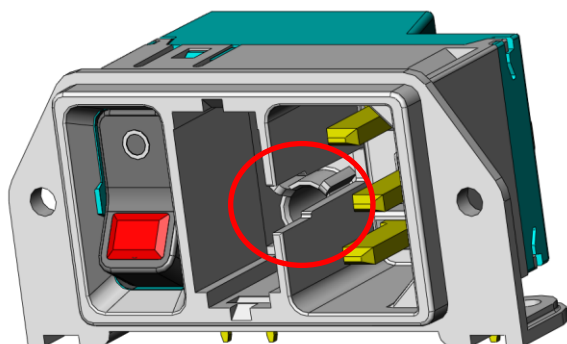

DD21					0118.2187	
creation date	created by	release date	released by	notification no.	revision	page
2013-10-04	hollenpe	2013-12-04	hollenpe	25286	-	1 of 2

4 Reason of change

Implementation of V-Lock cord retention function.
Precondition: new fusedrawer required (see PCN 0118.2133).

5 Released date

The change will be rolled-out individually by all part numbers affected starting ww 02/2014 and last approx. 9 months.

6 Impact of change and recommended action

Form: New form is fully backwards compatible (can be used with old fusedrawer, see PCN 0118.2133).
Fit: n/a
Function: The new expanded slot allows applying V-Lock cord sets for cord retaining (new fuse drawer necessary).
Production Site: n/a
Product Label: n/a

7 Reference Documents / Attachments

Kind of document	Document number	Remarks
PCN fusedrawer 2	0118.2133	
Data sheet Fusedrawer 2		
Data sheet DD21		

DD21					0118.2187	
creation date	created by	release date	released by	notification no.	revision	page
2013-10-04	hollenpe	2013-12-04	hollenpe	25286	-	2 of 2