

RECOMMENDED PCB LAYOUT (COMPONENT SIDE VIEW)
 EMPFOHLENES LEITERPLATTEN-LAYOUT (BESTUECKUNGSSEITE)
 TOL. ±0.05 [0.002] UNLESS NOTED

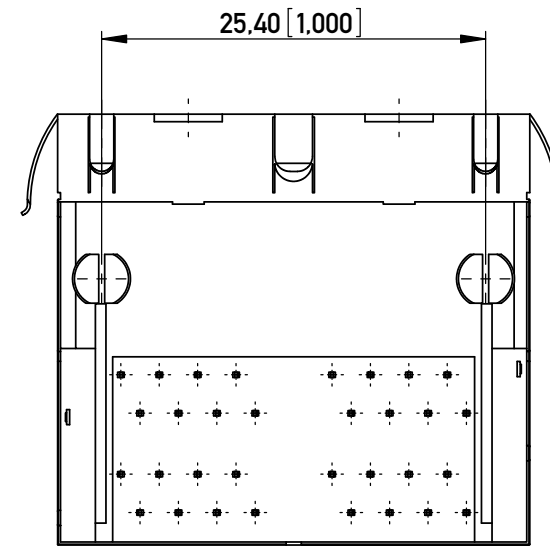

RECOMMENDED PANEL CUTOUT
 EMPFOHLENER FRONTPLATTEN-AUSSCHNITT

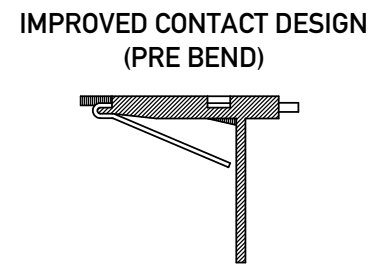
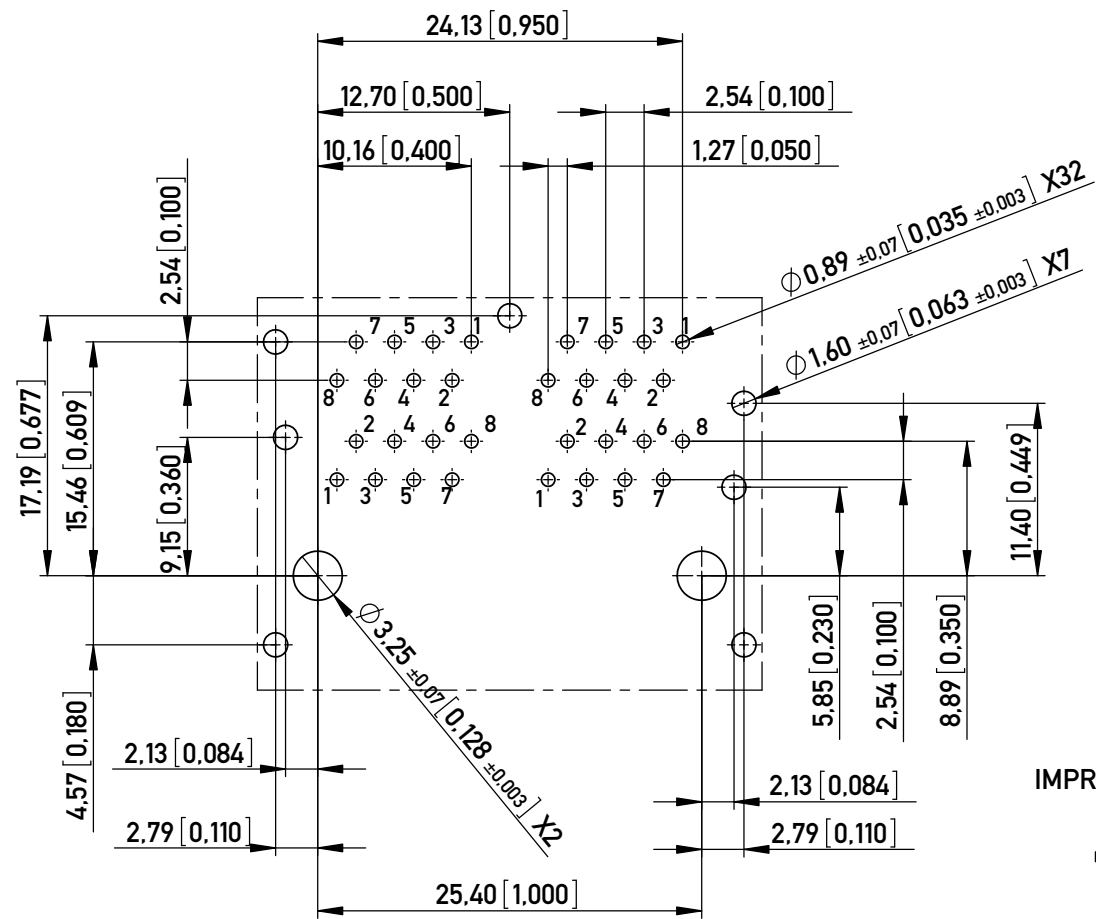
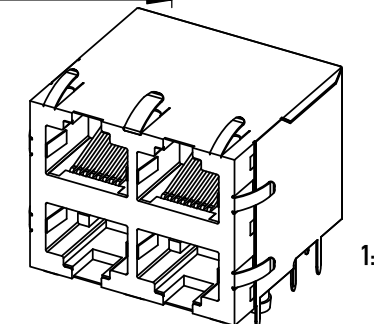
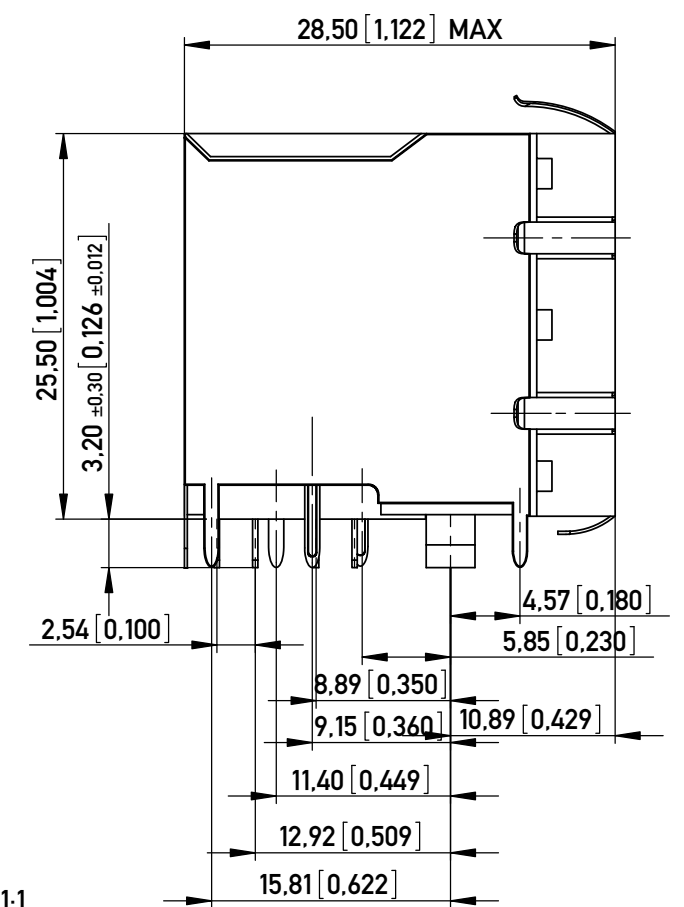
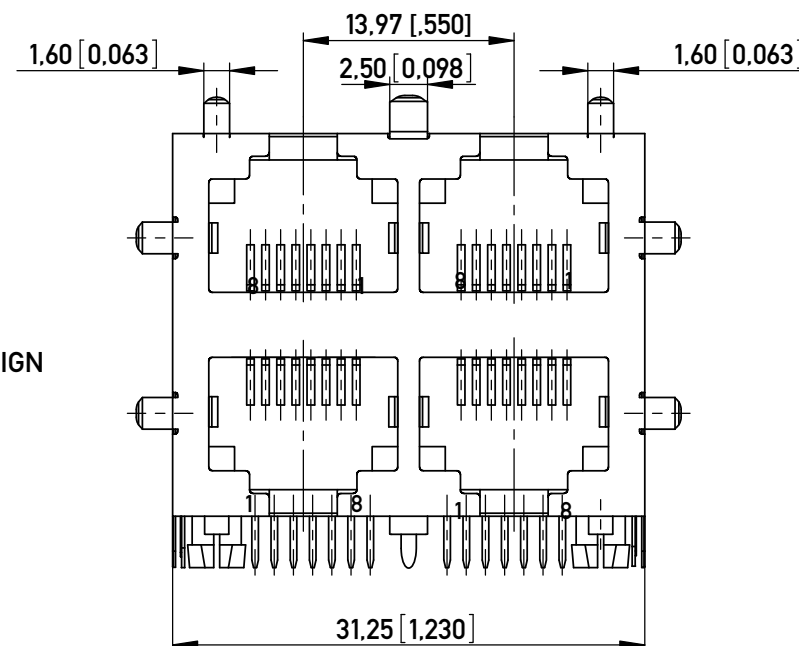
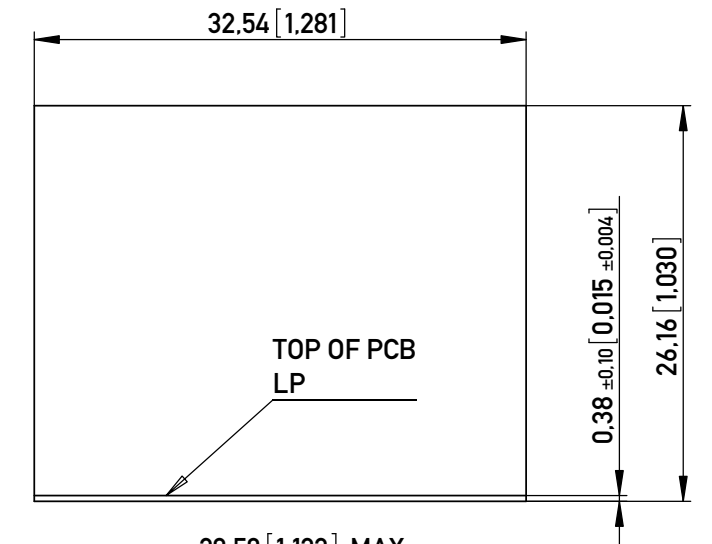

Technical specifications

Materials & Finish	Standard applic.	Value
Insulation body	Standard description	PBT 30%
Contact material	Standard description	C5210 (acc.JIS)
Contact finish, mating zone	Thickness of plating	30 µm Au over 50 µm Ni
Contact finish termination zone	Thickness of plating	80 µm matte Sn over 50 µm Ni
Shell/shield material	Standard description	SUS301 (acc.JIS)
Plating shield / shielding pin		80 µm Ni / 80 µm Sn

Assembly process

Packaging	Tray
Solder temperature	235°C at 3-5s
Suitable assembly process	wave

Approvals

UL insulation body	UL 94	V0
UL File No.		E145613
RoHS compliant		Yes

Test Data

Mechanical properties	Standard applic.	Value
Insertion/withdrawal force	IEC 603-7	max. 20 N
Mechanical operations	IEC 512-5. 9a	min. 1.000
Effectiveness of connector coupling device	IEC 512-8. 15f	50 N

Electrical properties

Creepage / clearance distances	Standard applic.	Value
a) Contact - contact	IEC 807-3	0.52 mm
b) Contact - shell	IEC 807-3	min. 1.0 mm
Voltage proof (Dielectric Withstand Voltage)		
a) Contact - contact	IEC 512-2. 4a	min. 1.000 V AC/DC
b) Contact - shell/testpanel	IEC 512-2. 4a	min. 1.500 V AC/DC
Current carrying capacity	IEC 512-3. 5b	1,5 A @ 25° C
Contact resistance	IEC 512-2. 2a	max. 30 mOhm
Insulation resistance	IEC 512-2. 3a	min. 500 MOhm

Environmental properties

Operation temperature	0 - 70° C
-----------------------	-----------

NOTE 1: PANEL GROUND FLANGES TOP, BOTTOM, SIDES (GF9)
 NOTE 2: RoHS COMPLIANT

Information:	Tolerances Fraction Decimals Angles X ±0.50 ±1° XX ±0.25 XXX ±0.25 XXXX ±0.10	Scale 2:1
All rights reserved. Only for Information. To ensure that this is the latest version of this drawing, please contact one of the ERNI companies before using.	Subject to modification without prior notice. Drawing will not be updated.	Designation MOD JACK -MJD 8P8C, 2X2
www.ERNI.com	133041	I (1/1) A3
d 23.09.2014	Date	Class MJ

Copyright by ERNI GmbH
 Proprietary notice pursuant to ISO 16016 to be observed.