

REVISIONS					
P	LTR	DESCRIPTION	DATE	DWN	APVD
F5		REVISED PER ECR-23-176608	29MAY2023	BB	DSC

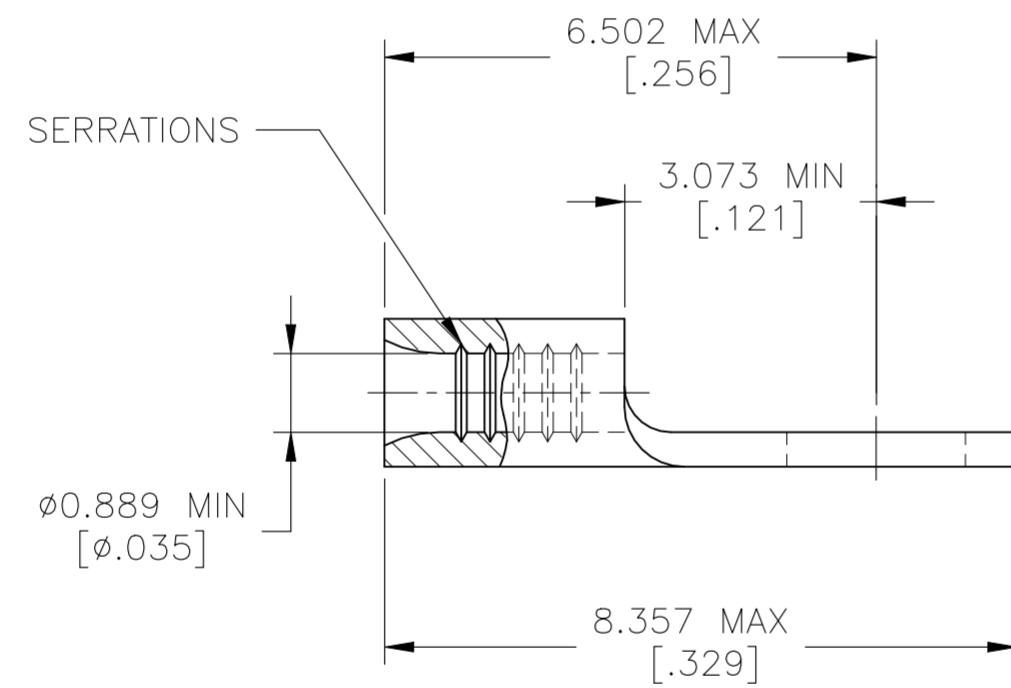
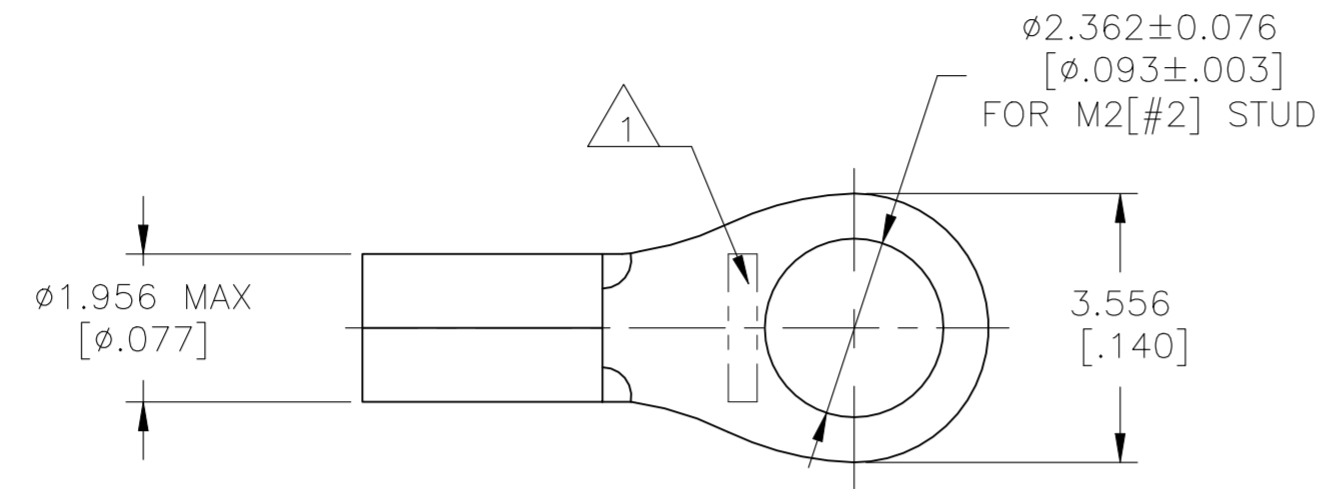

- 1 STAMP AMP APPROX AS SHOWN
- 2 TIN PLATE 0.00254 [0.000100] MIN EXT THK PER ASTM B545
- 3 NICKEL PLATE 0.00762 [0.000300] MIN EXT THK PER SAE AMS-QQ-N-290
- 4 MATERIAL: COPPER PER ASTM B152, ANNEALED
- 5 NOTE DELETED
- 6 NOTE DELETED
- 7 BODY MATERIAL THK: 0.457±0.051 [0.018±.002]

343°C [650°F]	1000	3	LOOSE PIECE	2-31425-3
170°C [338°F]	5000	2	ON TAPE	2-31425-2
170°C [338°F]	1000	2	LOOSE PIECE	31425
MAX TEMP	QTY	FINISH	PACKAGING	PART NO
THIS DRAWING IS A CONTROLLED DOCUMENT.		DWN TA BRINKMAN 2-2-93	TE Connectivity NAME TERMINAL, RING TONGUE, BUDGET WIRE SIZE: 26-22 AWG	
DIMENSIONS: mm [INCHES]		CHK DA PATTERSON 2-2-93		
TOLERANCES UNLESS OTHERWISE SPECIFIED:		APVD DA PATTERSON 2-2-93		
0 PLC ± - 1 PLC ± - 2 PLC ± - 3 PLC ± 0.127[.005] 4 PLC ± - ANGLES ± -		PRODUCT SPEC		
MATERIAL	FINISH	WEIGHT	SIZE	CAGE CODE
4	SEE TABLE		A2	00779
CUSTOMER DRAWING			DRAWING NO	RESTRICTED TO
			C=31425	-
			SCALE 10:1	SHEET 1 OF 1
			REV F5	

AMP INCORPORATED CUSTOMER SERVICE SYSTEMS		MAX RECOMMENDED OPERATING TEMPERATURE: SEE TABLE
FOR ADDITIONAL PRODUCT INFORMATION OR COPIES OF DRAWINGS AND TECHNICAL DOCUMENTS	PRODUCT INFORMATION CENTER 1-800-522-6752	VOLTAGE RATING: N/A
FOR APPLICATION TOOLING INFORMATION	TOOLING ASSISTANCE CENTER 1-800-722-1111	CIRCULAR MIL AREA: 0.1-0.41mm <sup>2</sup> [202-810] STRANDED
FOR ORDER ENTRY	1-800-526-5142	THIS DRAWING IS A CONTROLLED DOCUMENT FOR AMP INCORPORATED. IT IS SUBJECT TO CHANGE AND THE CONTROLLING ENGINEERING ORGANIZATION SHOULD BE CONTACTED FOR THE LATEST REVISION.