

| REVISIONS | | | | | |
|-----------|-----|------------------|----------|----|------|
| REV | ECO | DESCRIPTION | DATE | BY | APPR |
| A1 | - | RELEASED DRAWING | 9/1/2021 | RO | RO |

ASSEMBLED VIEW

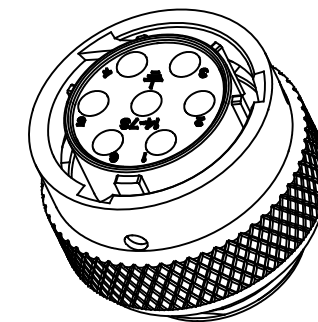
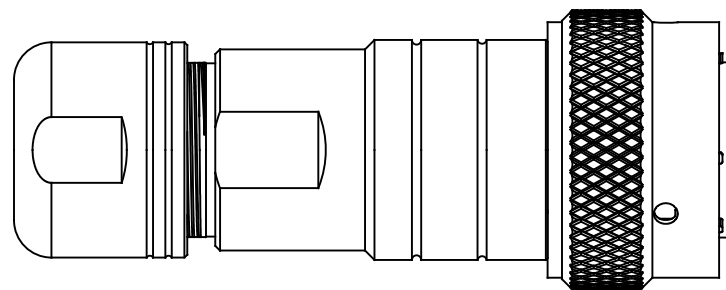
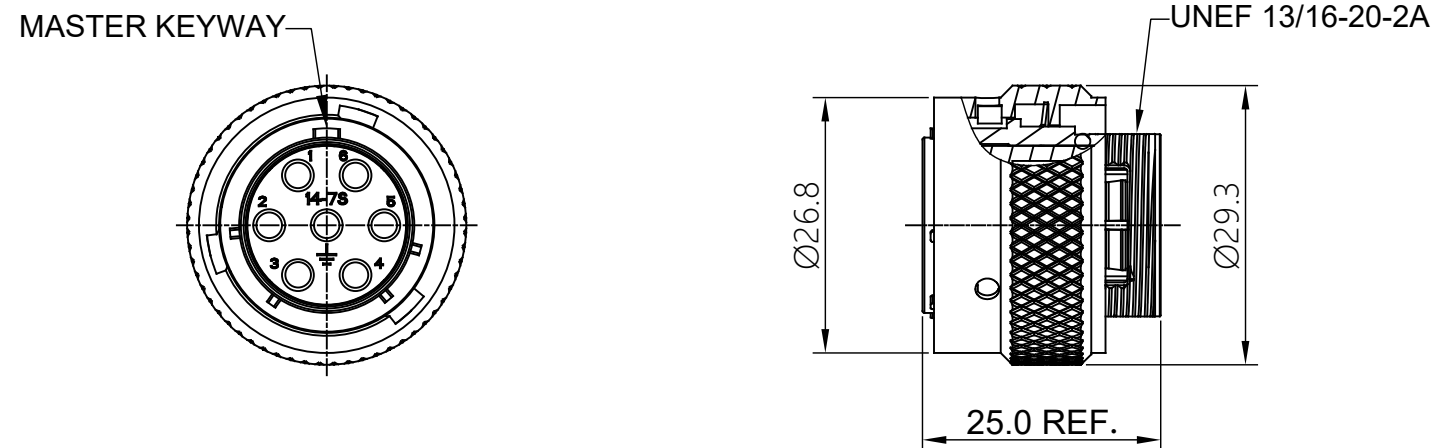
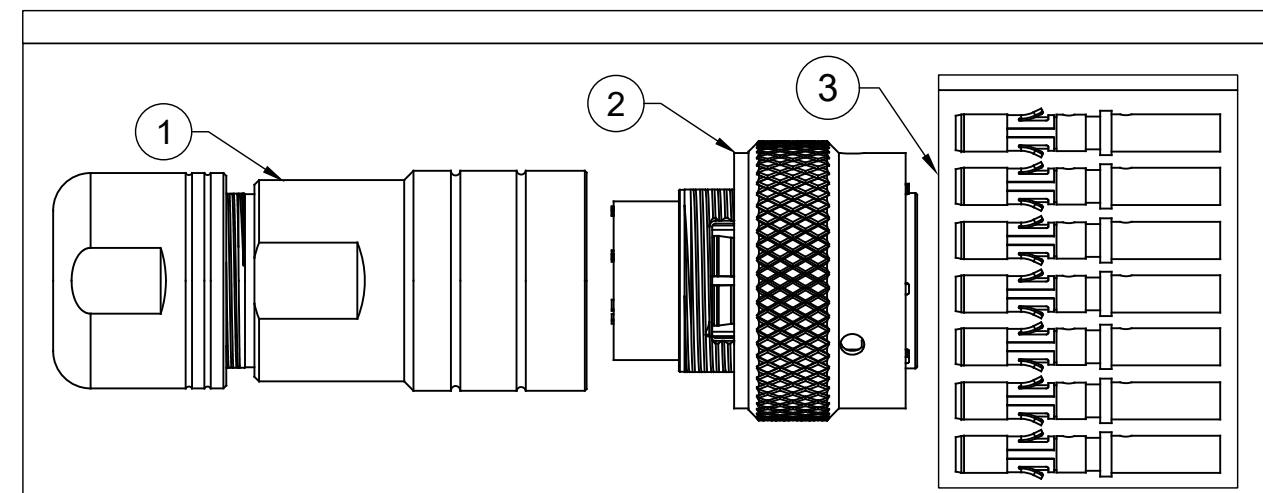

ILLUSTRATION: COMPLETE KIT



NOTES: (UNLESS OTHERWISE SPECIFIED)

- MATERIAL:
 - SHELL: ZINC ALLOY, NICKEL PLATED.
 - INSERT: THERMOPLASTIC, UL94 V-0.
 - COUPLING NUT: AL ALLOY, NICKEL PLATED.
 - O-RING: NBR/SILICONE RUBBER.
 - WAVE WASHER: STAINLESS STEEL.
- SPECIFICATIONS:
 - 2.1 RATED CURRENT: 13A (MAX).
 - 2.2 RATED VOLTAGE: 500V (AC/DC).
 - 2.3 OPERATING TEMPERATURE: -40C TO +105C.
 - 2.4 DIELECTRIC WITHSTANDING VOLTAGE: LESS THAN 2 MILLIAMPS CURRENT LEAKAGE@2000 VOLTS AC.
 - 2.5 INSULATION RESISTANCE: 5000 MEGOHMS MIN.
 - 2.6 IP--CLASS: IP67 (IN MATED CONDITION).
 - 2.7 MATING CYCLES DURABILITY: 500 CYCLES MIN.
 - 2.8 RoHS COMPLIANT.
- SUITABLE CONTACTS : 16# CONTACTS.
- ALL DIMENSIONS ARE FOR REFERENCE USE ONLY.

| QUANTITY | PART NUMBER | DESCRIPTION | ITEM |
|----------|---------------|-----------------------------|------|
| 7 | MS16M23F | SKT,SIZE16,16-18AWG,GOLD | 3 |
| 1 | RT06147SNH | PLUG,FEMALE,14-7 | 2 |
| 1 | RT0L-14CG-NS1 | CORD GRIP,SHELL 14,6.5-10MM | 1 |

| MATERIALS LIST | | | |
|--|------|--|--------------|
| UNLESS OTHERWISE SPECIFIED 1) All dimensions are in metric(mm). 2) Tolerances are as follows: 1 PL DEC ±0.30 2 PL DEC ±0.15 3 PL DEC ±0.08 3) Note reference = | | SIGNATURES | DATE |
| MATERIAL SPECIFICATIONS: | | DRAWN: RO | 9/1/2021 |
| PROCESS SPECIFICATIONS: | | CHECKED: RO | 9/1/2021 |
| NEXT ASSY: | | ENGINEER: RO | |
| | | APPROVAL: RO | 9/1/2021 |
| | | CUSTOMER: | |
| | | THIS DRAWING IS SUPPLIED FOR INFORMATION ONLY. DESIGN FEATURES, SPECIFICATIONS AND PERFORMANCE DATA SHOWN HEREON ARE THE PROPERTY OF THE AMPHENOL CORPORATION. NO RIGHTS OF REPRODUCTION ARE IMPLIED. ALL DIMENSIONS ARE SUBJECT TO NORMAL MANUFACTURING VARIATIONS. | |
| SIZE | TYPE | DWG NO. | REVISION |
| B | C- | RT06147SNH-K | A1 |
| SCALE: | NONE | RT06147SNH-K | SHEET 1 OF 1 |

TITLE: ECO-MATE KIT, PLUG, SIZE 14, 7POS, SOCKET. DWG NO.: RT06147SNH-K REV: A1 SH: 1 OF: 1