

General EMI Filter with High Attenuation Performance

Dual-Stage Performance EMI Filter AMI-27 Series



- Rated current from 1 to 36 A
- Dual-stage filter
- High differential mode performance
- Optional medical version (Type B)
- Optional safety version (Type A)

Approvals:



Technical Specifications

Maximum continuous operating voltage: 250VAC, 50/60Hz

Operating frequency: DC to 400Hz

Rated currents: 1 to 36A @ 40°C max.

High potential test voltage: L → PE 3000VDC for 2 sec (standard types)

L → PE 3500VDC for 2 sec (B types)

L → N 1100VDC for 2 sec

Temperature range (operation and storage): -25°C to +100°C (25/100/21)

Design corresponding to: UL 1283.

CIRCUIT DIAGRAM:

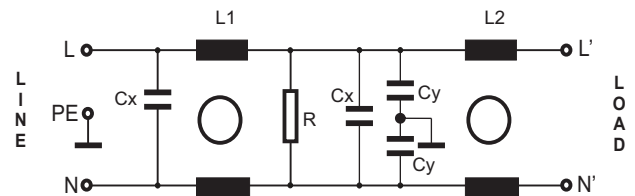

Features and Benefits

- AMI-27 dual-stage filters are designed for easy and fast chassis mounting.
- The AMI-27 filters are also available as B versions with no Y-capacitors for medical applications as well as A versions with low capacitance for safety critical applications with requirements for low leakage currents.
- All filters provide a general purpose conducted attenuation performance, based on chokes with high saturation resistance and excellent thermal behavior.
- The AMI-27 filter can be used to cover a broad range of uses and they offer a good size/amperage ratio.
- AMI-27 filters are also available as single stage filters (AMI-22 series).
- Various terminal options allow you to select the desired connection style.

Typical Applications

- Consumer electronics
- Computing & accessories
- Residential appliances
- Medical accessories
- Electronic data processing equipment
- Office automation equipment
- Industrial applications
- Machinery
- Various noisy application requires good attenuation performance filter

General EMI Filter with High Attenuation Performance



FILTER SELECTION TABLE

	Rated current @40°C (25°C)	Leakage current @ 250VAC/50Hz (@ 120VAC/60Hz)	Inductance ΣL	Capacitance ΣCx	Capacitance ΣCy	Resistance ΣR	Connetion type		
	A	mA	mH	μF	nF	K_{Ω}			
AMI-27-1-X	1 (1.2)	0.73 (0.43)	44	0.66	9.4	1000	1	3	
AMI-27-3-X	3 (3.5)	0.73 (0.43)	19.6	0.94	9.4	470	1	3	
AMI-27-6-X	6 (6.9)	0.73 (0.43)	15.6	2	9.4	220	1	3	
AMI-27-10-X	10 (11.5)	0.73 (0.43)	9	2	9.4	220	1	3	
AMI-27-12-X	12 (13.8)	0.73 (0.43)	6.5	2	9.4	220	1	3	
AMI-27-16-X	16 (18.4)	0.73 (0.43)	5.6	2	9.4	220	1	3	6
AMI-27-25-X	25 (28.8)	0.73 (0.43)	4	4.4	9.4	220			6
AMI-27-36-X	36 (41.4)	0.73 (0.43)	2.46	4.4	9.4	220			6
AMI-27A-1-X	1 (1.2)	0.073 (0.04)	44	0.66	0.94	1000	1	3	
AMI-27A-3-X	3 (3.5)	0.073 (0.04)	19.6	0.94	0.94	470	1	3	
AMI-27A-6-X	6 (6.9)	0.073 (0.04)	15.6	2	0.94	220	1	3	
AMI-27A-10-X	10 (11.5)	0.073 (0.04)	9	2	0.94	220	1	3	
AMI-27A-12-X	12 (13.8)	0.073 (0.04)	6.5	2	0.94	220	1	3	
AMI-27A-16-X	16 (18.4)	0.073 (0.04)	5.6	2	0.94	220	1	3	6
AMI-27A-25-X	25 (28.8)	0.073 (0.04)	4	4.4	0.94	220			6
AMI-27A-36-X	36 (41.4)	0.073 (0.04)	2.46	4.4	0.94	220			6
AMI-27B-1-X	1 (1.2)	0.02 (0.01)	44	0.66	0.94	1000	1	3	
AMI-27B-3-X	3 (3.5)	0.02 (0.01)	19.6	0.94	0.94	470	1	3	
AMI-27B-6-X	6 (6.9)	0.02 (0.01)	15.6	2	0.94	220	1	3	
AMI-27B-10-X	10 (11.5)	0.02 (0.01)	9	2	0.94	220	1	3	
AMI-27B-12-X	12 (13.8)	0.02 (0.01)	6.5	2	0.94	220	1	3	
AMI-27B-16-X	16 (18.4)	0.02 (0.01)	5.6	2	0.94	220	1	3	6
AMI-27B-25-X	25 (28.8)	0.02 (0.01)	4	4.4	0.94	220			6
AMI-27B-36-X	36 (41.4)	0.02 (0.01)	2.46	4.4	0.94	220			6
Where X denotes connection style									

Insertion Loss: Common mode - —
Differential mode- —

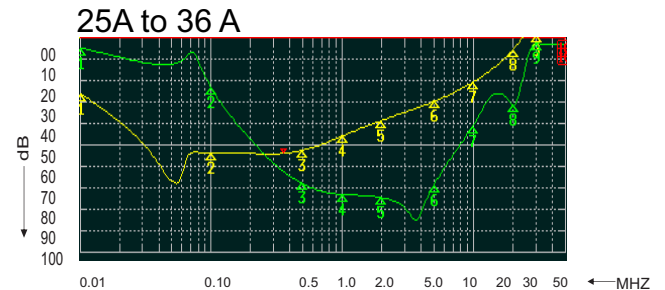
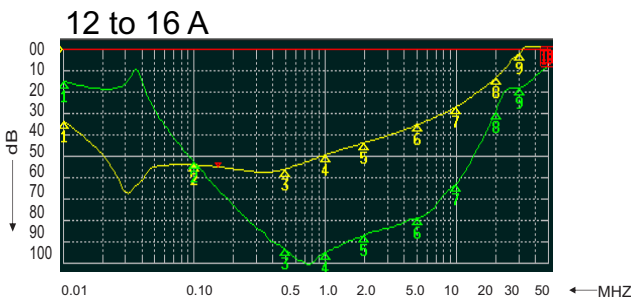
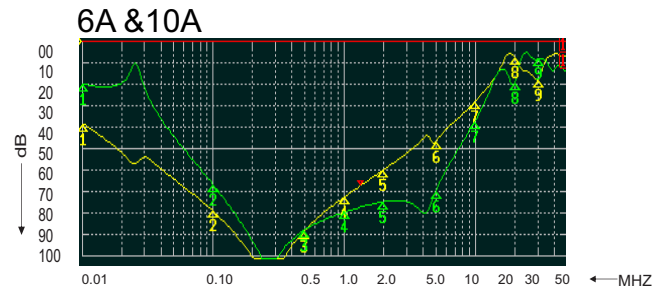
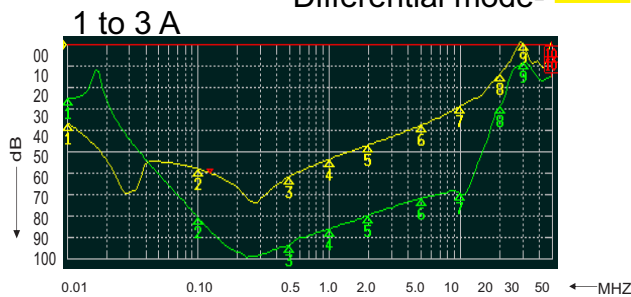

MECHANICAL DIMENSION (mm):

CONNECTION TYPE -1
1A

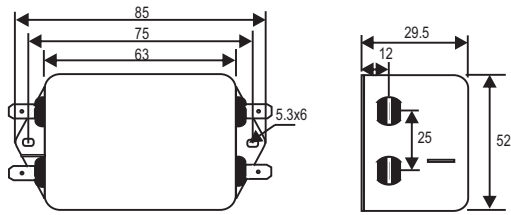

CONNECTION TYPE -1
3A

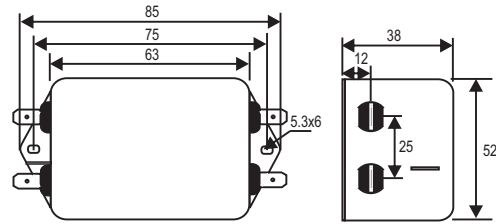

CONNECTION TYPE -1
6A

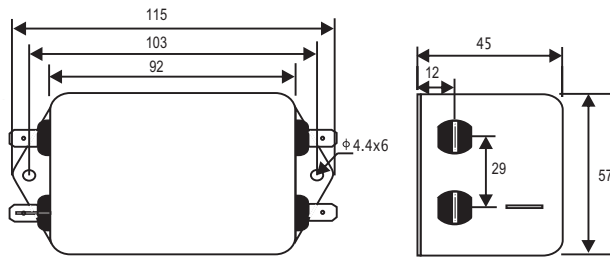

CONNECTION TYPE -1
10A & 12A

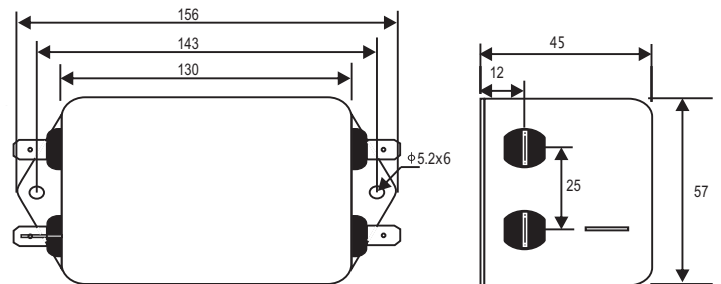

CONNECTION TYPE -1
16A

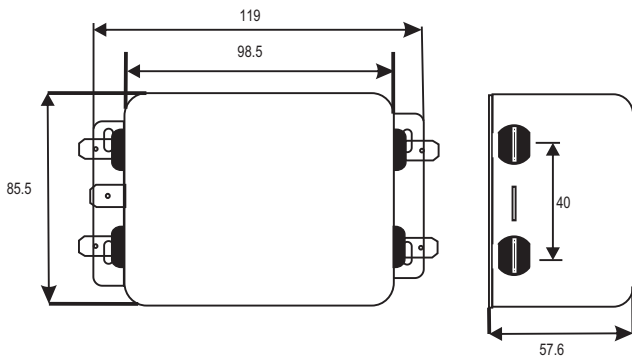

CONNECTION TYPE -3
16A

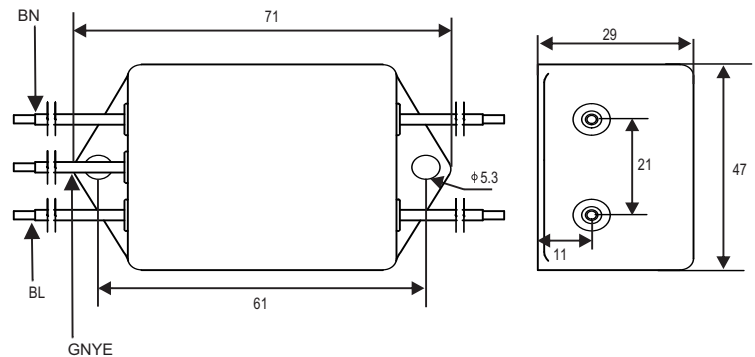

CONNECTION TYPE -6
16A

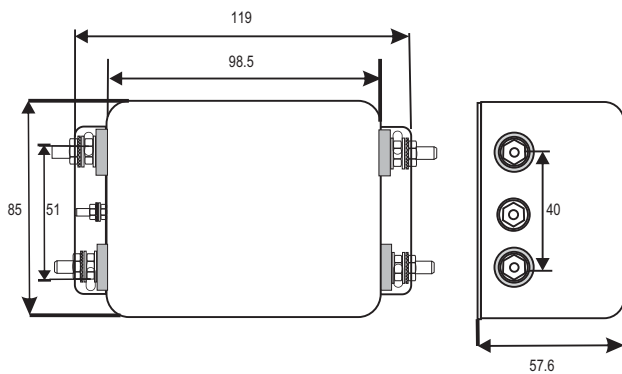

CONNECTION TYPE -6
25A & 36 A

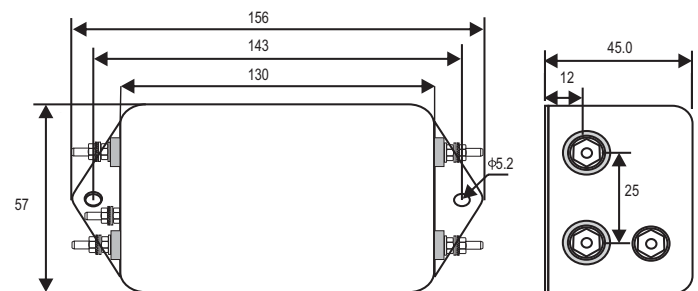

NOTE:

All Dimension in mm

- Connection type: 1 - Spade Terminals (6.3 x 0.8)
- 3 - Wire leads (140mm on both sides)
- 6 - Threaded Bolt Terminals (M4)