

AUXILIARY VIEWS  
SCALE 1:1

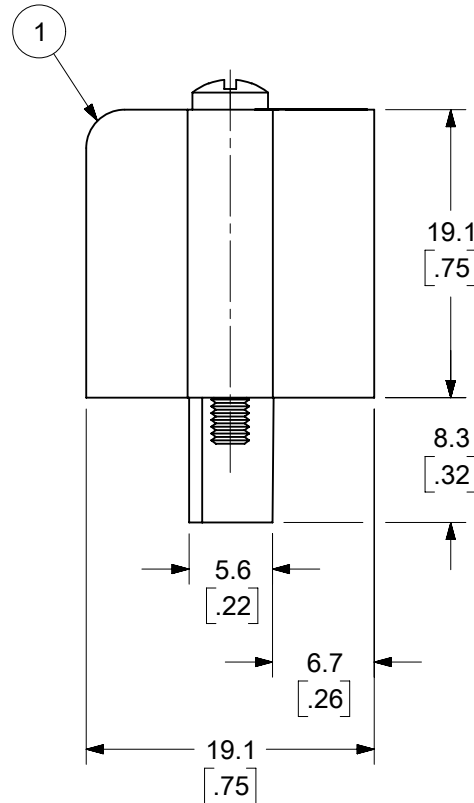

- NOTES:
1. MATERIAL: SEE TABLE
  2. FINISHES: SEE TABLE
  3. PRODUCT SPECIFICATION: NOT REQUIRED
  4. PACKAGING: NOT REQUIRED
  5. MATES WITH: MOST 5.08 (.200) PIN HEADERS
  6. "XX" REFERS TO THE QUANTITY OF CIRCUITS
  7. ROHS COMPLIANT

ODD CIRCUIT CONFIGURATION SHOWN

|      |                                   |                                  |                                |               |                |
|------|-----------------------------------|----------------------------------|--------------------------------|---------------|----------------|
| 8    | 2                                 | 2                                | SCREW, MOUNTING, M2.5 X .450   | STEEL         | ZINC CHROMATE  |
| 7    | XX                                | XX                               | SCREW, M3.5 X .280             | STEEL         | ZINC CHROMATE  |
| 6    | XX                                | XX                               | NUT, M3.5, HEX                 | STEEL         | ZINC CHROMATE  |
| 5    | XX/2                              | (XX-1)/2                         | REAR ROW TERMINAL (-G30 OPT.)  | PHOS. BRONZE  | SELECTIVE GOLD |
| 4    | XX/2                              | (XX+1)/2                         | FRONT ROW TERMINAL (-G30 OPT.) | PHOS. BRONZE  | SELECTIVE GOLD |
| 3    | XX/2                              | (XX-1)/2                         | REAR ROW TERMINAL              | PHOS. BRONZE  | HOT TIN DIP    |
| 2    | XX/2                              | (XX+1)/2                         | FRONT ROW TERMINAL             | PHOS. BRONZE  | HOT TIN DIP    |
| 1    | 1                                 | 1                                | BARRIER                        | THERMOPLASTIC | BLACK          |
| ITEM | QTY.<br>(EVEN NO. OF<br>CIRCUITS) | QTY.<br>(ODD NO. OF<br>CIRCUITS) | DESCRIPTION                    | MATERIAL      | FINISH         |

|  |  |       |  |  |  |   |  |                |  |                          |  |
|--|--|-------|--|--|--|---|--|----------------|--|--------------------------|--|
| FUNCTIONAL SYMBOLS                                   |  |       |  |  |  | THIS DRAWING CONTAINS INFORMATION THAT IS PROPRIETARY TO MOLEX ELECTRONIC TECHNOLOGIES, LLC AND SHOULD NOT BE USED WITHOUT WRITTEN PERMISSION |  |                |  |                          |  |
| DIMENSION UNITS                                      |  | SCALE |  | CURRENT REV DESC: REMOVED "US PATENT" TEXT FROM MODEL. |  |   |  |                |  |                          |  |
| MM/INCH  |  | 2:1   |  |  |  |   |  |                |  |                          |  |
| GENERAL TOLERANCES (UNLESS SPECIFIED)                |  |       |  |  |  | EC NO: 677615   |  |                |  |                          |  |
| 4 PLACES ± .05                                       |  | MM    |  | INCH   |  | DRWN: ABENJAMINLW   |  | 2021/08/18     |  | <b>SD-39940-002</b>      |  |
| 3 PLACES ± .005                                      |  |       |  |  |  | CHK'D: DACHAMMER  |  | 2021/09/09     |  |                          |  |
| 2 PLACES ± 0.13                                      |  |       |  |  |  | APPR: JFMURPHY  |  | 2022/01/04     |  | PRODUCT CUSTOMER DRAWING |  |
| 1 PLACE ± 0.3  |  |       |  |  |  | INITIAL REVISION:   |  |                |  | DOCUMENT NUMBER          |  |
| 0 PLACES ± .01                                       |  |       |  |  |  | DRWN: CYORK   |  | 2004/03/18     |  | SD-39940-002             |  |
| ANGULAR TOL ± 2°                                     |  |       |  |  |  | APPR: grobertson  |  | 2004/03/19     |  | PSD 001 F                |  |
| DRAFT WHERE APPLICABLE MUST REMAIN WITHIN DIMENSIONS |  |       |  |  |  | THIRD ANGLE PROJECTION  |  | DRAWING        |  | SERIES                   |  |
|  |  |       |  |  |  | B-SIZE  |  | 39940          |  | MATERIAL NUMBER          |  |
|  |  |       |  |  |  |   |  | SEE SHEET-2    |  | CUSTOMER                 |  |
|  |  |       |  |  |  |   |  | GENERAL MARKET |  | SHEET NUMBER             |  |
|  |  |       |  |  |  |   |  | 1 OF 2         |  |                          |  |

| NO. OF CIRC. "XX" | "A" $\begin{matrix} +0.3 \\ -0.5 \end{matrix}$ $\begin{bmatrix} +.01 \\ -.02 \end{bmatrix}$ |        | "B"    |         | "C" REF. |         | "D" $\begin{matrix} +.00 \\ -.25 \end{matrix}$ $\begin{bmatrix} +.000 \\ -.010 \end{bmatrix}$ |        | MATERIAL NO. (STANDARD) | MATERIAL NO. (-G30 OPT.) | MATERIAL NO. (-10A OPT.) |
|-------------------|---|--------|--------|---------|----------|---------|---|--------|-------------------------|--------------------------|--------------------------|
|                   | MM  | IN     | MM     | IN      | MM       | IN      | MM  | IN     |                         |                          |                          |
| 03                | 25.9  | [1.02] | 10.16  | [.400]  | 20.32    | [.800]  | 15.2  | [.60]  | 399400403               |                          |                          |
| 04                | 31.0  | [1.22] | 15.24  | [.600]  | 25.40    | [1.000] | 20.3  | [.80]  | 399400404               | 399410404                |                          |
| 05                | 36.1  | [1.42] | 20.32  | [.800]  | 30.48    | [1.200] | 25.4  | [1.00] | 399400405               |                          |                          |
| 06                | 41.1  | [1.62] | 25.40  | [1.000] | 35.56    | [1.400] | 30.5  | [1.20] | 399400406               |                          |                          |
| 07                | 46.2  | [1.82] | 30.48  | [1.200] | 40.64    | [1.600] | 35.6  | [1.40] | 399400407               |                          |                          |
| 08                | 51.3  | [2.02] | 35.56  | [1.400] | 45.72    | [1.800] | 40.6  | [1.60] | 399400408               |                          |                          |
| 09                | 56.4  | [2.22] | 40.64  | [1.600] | 50.80    | [2.000] | 45.7  | [1.80] | 399400409               |                          |                          |
| 10                | 61.5  | [2.42] | 45.72  | [1.800] | 55.88    | [2.200] | 50.8  | [2.00] | 399400410               | 399410410                |                          |
| 11                | 66.5  | [2.62] | 50.80  | [2.000] | 60.96    | [2.400] | 55.9  | [2.20] | 399400411               |                          |                          |
| 12                | 71.6  | [2.82] | 55.88  | [2.200] | 66.04    | [2.600] | 61.0  | [2.40] | 399400412               | 399410412                |                          |
| 13                | 76.7  | [3.02] | 60.96  | [2.400] | 71.12    | [2.800] | 66.0  | [2.60] | 399400413               |                          |                          |
| 14                | 81.8  | [3.22] | 66.04  | [2.600] | 76.20    | [3.000] | 71.1  | [2.80] | 399400414               |                          | 399490014                |
| 15                | 86.9  | [3.42] | 71.12  | [2.800] | 81.28    | [3.200] | 76.2  | [3.00] | 399400415               |                          |                          |
| 16                | 91.9  | [3.62] | 76.20  | [3.000] | 86.36    | [3.400] | 81.3  | [3.20] | 399400416               | 399410416                |                          |
| 17                | 97.0  | [3.82] | 81.28  | [3.200] | 91.44    | [3.600] | 86.4  | [3.40] | 399400417               |                          |                          |
| 18                | 102.1   | [4.02] | 86.36  | [3.400] | 96.52    | [3.800] | 91.4  | [3.60] | 399400418               |                          |                          |
| 19                | 107.2   | [4.22] | 91.44  | [3.600] | 101.60   | [4.000] | 96.5  | [3.80] | 399400419               | 399410419                |                          |
| 20                | 112.3   | [4.42] | 96.52  | [3.800] | 106.68   | [4.200] | 101.6   | [4.00] | 399400420               | 399410420                |                          |
| 21                | 117.3   | [4.62] | 101.60 | [4.000] | 111.76   | [4.400] | 106.7   | [4.20] | 399400421               |                          |                          |
| 22                | 122.4   | [4.82] | 106.68 | [4.200] | 116.84   | [4.600] | 111.8   | [4.40] | 399400422               | 399410422                |                          |
| 23                | 127.5   | [5.02] | 111.76 | [4.400] | 121.92   | [4.800] | 116.8   | [4.60] | 399400423               | 399410423                |                          |
| 24                | 132.6   | [5.22] | 116.84 | [4.600] | 127.00   | [5.000] | 121.9   | [4.80] | 399400424               |                          |                          |

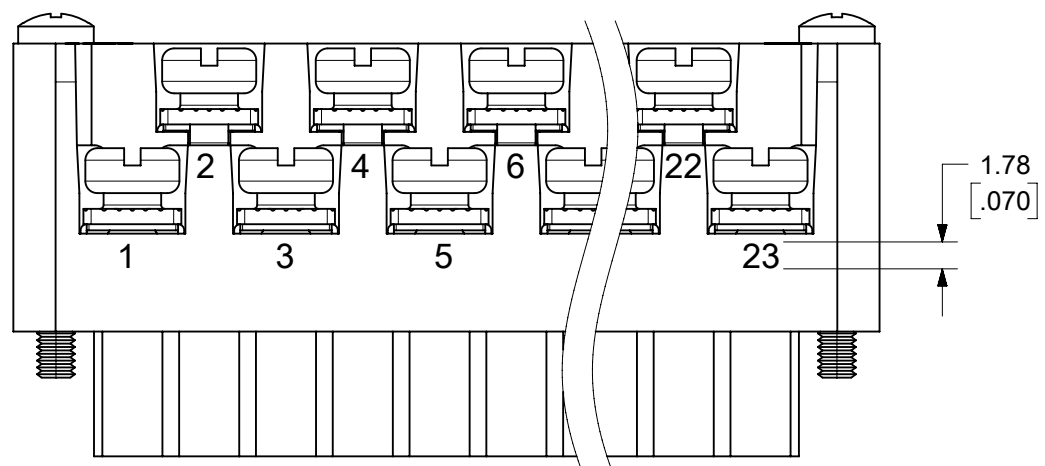

**OPTIONAL  
10A IMPRINTING**  
(ODD CIRCUIT CONFIGURATION SHOWN)

|   |  |  |  |                        |  |  |  |                |  |                 |  |
|---|--|--|--|------------------------|--|--|--|----------------|--|-----------------|--|
| THIS DRAWING CONTAINS INFORMATION THAT IS PROPRIETARY TO MOLEX ELECTRONIC TECHNOLOGIES, LLC AND SHOULD NOT BE USED WITHOUT WRITTEN PERMISSION |  |  |  |                        |  |  |  |                |  |                 |  |
| FUNCTIONAL SYMBOLS  |  | DIMENSION UNITS                                      |  | SCALE                  |  | CURRENT REV DESC: REMOVED "US PATENT" TEXT FROM MODEL.                       |  |                |  |                 |  |
| $\nabla_A = 0$  |  | MM/INCH  |  | 2:1                    |  | <b>molex</b><br>5.08/.200 PLUG ASSY, RWE<br>WITH STD. MOUNTING ENDS (9468XX) |  |                |  |                 |  |
| $\nabla_E = 0$  |  | GENERAL TOLERANCES (UNLESS SPECIFIED)                |  |                        |  |  |  |                |  |                 |  |
| $\nabla_F = 0$  |  | MM   |  | INCH                   |  |  |  |                |  |                 |  |
| DIVISIONAL SYMBOLS  |  | 4 PLACES ± --- ± ---                                 |  | 3 PLACES ± --- ± .005  |  |  |  |                |  |                 |  |
|   |  | 2 PLACES ± 0.13 ± .01                                |  | 1 PLACE ± 0.3 ± ---    |  | EC NO: 677615  |  | 2021/08/18     |  | 2021/09/09      |  |
|   |  | 0 PLACES ± --- ± ---                                 |  | ANGULAR TOL ± 2°       |  | DRWN: ABENJAMINLW  |  | 2022/01/04     |  | 2022/01/04      |  |
|   |  | DRAFT WHERE APPLICABLE MUST REMAIN WITHIN DIMENSIONS |  | THIRD ANGLE PROJECTION |  | DRAWING  |  | SERIES         |  | DOCUMENT NUMBER |  |
|   |  |  |  | B-SIZE                 |  | 39940  |  | SD-39940-002   |  | PSD 001 F       |  |
|   |  |  |  |                        |  | MATERIAL NUMBER  |  | CUSTOMER       |  | SHEET NUMBER    |  |
|   |  |  |  |                        |  | SEE CHART  |  | GENERAL MARKET |  | 2 OF 2          |  |

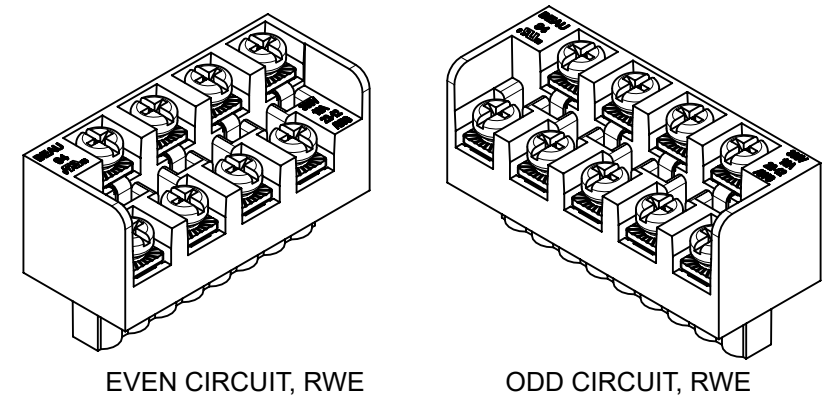
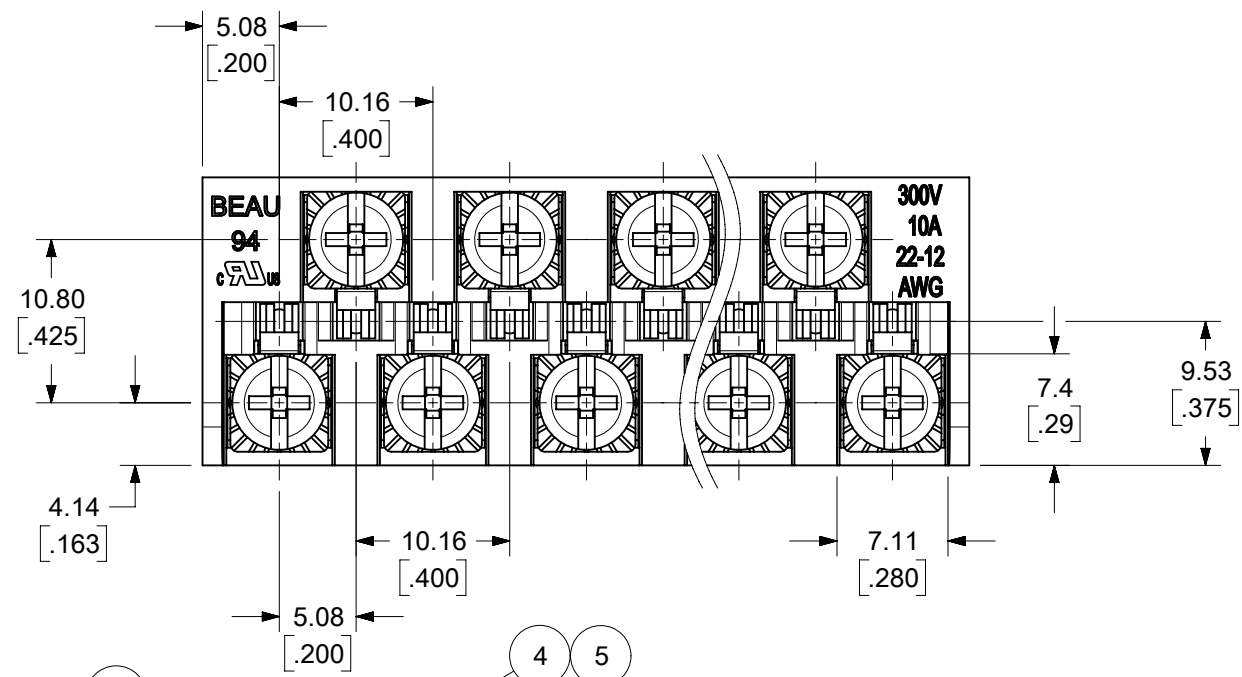

AUXILIARY VIEWS  
SCALE 1:1

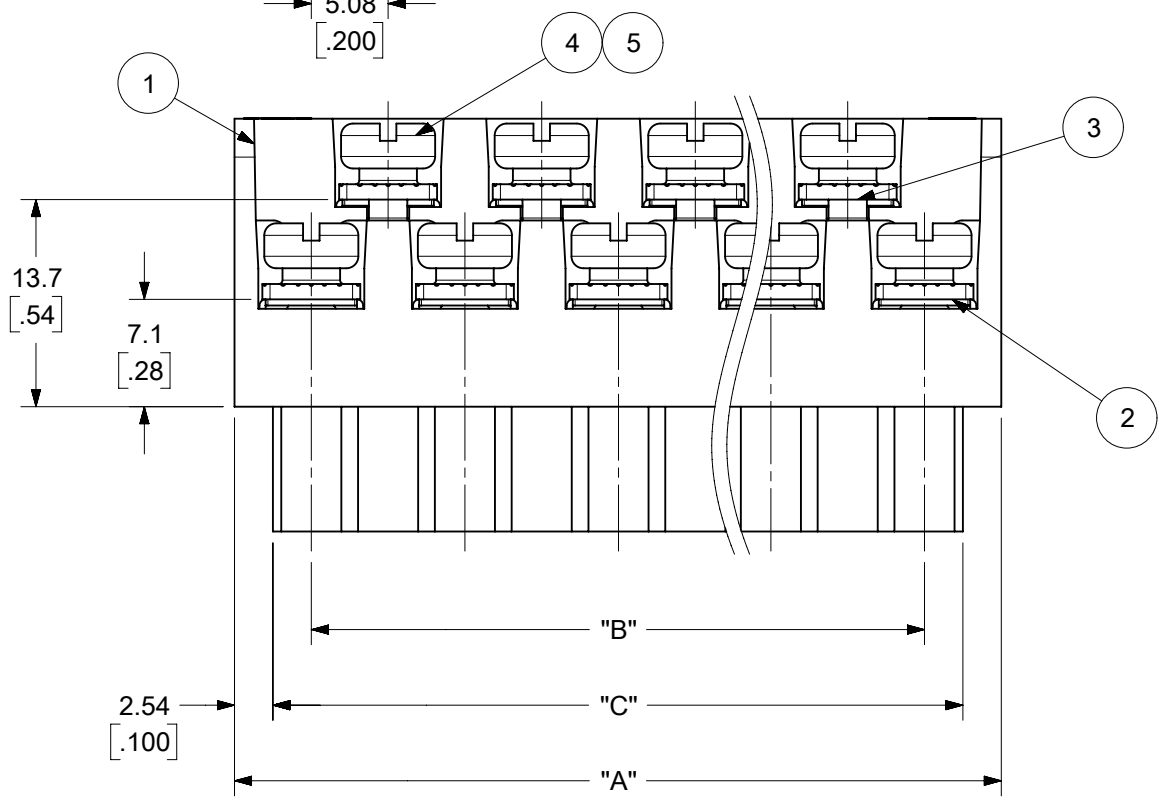

ODD CIRCUIT CONFIGURATION SHOWN

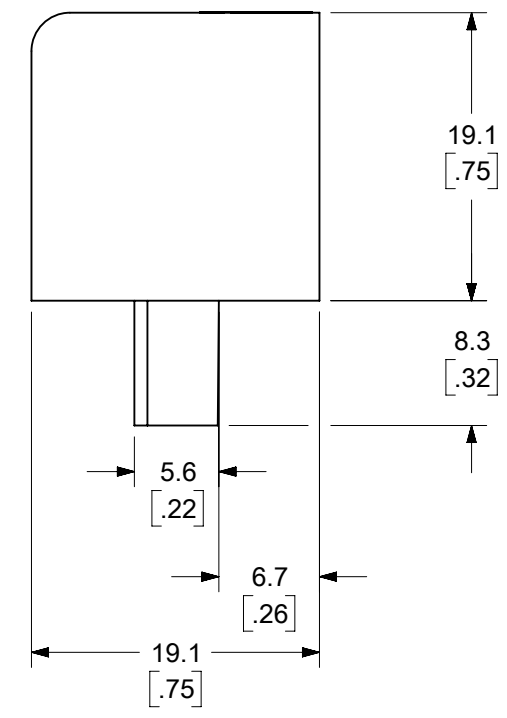

- NOTES:
1. MATERIAL: SEE TABLE
  2. FINISHES: SEE TABLE
  3. PRODUCT SPECIFICATION: NOT REQUIRED
  4. PACKAGING: NOT REQUIRED
  5. MATES WITH: MOST 5.08 [.200] PIN HEADERS
  6. "XX" REFERS TO THE QUANTITY OF CIRCUITS
  7. ROHS COMPLIANT

|      |                                   |                                  |                         |               |                 |
|------|-----------------------------------|----------------------------------|-------------------------|---------------|-----------------|
| 5    | XX                                | XX                               | SCREW, M3.5 X .280      | STEEL         | ZINC CHROMATE   |
| 4    | XX                                | XX                               | NUT, M3.5, HEX          | STEEL         | ZINC CHROMATE   |
| 3    | XX/2                              | (XX-1)/2                         | REAR ROW TERM. (LONG)   | PHOS. BRONZE  | HOT TIN DIP     |
| 2    | XX/2                              | (XX+1)/2                         | FRONT ROW TERM. (SHORT) | PHOS. BRONZE  | HOT TIN DIP     |
| 1    | 1                                 | 1                                | BARRIER                 | THERMOPLASTIC | BLACK           |
| ITEM | QTY.<br>(EVEN NO. OF<br>CIRCUITS) | QTY.<br>(ODD NO. OF<br>CIRCUITS) | DESCRIPTION             | MATERIAL NO.  | ENGINEERING NO. |

THIS DRAWING CONTAINS INFORMATION THAT IS PROPRIETARY TO MOLEX ELECTRONIC TECHNOLOGIES, LLC AND SHOULD NOT BE USED WITHOUT WRITTEN PERMISSION

|                    |  |                        |  |            |  |
|--------------------|--|------------------------|--|------------|--|
| FUNCTIONAL SYMBOLS | DIMENSION UNITS                                      | SCALE                  | CURRENT REV DESC: MIGRATED TO ECTR/NX. REMOVED "US PATENT" TEXT FROM MODEL   |            |  |
| $\frac{E}{A} = 0$  | MM/INCH  | 2:1                    | <p><b>molex</b></p> <p>5.08/.200 PLUG ASSY, RWE WITH CLOSED ENDS (9408XX)</p> <p>PRODUCT CUSTOMER DRAWING</p> <p>DOCUMENT NUMBER: SD-39940-004   DOC TYPE: PSD   DOC PART: 001   REVISION: F</p> <p>MATERIAL NUMBER: SEE SHEET-2   CUSTOMER: GENERAL MARKET   SHEET NUMBER: 1 OF 2</p> |            |  |
| $\frac{E}{E} = 0$  | GENERAL TOLERANCES (UNLESS SPECIFIED)                |                        |  |            |  |
| $\frac{E}{E} = 0$  | MM   | INCH                   |  |            |  |
| DIVISIONAL SYMBOLS | 4 PLACES   | ± .005                 |  |            |  |
|                    | 3 PLACES   | ± .01                  |  |            |  |
|                    | 2 PLACES   | ± 0.13 ± .01           | EC NO: 677615  | 2021/08/18 |  |
|                    | 1 PLACE  | ± 0.3 ± .01            | DRWN: ABENJAMINLW  | 2021/09/09 |  |
|                    | 0 PLACES   | ± .005                 | CHK'D: DACHAMMER   | 2022/01/04 |  |
|                    | ANGULAR TOL  | ± 2°                   | APPR: JFMURPHY   |            |  |
|                    |  |                        | INITIAL REVISION:  |            |  |
|                    |  |                        | DRWN: JAFARMER   | 2004/07/28 |  |
|                    |  |                        | APPR: grobertson   | 2004/12/08 |  |
|                    | DRAFT WHERE APPLICABLE MUST REMAIN WITHIN DIMENSIONS | THIRD ANGLE PROJECTION | DRAWING  | SERIES     |  |
|                    |  |                        | B-SIZE   | 39940      |  |

| NO. OF CIRC. "XX" | DIM. "A" |        | DIM. "B" |         | "C" $\begin{matrix} +.00 \\ -.25 \end{matrix}$ $\begin{bmatrix} +.000 \\ -.010 \end{bmatrix}$ |        | MATERIAL NO. (STANDARD) | MATERIAL NO. (-G30 OPT.) |
|-------------------|----------|--------|----------|---------|---|--------|-------------------------|--------------------------|
|                   | MM       | IN     | MM       | IN      | MM  | IN     |                         |                          |
| 03                | 20.3     | [.80]  | 10.16    | [.400]  | 15.2  | [.60]  | 399400203               |                          |
| 04                | 25.4     | [1.00] | 15.24    | [.600]  | 20.3  | [.80]  | 399400204               | 399410204                |
| 05                | 30.5     | [1.20] | 20.32    | [.800]  | 25.4  | [1.00] | 399400205               |                          |
| 06                | 35.6     | [1.40] | 25.40    | [1.000] | 30.5  | [1.20] | 399400206               |                          |
| 07                | 40.6     | [1.60] | 30.48    | [1.200] | 35.6  | [1.40] | 399400207               |                          |
| 08                | 45.7     | [1.80] | 35.56    | [1.400] | 40.6  | [1.60] | 399400208               |                          |
| 09                | 50.8     | [2.00] | 40.64    | [1.600] | 45.7  | [1.80] | 399400209               |                          |
| 10                | 55.9     | [2.20] | 45.72    | [1.800] | 50.8  | [2.00] | 399400210               |                          |
| 11                | 61.0     | [2.40] | 50.80    | [2.000] | 55.9  | [2.20] | 399400211               |                          |
| 12                | 66.0     | [2.60] | 55.88    | [2.200] | 61.0  | [2.40] | 399400212               |                          |
| 13                | 71.1     | [2.80] | 60.96    | [2.400] | 66.0  | [2.60] | 399400213               |                          |
| 14                | 76.2     | [3.00] | 66.04    | [2.600] | 71.1  | [2.80] | 399400214               |                          |
| 15                | 81.3     | [3.20] | 71.12    | [2.800] | 76.2  | [3.00] | 399400215               |                          |
| 16                | 86.4     | [3.40] | 76.20    | [3.000] | 81.3  | [3.20] | 399400216               |                          |
| 17                | 91.4     | [3.60] | 81.28    | [3.200] | 86.4  | [3.40] | 399400217               |                          |
| 18                | 96.5     | [3.80] | 86.36    | [3.400] | 91.4  | [3.60] | 399400218               |                          |
| 19                | 101.6    | [4.00] | 91.44    | [3.600] | 96.5  | [3.80] | 399400219               | 399410219                |
| 20                | 106.7    | [4.20] | 96.52    | [3.800] | 101.6   | [4.00] | 399400220               |                          |
| 21                | 111.8    | [4.40] | 101.60   | [4.000] | 106.7   | [4.20] | 399400221               |                          |
| 22                | 116.8    | [4.60] | 106.68   | [4.200] | 111.8   | [4.40] | 399400222               |                          |
| 23                | 121.9    | [4.80] | 111.76   | [4.400] | 116.8   | [4.60] | 399400223               |                          |
| 24                | 127.0    | [5.00] | 116.84   | [4.600] | 121.9   | [4.80] | 399400224               |                          |

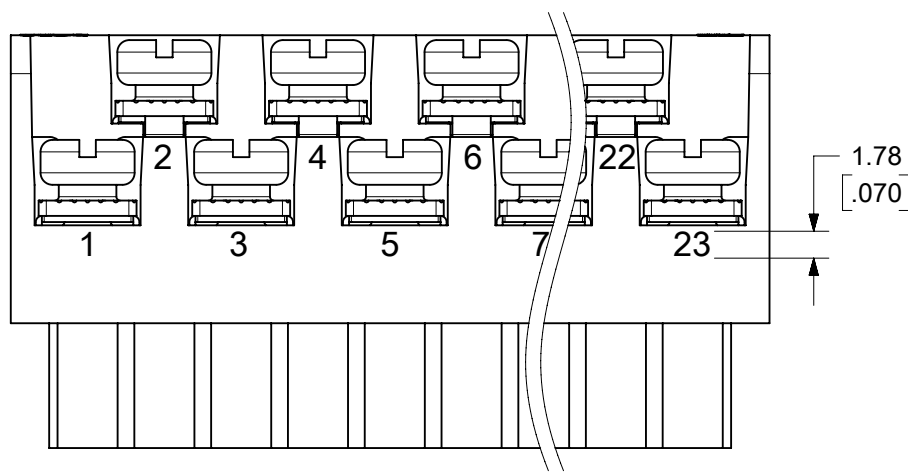

**OPTIONAL  
10A IMPRINTING**  
(ODD CIRCUIT CONFIGURATION SHOWN)

|   |  |                        |  |        |                 |                   |              |            |                          |
|---|--|------------------------|--|--------|-----------------|-------------------|--------------|------------|--------------------------|
| THIS DRAWING CONTAINS INFORMATION THAT IS PROPRIETARY TO MOLEX ELECTRONIC TECHNOLOGIES, LLC AND SHOULD NOT BE USED WITHOUT WRITTEN PERMISSION |  |                        |  |        |                 |                   |              |            |                          |
| FUNCTIONAL SYMBOLS  | DIMENSION UNITS                                      | SCALE                  | CURRENT REV DESC: MIGRATED TO ECTR/NX. REMOVED "US PATENT" TEXT FROM MODEL |        |                 |                   |              |            |                          |
| $\nabla_A = 0$  | MM/INCH  | 2:1                    | <b>molex</b><br>5.08/.200 PLUG ASSY, RWE WITH CLOSED ENDS (9408XX)         |        |                 |                   |              |            |                          |
| $\nabla_E = 0$  | GENERAL TOLERANCES (UNLESS SPECIFIED)                |                        |  |        |                 |                   |              |            |                          |
| $\nabla_V = 0$  |  |                        | MM   | INCH   | EC NO: 677615   |                   |              |            |                          |
|   | 4 PLACES   | ±                      | ---  | ±      | ---             | DRWN: ABENJAMINLW |              | 2021/08/18 | PRODUCT CUSTOMER DRAWING |
|   | 3 PLACES   | ±                      | ---  | ±      | .005            | CHK'D: DACHAMMER  |              | 2021/09/09 |                          |
| DIVISIONAL SYMBOLS  | 2 PLACES   | ±                      | 0.13   | ±      | .01             | APPR: JFMURPHY    |              | 2022/01/04 | DOCUMENT NUMBER          |
|   | 1 PLACE  | ±                      | 0.3  | ±      | ---             | INITIAL REVISION: |              | 2004/07/28 | SD-39940-004             |
|   | 0 PLACES   | ±                      | ---  | ±      | ---             | DRWN: JAFARMER    |              | 2004/12/08 | PSD 001 F                |
|   | ANGULAR TOL  | ±                      | 2°   |        |                 | APPR: grobertson  |              |            | REVISION                 |
|   | DRAFT WHERE APPLICABLE MUST REMAIN WITHIN DIMENSIONS | THIRD ANGLE PROJECTION | DRAWING  | SERIES | MATERIAL NUMBER | CUSTOMER          | SHEET NUMBER |            |                          |
|   |  |                        | B-SIZE   | 39940  | SEE CHART       | GENERAL MARKET    | 2 OF 2       |            |                          |

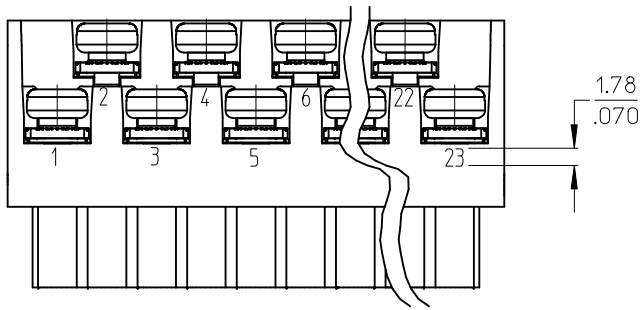

OPTIONAL  
10A IMPRINTING  
(ODD CIRCUIT CONFIGURATION SHOWN)

| NO. OF CIRC. "XX" | "A" DIM.     | "B" DIM.       | "C" <sup>+0.00</sup> <sub>-0.25</sub> [ <sup>+0.000</sup> <sub>-0.010</sub> ] | MATERIAL NO. (STANDARD) | MATERIAL NO. (G30 OPT) |
|-------------------|--------------|----------------|---|-------------------------|------------------------|
| 03                | 20.3 [.80]   | 10.16 [.400]   | 15.2 [.60]  | 399400203               |                        |
| 04                | 25.4 [1.00]  | 15.24 [.600]   | 20.3 [.80]  | 399400204               | 399410204              |
| 05                | 30.5 [1.20]  | 20.32 [.800]   | 25.4 [1.00]   | 399400205               |                        |
| 06                | 35.6 [1.40]  | 25.40 [1.000]  | 30.5 [1.20]   | 399400206               |                        |
| 07                | 40.6 [1.60]  | 30.48 [1.200]  | 35.6 [1.40]   | 399400207               |                        |
| 08                | 45.7 [1.80]  | 35.56 [1.400]  | 40.6 [1.60]   | 399400208               |                        |
| 09                | 50.8 [2.00]  | 40.64 [1.600]  | 45.7 [1.80]   | 399400209               |                        |
| 10                | 55.9 [2.20]  | 45.72 [1.800]  | 50.8 [2.00]   | 399400210               |                        |
| 11                | 61.0 [2.40]  | 50.80 [2.000]  | 55.9 [2.20]   | 399400211               |                        |
| 12                | 66.0 [2.60]  | 55.88 [2.200]  | 61.0 [2.40]   | 399400212               |                        |
| 13                | 71.1 [2.80]  | 60.96 [2.400]  | 66.0 [2.60]   | 399400213               |                        |
| 14                | 76.2 [3.00]  | 66.04 [2.600]  | 71.1 [2.80]   | 399400214               |                        |
| 15                | 81.3 [3.20]  | 71.12 [2.800]  | 76.2 [3.00]   | 399400215               |                        |
| 16                | 86.4 [3.40]  | 76.20 [3.000]  | 81.3 [3.20]   | 399400216               |                        |
| 17                | 91.4 [3.60]  | 81.28 [3.200]  | 86.4 [3.40]   | 399400217               |                        |
| 18                | 96.5 [3.80]  | 86.36 [3.400]  | 91.4 [3.60]   | 399400218               |                        |
| 19                | 101.6 [4.00] | 91.44 [3.600]  | 96.5 [3.80]   | 399400219               | 399410219              |
| 20                | 106.7 [4.20] | 96.52 [3.800]  | 101.6 [4.00]  | 399400220               |                        |
| 21                | 111.8 [4.40] | 101.60 [4.000] | 106.7 [4.20]  | 399400221               |                        |
| 22                | 116.9 [4.60] | 106.68 [4.200] | 111.8 [4.40]  | 399400222               |                        |
| 23                | 121.9 [4.80] | 111.76 [4.400] | 116.8 [4.60]  | 399400223               |                        |
| 24                | 127.0 [5.00] | 116.84 [4.600] | 121.9 [4.80]  | 399400224               |                        |

(E)

|   |                       |                                       |   |  |              |                        |
|---|-----------------------|---------------------------------------|---|--|--------------|------------------------|
| REV'D G30 P/NS<br>EC NO: IFC2015-0238<br>IT DRW:HRSTONE 2014/08/07<br>CHK: B. ARDEN 2014/08/08<br>APPR: B. WOODMAN 2014/10/07 | QUALITY SYMBOLS       | GENERAL TOLERANCES (UNLESS SPECIFIED) | DIMENSION STYLE   | SCALE  | DESIGN UNITS | THIRD ANGLE PROJECTION |
|   | ▼=0<br>▽=0            | mm INCH                               | MM/IN   | 2:1  | INCH         |                        |
|   |                       | 4 PLACES ± --- ± ---                  | DRAWN BY DATE   | TITLE  |              |                        |
|   |                       | 3 PLACES ± --- ± .005                 | J. FARMER 2004/12/06  | 5.08/.200 PLUG ASSY, RWE WITH CLOSED ENDS (9408XX) |              |                        |
|   | 2 PLACES ± 0.13 ± .01 | CHECKED BY DATE                       | MATERIAL NO.  |  |              |                        |
|   | 1 PLACE ± 0.3 ± ---   | R. KEMP 2004/12/06                    | SD-39940-004  |  |              |                        |
|   | ANGULAR ± 2 °         | APPROVED BY DATE                      | DOCUMENT NO.  |  |              |                        |
|   |                       | GHR 2004/12/06                        | SD-39940-004  |  |              |                        |
|   |                       |                                       | SHEET NO.   |  |              |                        |
|   |                       |                                       | 2 OF 2  |  |              |                        |
|   |                       |                                       | THIS DRAWING CONTAINS INFORMATION THAT IS PROPRIETARY TO MOLEX INCORPORATED AND SHOULD NOT BE USED WITHOUT WRITTEN PERMISSION |  |              |                        |